

ROUTE NO.	SECTION	QUANTITY	SHEET	TOTAL SHEETS
FAS 447	#	Fullon	43	34
FED. ROAD DIST. NO. 7	ILLINOIS	FED. AID PROJECT:		

*08-00121-01-BR

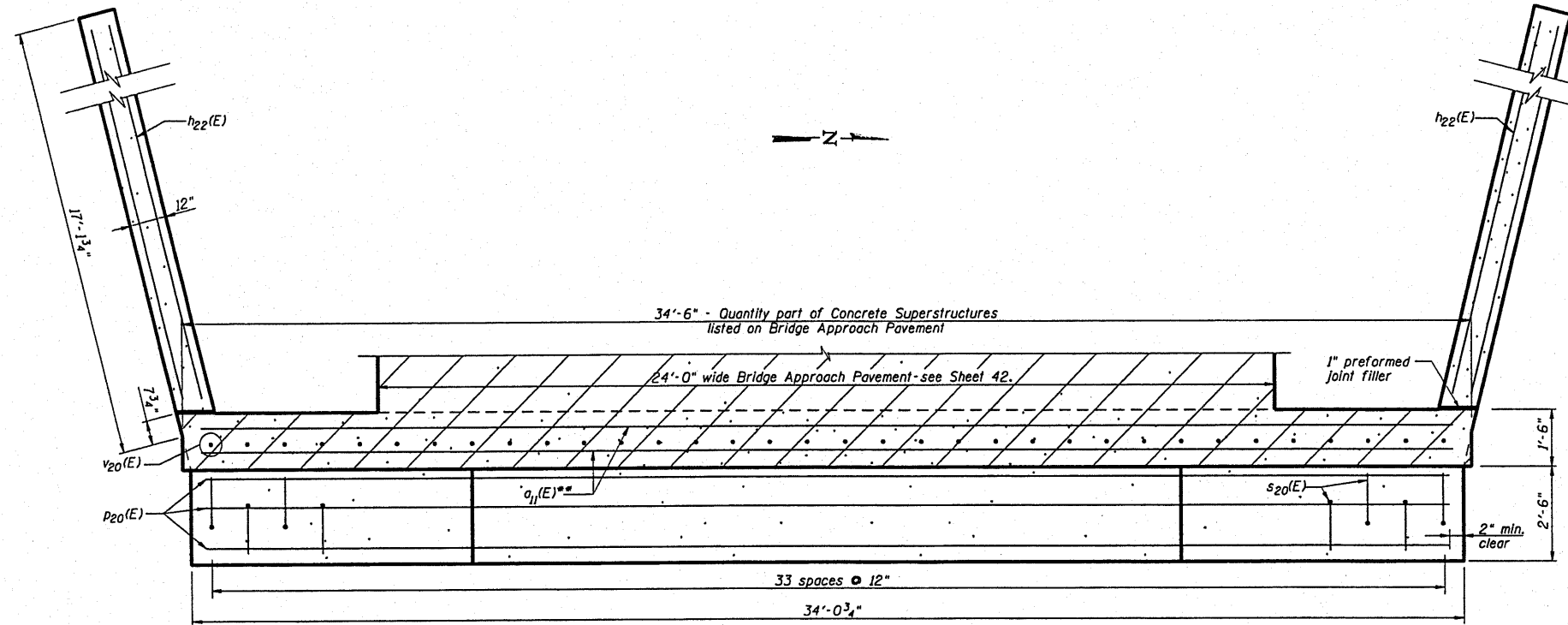

WEST ABUTMENT PLAN

For rehabilitation. Note, pile caps are not shown.

NOTES:

** See Bridge Approach Pavement, sheet 42 for #6 a11 (E) bars.

Maintain a 2" minimum clear cover unless otherwise noted.

Utilize all existing reinforcing unless otherwise directed by the Engineer. Cut existing reinforcement to maintain a 2" minimum clear cover.

Epoxy anchor v(E) and s(E) bars into existing concrete using a pre-drilled hole and Epcon 6 two-part ceramic epoxy or Hilli 2-part adhesive HIT-RE 500-SD. Cost of anchorage is included with the cost of Reinforcing Bars, Epoxy Coated.

* Compare the elevations of the bottoms of the bottom flanges of girder pairs 1 & 5, and 2 & 4. Select the lowest girder in each pair. Set the pedestal heights B_4 below the bottom of girder bottom flange of the ϕ of bearing.

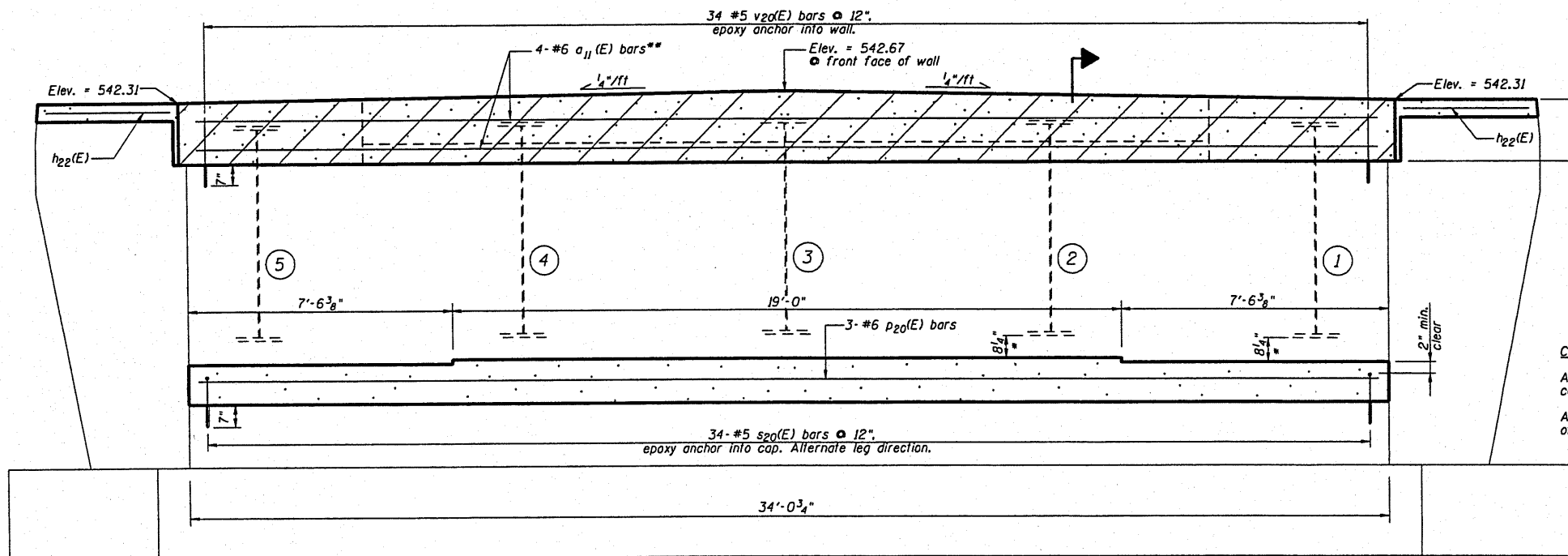

WEST ABUTMENT FRONT ELEVATION

For rehabilitation

Cast concrete after the deck has cured and forms are removed.

CONCRETE SEALER NOTE:

Apply concrete sealer to the vertical surfaces of the new concrete at the top of the backwall.
Apply concrete sealer to the horizontal and vertical surfaces of the new concrete of the bearing seats.

DSGN	K.J. Hoffmann				
DR	K.J. Hoffmann				
CHK	J.A. Fraunhofer				
APVD	J.A. Fraunhofer	NO.	DATE	REVISION	BY

FRAUENHOFER

Fraunhofer and Associates, P.C. Consulting Engineers
3002 Crossing Court Champaign, IL 61822 217-351-6268

WEST ABUTMENT REHABILITATION-SHEET 1 OF 2

FAS 447 (C.H. 17) OVER SPOON RIVER
SECTION 08-00121-01-BR
FULTON COUNTY

SHEET	34
DWG NO.	8015ABUT.dgn
DATE	JAN 2010
PROJ NO.	8015