

STATE OF ILLINOIS
DEPARTMENT OF TRANSPORTATION

F.A. RTE.	SECTION	COUNTY	TOTAL SHEETS	SHEET NO.
VAR.	D2SW2016-1	VAR.	116	1
FED. ROAD DIST. NO. 2		ILLINOIS	CONTRACT NO. 64L12	

PROPOSED
HIGHWAY PLANS

FOR INDEX OF SHEETS AND HIGHWAY STANDARDS, SEE SHEET NO. 2

VARIOUS ROUTES
SECTION D2 SW2016-1
PROJECT STP-4LP3(180)
ADA SIDEWALK IMPROVEMENTS
HENRY AND ROCK ISLAND COUNTIES

C-92-017-19

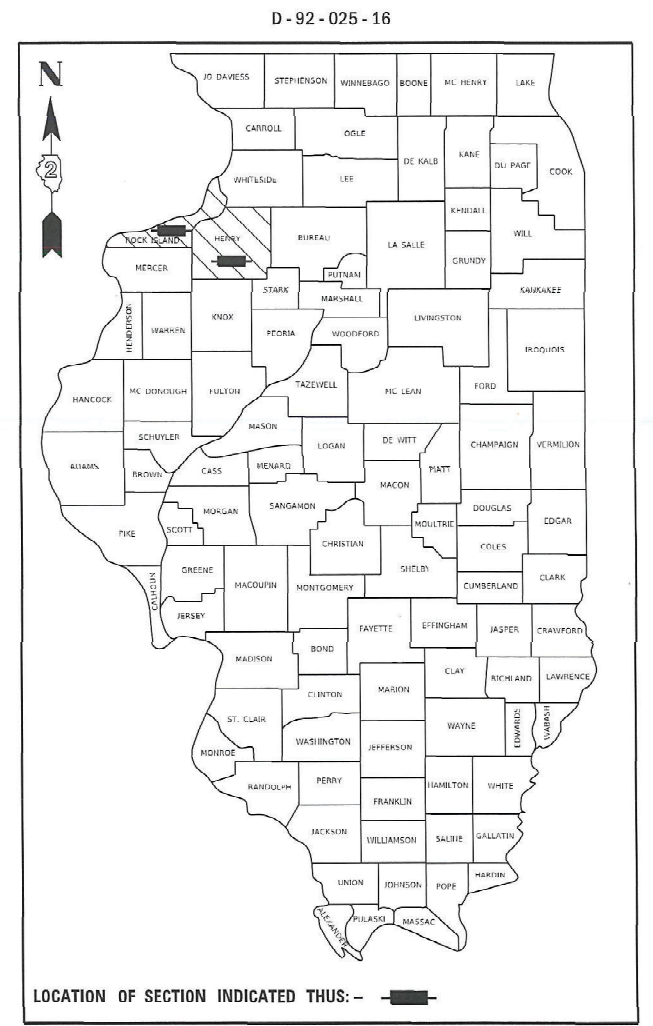

~~IL 192 AND 140TH ST W~~
~~EDGINGTON TOWNSHIP: SECTION 7, 8, 17, 18~~

IL 92 AND 1ST ST W
ANDALUSIA TOWNSHIP: SECTION 26, 27

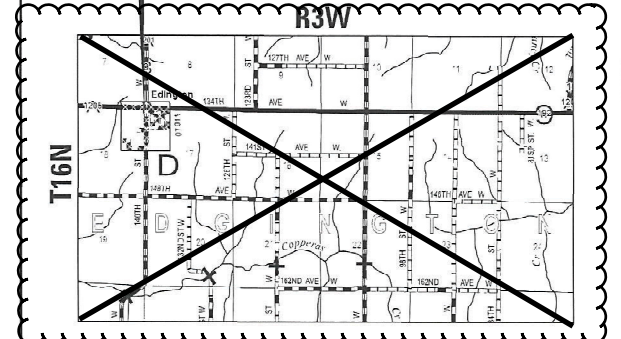
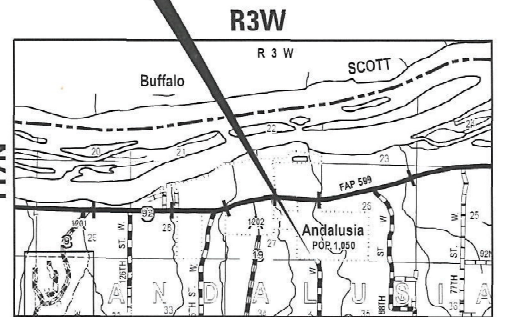

US 150 / W 3RD ST,
2ND ST CT, 1ST ST,
E 2ND ST AND E 3RD ST
COAL VALLEY TOWNSHIP:
SECTION 26, 35

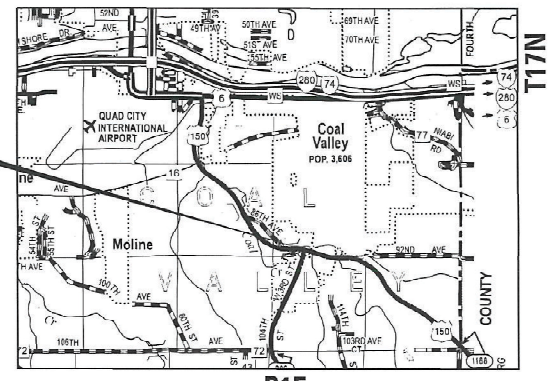

FAP 639 (US 150) / E ST,
D ST, C ST, B ST AND A ST
OXFORD TOWNSHIP: SECTION 21, 22

OSCO RD / NORTH ST,
N RAILROAD ST AND SOUTH ST
OSCO TOWNSHIP: SECTION 28, 29

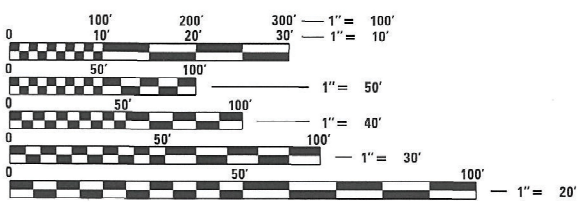
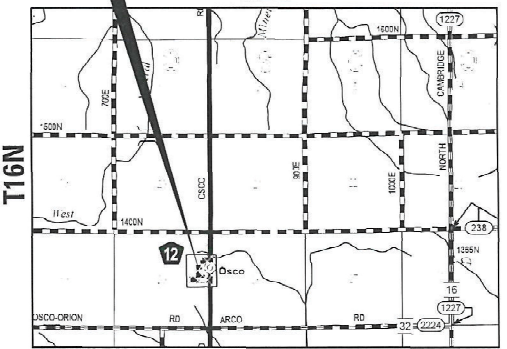

FULL SIZE PLANS HAVE BEEN PREPARED USING STANDARD
ENGINEERING SCALES. REDUCED SIZED PLANS WILL NOT
CONFORM TO STANDARD SCALES. IN MAKING MEASUREMENTS
ON REDUCED PLANS, THE ABOVE SCALES MAY BE USED.

J.U.L.I.E.
JOINT UTILITY LOCATION INFORMATION FOR EXCAVATORS
1-800-892-0123
OR 811

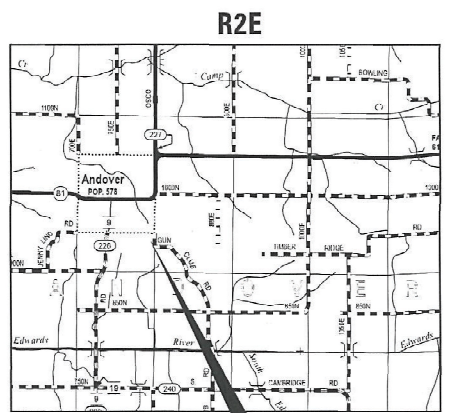
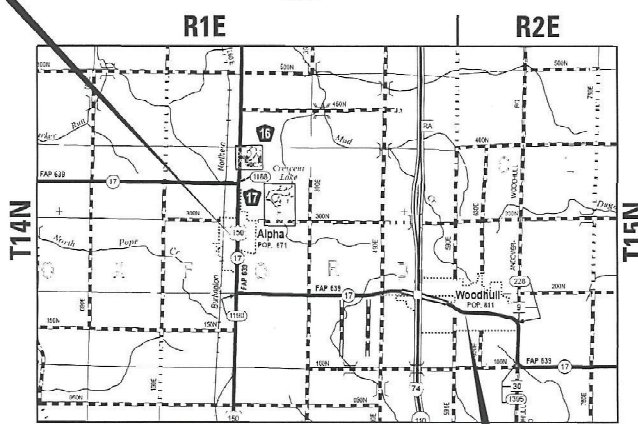

IL 81 / MULBERRY ST,
LOCUST ST AND ELM ST
ANDOVER TOWNSHIP: SECTION 8, 17

PROJECT ENGINEER: STEVE ROBERY, P.E.
PROJECT MANAGER: A.J. CUCCIO, (815) 284-5504

LOCATION MAPS
NOT TO SCALE

IL 17 / DIVISION ST AND E 3RD ST
OXFORD TOWNSHIP: SECTION 25
CLOVER TOWNSHIP: SECTION 30

STATE OF ILLINOIS
DEPARTMENT OF TRANSPORTATION

SUBMITTED August 06 20 21

[Signature]
REGIONAL ENGINEER

October 1 20 21
[Signature]
ENGINEER OF DESIGN AND ENVIRONMENT

October 21 21
[Signature]
DIRECTOR OF HIGHWAYS PROJECT IMPLEMENTATION

PRINTED BY THE AUTHORITY
OF THE STATE OF ILLINOIS

CONTRACT NO. 64L12

INDEX OF SHEETS

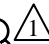
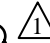
1 COVER SHEET
 2 INDEX OF SHEETS / HIGHWAY STANDARDS
 3 GENERAL NOTES
 4-10 SUMMARY OF QUANTITIES
 11-25 SCHEDULE OF QUANTITIES
 26-36 HORIZONTAL AND VERTICAL CONTROL
 37-41 RIGHT OF WAY AND REMOVAL SHEETS - COAL VALLEY
 42 ~~RIGHT OF WAY AND REMOVAL SHEETS - ANDALUSIA~~ 
 43 ~~RIGHT OF WAY AND REMOVAL SHEETS - EDGINGTON~~
 44-48 RIGHT OF WAY AND REMOVAL SHEETS - ALPHA
 49-50 RIGHT OF WAY AND REMOVAL SHEETS - WOODHULL
 51-53 RIGHT OF WAY AND REMOVAL SHEETS - ANDOVER
 54-56 RIGHT OF WAY AND REMOVAL SHEETS - OSCO
 57-70 SIDEWALK RAMP DETAILS - COAL VALLEY
 71-72 ~~SIDEWALK RAMP DETAILS - ANDALUSIA~~ 
 73-74 ~~SIDEWALK RAMP DETAILS - EDGINGTON~~
 75-91 SIDEWALK RAMP DETAILS - ALPHA
 92-96 SIDEWALK RAMP DETAILS - WOODHULL
 97-100 SIDEWALK RAMP DETAILS - ANDOVER
 101-103 SIDEWALK RAMP DETAILS - OSCO
 104-105 TRAFFIC SIGNAL MODIFICATION SCHEDULE (COAL VALLEY)
 106-107 TRAFFIC SIGNAL MODIFICATION PLANS (COAL VALLEY)
 108-109 RAMP ACCESS DETAIL - US 150 AND 1ST ST., SE QUADRANT (COAL VALLEY)
 110 SIDEWALK AND DRIVEWAY PAVEMENT PAY AREAS (35.4)
 110 CATCH BASIN OR INLETS TO BE ADJUSTED OR RECONSTRUCTED (17.4)
 110 STANDARD INLET FOR CURB AND GUTTER (21.2)
 111 PERMANENT SURVEY MARKERS, TYPE II (66.2)
 112 PC CONCRETE ISLAND AND MEDIANS ACCESSIBLE TO THE DISABLED (4.1)
 113 ENTRANCE APPROACHES - URBAN AREA (25.1)
 114-116 TYPICAL PAVEMENT MARKINGS (41.1)

HIGHWAY STANDARDS:

000001-08 STANDARDS SYMBOLS, ABBREVIATIONS AND PATTERNS
 001006 DECIMAL OF AN INCH AND OF A FOOT
 280001-07 TEMPORARY EROSION CONTROL SYSTEMS
 424001-11 PERPENDICULAR CURB RAMPS FOR SIDEWALKS
 424011-04 DIAGONAL CURB RAMPS FOR SIDEWALKS
 424006-05 CORNER PARALLEL CURB RAMPS FOR SIDEWALKS
 424016-05 MID-BLOCK CURB RAMPS FOR SIDEWALKS
 424021-06 DEPRESSED CORNER FOR SIDEWALKS
 424026-03 ENTRANCE / ALLEY PEDESTRIAN CROSSINGS
 424031-02 MEDIAN PEDESTRIAN CROSSINGS
 442201-03 CLASS C AND D PATCHES
 542411 SLOPED METAL END SECTIONS FOR PIPE CULVERTS 15"(375 mm) THRU 60 " (1500 mm) DIA.
 602301-04 INLET, TYPE A
 602306-03 INLET, TYPE B
 602402-03 PRECAST MANHOLE TYPE A 5' (1.52 m) DIAMETER
 602601-06 PRECAST REINFORCED CONCRETE FLAT SLAB TOP
 604006-05 FRAME AND GRATE, TYPE 3
 606001-07 CONCRETE CURB TYPE B AND COMBINATION CONCRETE CURB AND GUTTER
 606201-04 TYPE B GUTTER (INLET, OUTLET & ENTRANCE)
 606301-04 PC CONCRETE ISLANDS AND MEDIANS
 666001-01 RIGHT OF WAY MARKERS
 701006-05 OFF-ROAD OPERATIONS, 2L, 2W, 15' (4.5M) TO 24" (600MM) FROM PAVEMENT EDGE
 701301-04 LANE CLOSURE, 2L, 2W, SHORT TIME OPERATIONS
 701311-03 LANE CLOSURE, 2L, 2W, MOVING OPERATIONS - DAY ONLY
 701501-06 URBAN LANE CLOSURE, 2L, 2W, UNDIVIDED
 701701-10 URBAN LANE CLOSURE, MULTILANE INTERSECTION
 701801-06 SIDEWALK, CORNER, OR CROSSWALK CLOSURE
 701901-08 TRAFFIC CONTROL DEVICES
 720011-01 METAL POST FOR SIGNS, MARKERS AND DELINEATORS
 728001-01 TELESCOPING STEEL SIGN SUPPORT
 729001-01 APPLICATIONS OF TYPES A AND B METAL POSTS (FOR SIGNS AND MARKERS)
 780001-05 TYPICAL PAVEMENT MARKINGS
 814001-03 HANDHOLES
 857001-01 STANDARD DESIGNATION DIAGRAM AND PHASE SEQUENCE
 877001-08 STEEL MAST ARM ASSEMBLY AND POLE 16' THROUGH 55'
 877011-10 STEEL COMBINATION MAST ARM ASSEMBLY AND POLE
 878001-11 CONCRETE FOUNDATION DETAILS
 880006-01 TRAFFIC SIGNAL MOUNTING DETAILS

MODEL: Default
 FILE: \\blm1c:\pub\planroom\data\illinois.gov\PI\DOT\Documents\IDOT_Offices\District 2\Projects\ID2025\16_CAD\data\CAD\sheet\ID2025\16_AIC-int-index.dgn

USER NAME = cuccioaj	DESIGNED -	REVISED -
	DRAWN -	REVISED -
PLOT SCALE = 2,0000 ' / in.	CHECKED -	REVISED -
PLOT DATE = 8/10/2021	DATE -	REVISED -

**STATE OF ILLINOIS
 DEPARTMENT OF TRANSPORTATION**

**INDEX OF SHEETS AND
 STATE STANDARDS**

SCALE: SHEET 1 OF 1 SHEETS STA. TO STA.

F.A. RTE.	SECTION	COUNTY	TOTAL SHEETS	SHEET NO.
VAR.	D25W2016-1	VAR.	116	2
			CONTRACT NO. 64L12	
		ILLINOIS FED. AID PROJECT		

SUMMARY OF QUANTITIES

CONSTRUCTION CODE

STP FUNDS

80% FED / 20% STATE

80% FED/ 10% STATE/ 10% LOCAL

100% LOCAL

100% LOCAL

CODE NO.	ITEM	UNIT	TOTAL QUANTITY	80% FED / 20% STATE														
				ROADWAY		ROADWAY		ROADWAY		ROADWAY		ROADWAY		ROADWAY		SIGNALS		
				0021	0021	0021	0021	0021	0021	0021	0021	0021	0021	0021	0021	0021	0021	0021
				URBAN	URBAN	RURAL	URBAN	RURAL	RURAL	RURAL	RURAL	RURAL	RURAL	COAL VALLEY	COAL VALLEY	ALPHA		
20200100	EARTH EXCAVATION	CU YD	160	70	15	15	50	10	10	5								
20400800	FURNISHED EXCAVATION	CU YD	15						15									
20800150	TRENCH BACKFILL	CU YD	10		1		7	2										
21101615	TOPSOIL FURNISH AND PLACE, 4"	SQ YD	1,992	698	91	39	718	239	152	94								
25200110	SODDING, SALT TOLERANT	SQ YD	1,992	698	91	39	718	239	152	94								
25200200	SUPPLEMENTAL WATERING	UNIT	17.9	6.3	0.7	0.4	6.5	2.1	1.4	0.8								
28000250	TEMPORARY EROSION CONTROL SEEDING	POUND	131	46	9		46	14	10	6								
28000500	INLET AND PIPE PROTECTION	EACH	22	6		1	14	1	1									
28000510	INLET FILTERS	EACH	16				14	1	1									
35101400	AGGREGATE BASE COURSE, TYPE B	TON	100	30	10	10	30	10	10	10								
40600290	BITUMINOUS MATERIALS (TACK COAT)	POUND	311	66	13	18	110	51	52	19								
40600990	TEMPORARY RAMP	SQ YD	130	17	8	6	60	15	16	14								
40800050	INCIDENTAL HOT-MIX ASPHALT SURFACING	TON	151	27	19	7	45	21	31	8								
42300300	PORTLAND CEMENT CONCRETE DRIVEWAY PAVEMENT, 7 INCH	SQ YD	111	19			58	34										

* SPECIALTY ITEM

MODEL: Default
FILE NAME: P:\p1garcia\com.dct.illinois.gov\PWD\DOT\Documents\DOT - Offices\District 2\Project\02021516\CAD\data\CAD\sheet\02021516_AIC-sh-500_printer.dgn

USER NAME = cuccioaj	DESIGNED - AIC	REVISED -
	DRAWN -	REVISED -
PLOT SCALE = 100.0000' / in.	CHECKED -	REVISED -
PLOT DATE = 8/11/2021	DATE - 12/3/2019	REVISED -

STATE OF ILLINOIS
DEPARTMENT OF TRANSPORTATION

SUMMARY OF QUANTITIES

SCALE: SHEET 1 OF 7 SHEETS STA. TO STA.

F.A. * RTE.	SECTION	COUNTY	TOTAL SHEETS	SHEET NO.
VAR.	D2 SW2016-1	VAR.	116	4
			CONTRACT NO. 64L12	
ILLINOIS FED. AID PROJECT				

REV. 10/20/21 REV. 9/27/21

SUMMARY OF QUANTITIES

CONSTRUCTION CODE

STP FUNDS

80% FED / 20% STATE

80% FED/ 10% STATE / 10% LOCAL

100% LOCAL

100% LOCAL

CODE NO.	ITEM	UNIT	TOTAL QUANTITY	ROADWAY													
				COAL VALLEY		ANDALUSIA		EDGINGTON		ALPHA		WOODHULL		ANDOVER		OSCO	
				0021	0021	0021	0021	0021	0021	0021	0021	0021	0021	0021	0021	0021	0021
				URBAN	URBAN	RURAL	URBAN	RURAL	RURAL	RURAL	RURAL	RURAL	RURAL	URBAN	URBAN	URBAN	ALPHA
42400200	PORTLAND CEMENT CONCRETE SIDEWALK 5 INCH	SQ FT	11,412.5	3,967.0	210.0	645.0	4,482.5	1,371.0	855.0	527.0							
* 42400800	DETECTABLE WARNINGS	SQ FT	932	350	30	20	343	90	51	68							
44000100	PAVEMENT REMOVAL	SQ YD	74			26	26	48									
44000161	HOT-MIX ASPHALT SURFACE REMOVAL, 3"	SQ YD	713	146	29	39	246	112	138	42							
44000200	DRIVEWAY PAVEMENT REMOVAL	SQ YD	77	19			58										
44000500	COMBINATION CURB AND GUTTER REMOVAL	FOOT	1,064	452	12	6	569	31									
44000600	SIDEWALK REMOVAL	SQ FT	8,811	3,233	122	313	3,424	1,022	615	395							
44201329	CLASS C PATCHES, TYPE II, 8 INCH	SQ YD	6				6										
44201333	CLASS C PATCHES, TYPE III, 8 INCH	SQ YD	16				16										
50200100	STRUCTURE EXCAVATION	CU YD	24	24													
50300225	CONCRETE STRUCTURES	CU YD	7.9	7.9													
50800105	REINFORCEMENT BARS	POUND	380	380													
50800205	REINFORCEMENT BARS, EPOXY COATED	POUND	310	310													
50901760	PIPE HANDRAIL	FOOT	38.0	38.0													

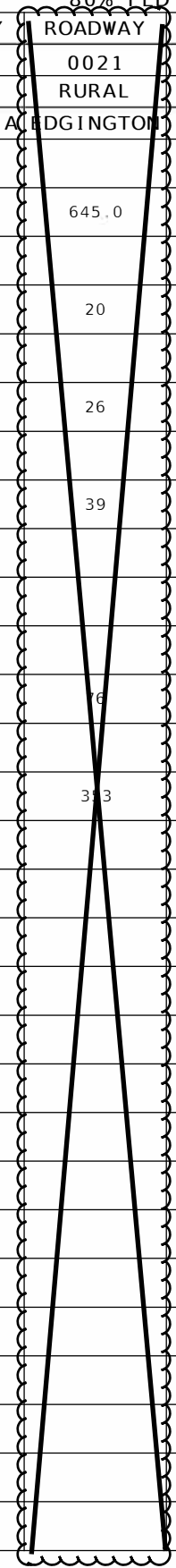

MODEL: Default
 FILE NAME: P:\ipg\arcam\dot\illinois.gov\PIW\DOT\Documents\DOT - Offices\District 2\Project\020215\020215_01\CAD\data\CAD\sheet\020215_01_01.cad-ht-500.imprter.dgn

* SPECIALTY ITEM

USER NAME = cuccioaj	DESIGNED - AIC	REVISED -
	DRAWN -	REVISED -
PLOT SCALE = 100.0000' / in.	CHECKED -	REVISED -
PLOT DATE = 8/11/2021	DATE - 12/3/2019	REVISED -

STATE OF ILLINOIS
DEPARTMENT OF TRANSPORTATION

SUMMARY OF QUANTITIES

SCALE: SHEET 2 OF 7 SHEETS STA. TO STA.

F.A. * RTE.	SECTION	COUNTY	TOTAL SHEETS	SHEET NO.
VAR.	D2 SW2016-1	VAR.	116	5
			CONTRACT NO. 64L12	
ILLINOIS FED. AID PROJECT				

SUMMARY OF QUANTITIES

<div style="display: flex; justify-content: space-between;"> CONSTRUCTION CODE STP FUNDS </div>				80% FED / 20% STATE																	
				80% FED / 20% STATE								80% FED/ 10% STATE/ 10% LOCAL	100% LOCAL	100% LOCAL							
				ROADWAY	ROADWAY	ROADWAY	ROADWAY	ROADWAY	ROADWAY	ROADWAY	ROADWAY	SIGNALS	ROADWAY	ROADWAY							
				0021	0021	0021	0021	0021	0021	0021	0021	0021	0021	0021							
URBAN	URBAN	RURAL	URBAN	RURAL	RURAL	RURAL	RURAL	URBAN	URBAN	URBAN											
COAL VALLEY	ANDALUSIA	EDGINGTON	ALPHA	WOODHULL	ANDOVER	OSCO	COAL VALLEY	COAL VALLEY	ALPHA	ALPHA											
CODE NO.	ITEM	UNIT	TOTAL QUANTITY																		
542A0220	PIPE CULVERTS, CLASS A, TYPE 1 15"	FOOT	7			7															
542D0220	PIPE CULVERTS, CLASS D, TYPE 1 15"	FOOT	19					19													
54213660	PRECAST REINFORCED CONCRETE FLARED END SECTIONS 15"	EACH	2			2															
54244405	FLUSH INLET BOX FOR MEDIAN, STANDARD 542546	EACH	1						1												
54260515	SLOPED METAL END SECTION, STANDARD 542411, 15", 1:6	EACH	1						1												
550A0050	STORM SEWERS, CLASS A, TYPE 1 12"	FOOT	16					16													
60221100	MANHOLES, TYPE A, 5'-DIAMETER, TYPE 1 FRAME, CLOSED LID	EACH	1						1												
60235700	INLETS, TYPE A, TYPE 3 FRAME AND GRATE	EACH	1						1												
60240220	INLETS, TYPE B, TYPE 3 FRAME AND GRATE	EACH	1						1												
60255500	MANHOLES TO BE ADJUSTED	EACH	1				2													1	
60260100	INLETS TO BE ADJUSTED	EACH	11							2									4	5	
60266600	VALVE BOXES TO BE ADJUSTED	EACH	7			1			2	2									1	1	
60500060	REMOVING INLETS	EACH	1						1												
60603500	COMBINATION CONCRETE CURB AND GUTTER, TYPE B-6.06	FOOT	12			12.0															

MODEL: D:\p1\planroom.dwg; FILE NAME: p1\planroom.dwg; PROJECT: 210221\Projects\210221\B\CAD\Drawings\CAD\Drawings\210221\B_AIC-sht-500_Import.rvt

* SPECIALTY ITEM

	USER NAME = cuccioaj	DESIGNED - AIC	REVISED -	STATE OF ILLINOIS DEPARTMENT OF TRANSPORTATION	SUMMARY OF QUANTITIES SCALE: SHEET 3 OF 7 SHEETS STA. TO STA.	F.A. * RTE.	SECTION	COUNTY	TOTAL SHEETS	SHEET NO.
	PLOT SCALE = 100.0000' / in.	CHECKED -	REVISED -			VAR.	D2 SW2016-1	VAR.	116	6
	PLOT DATE = 8/11/2021	DATE = 12/3/2019	REVISED -			CONTRACT NO. 64L12		ILLINOIS FED. AID PROJECT		

SUMMARY OF QUANTITIES

CONSTRUCTION CODE

STP FUNDS

80% FED / 20% STATE

80% FED/ 10% STATE/ 10% LOCAL

100% LOCAL

100% LOCAL

CODE NO.	ITEM	UNIT	TOTAL QUANTITY	80% FED / 20% STATE										80% FED/ 10% STATE/ 10% LOCAL	100% LOCAL	100% LOCAL
				ROADWAY	ROADWAY	ROADWAY	ROADWAY	ROADWAY	ROADWAY	ROADWAY	ROADWAY	SIGNALS	ROADWAY	ROADWAY		
				0021	0021	0021	0021	0021	0021	0021	0021	0021	0021	0021		
				URBAN	URBAN	RURAL	URBAN	RURAL	RURAL	RURAL	URBAN	URBAN	URBAN			
		COAL VALLEY	ANDALUSIA	EDGINGTON	ALPHA	WOODHULL	ANDOVER	OSCO	COAL VALLEY	COAL VALLEY	ALPHA					
60605000	COMBINATION CONCRETE CURB AND GUTTER, TYPE B-6.24	FOOT	1,413	453.5		76.0	768.0	79.0	101.0	11.5						
* 66700305	PERMANENT SURVEY MARKERS, TYPE 11	EACH	6	1		1	2	2	1							
67000400	ENGINEER'S FIELD OFFICE, TYPE A	CAL MO	6.0	2.0	0.5	0.5	2.5		0.5	0.5						
67100100	MOBILIZATION	L SUM	1.0	0.35	0.05	0.05	0.40	0.10	0.05	0.05						
70102620	TRAFFIC CONTROL AND PROTECTION, STANDARD 701501	L SUM	1.0	0.35	0.05	0.05	0.40	0.10	0.05	0.05						
70102635	TRAFFIC CONTROL AND PROTECTION, STANDARD 701701	L SUM	1.0	0.35	0.05	0.05	0.40	0.10	0.05	0.05						
70102640	TRAFFIC CONTROL AND PROTECTION, STANDARD 701801	L SUM	1.0	0.35	0.05	0.05	0.40	0.10	0.05	0.05						
70103815	TRAFFIC CONTROL SURVEILLANCE	CAL DA	26	10	1	1	10	3	1	1						
* 72400710	RELOCATE SIGN PANEL - TYPE 1	SQ FT	9										9			
* 78000400	THERMOPLASTIC PAVEMENT MARKING - LINE 6"	FOOT	1,675	1,128	76	102	303		168							
* 78000650	THERMOPLASTIC PAVEMENT MARKING - LINE 24"	FOOT	860	554	30	42	191		85							
* 81028760	UNDERGROUND CONDUIT, COILABLE NONMETALLIC CONDUIT, 2 1/2" DIA.	FOOT	96										96			
* 81028790	UNDERGROUND CONDUIT, COILABLE NONMETALLIC CONDUIT, 4" DIA.	FOOT	75										75			
* 81400710	HEAVY-DUTY HANDHOLE, PORTLAND CEMENT CONCRETE	EACH	2										2			

* SPECIALTY ITEM

MODEL: Default
FILE NAME: P:\p1garncom.dct\illinois.gov\PW\DOT\Documents\DOT Offices\District 2\Project\020216\CAD\data\CAD\sheet\020216_AIC-ht-500_Import.rgn

USER NAME = cuccioaj	DESIGNED - AIC	REVISED -
	DRAWN -	REVISED -
PLOT SCALE = 100.0000' / in.	CHECKED -	REVISED -
PLOT DATE = 8/11/2021	DATE - 12/3/2019	REVISED -

STATE OF ILLINOIS
DEPARTMENT OF TRANSPORTATION

SUMMARY OF QUANTITIES

SCALE: SHEET 4 OF 7 SHEETS STA. TO STA.

F.A. * RTE.	SECTION	COUNTY	TOTAL SHEETS	SHEET NO.
VAR.	D2 SW2016-1	VAR.	116	7
			CONTRACT NO. 64L12	
ILLINOIS FED. AID PROJECT				

REV. 10/20/21 REV. 9/27/21

SUMMARY OF QUANTITIES

CONSTRUCTION CODE

STP FUNDS

80% FED / 20% STATE

80% FED/ 10% STATE/ 10% LOCAL

100% LOCAL

100% LOCAL

CODE NO.	ITEM	UNIT	TOTAL QUANTITY	80% FED / 20% STATE										80% FED/ 10% STATE/ 10% LOCAL	100% LOCAL	100% LOCAL
				ROADWAY	ROADWAY	ROADWAY	ROADWAY	ROADWAY	ROADWAY	ROADWAY	ROADWAY	SIGNALS	ROADWAY	ROADWAY		
				0021	0021	0021	0021	0021	0021	0021	0021	0021	0021	0021		
				URBAN	URBAN	RURAL	URBAN	RURAL	RURAL	RURAL	RURAL	URBAN	URBAN	URBAN		
				COAL VALLEY	ANDALUSIA	EDGINGTON	ALPHA	WOODHULL	ANDOVER	OSCO	COAL VALLEY	COAL VALLEY	ALPHA			
* 85000200	MAINTENANCE OF EXISTING TRAFFIC SIGNAL INSTALLATION	EACH	2										2			
* 87301215	ELECTRIC CABLE IN CONDUIT, SIGNAL NO. 14 2C	FOOT	239										239			
* 87301225	ELECTRIC CABLE IN CONDUIT, SIGNAL NO. 14 3C	FOOT	249										249			
* 87301245	ELECTRIC CABLE IN CONDUIT, SIGNAL NO. 14 5C	FOOT	279										279			
* 87301255	ELECTRIC CABLE IN CONDUIT, SIGNAL NO. 14 7C	FOOT	254										254			
* 87502460	TRAFFIC SIGNAL POST, GALVANIZED STEEL 12 FT.	EACH	1										1			
* 87700210	STEEL MAST ARM ASSEMBLY AND POLE, 34 FT.	EACH	1										1			
* 87800100	CONCRETE FOUNDATION, TYPE A	FOOT	6										6			
* 87800400	CONCRETE FOUNDATION, TYPE E 30-INCH DIAMETER	FOOT	14										14			
* 87900200	DRILL EXISTING HANDHOLE	EACH	1										1			
* 88040070	SIGNAL HEAD, POLYCARBONATE, LED, 1-FACE, 3-SECTION, BRACKET MOUNTED	EACH	1										1			
* 88040090	SIGNAL HEAD, POLYCARBONATE, LED, 1-FACE, 3-SECTION, MAST ARM MOUNTED	EACH	1										1			
* 88040160	SIGNAL HEAD, POLYCARBONATE, LED, 1-FACE, 5-SECTION, MAST ARM MOUNTED	EACH	1										1			
* 88102717	PEDESTRIAN SIGNAL HEAD, LED, 1-FACE, BRACKET MOUNTED WITH COUNTDOWN TIMER	EACH	12										12			

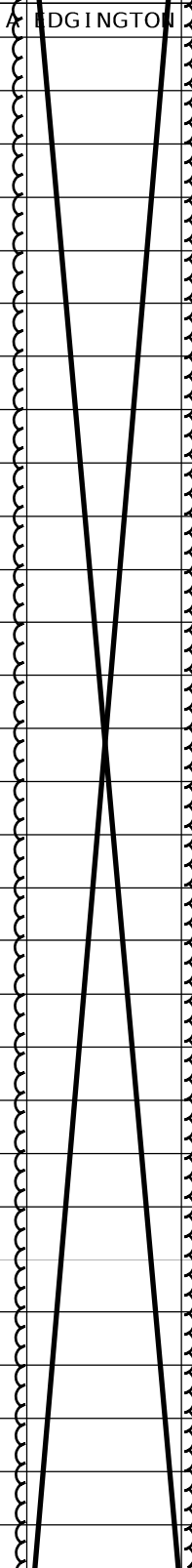

* SPECIALTY ITEM

MODEL: Default
 FILE: \\s:\p\pub\baronm.d\at\illinois.gov\PI\DOT\Documents\DOT_Offices\Director_2\Projects\ID2025\16_AIC-Int-500_Import\ref.dgn

USER NAME = cuccioaj	DESIGNED - AIC	REVISED -
	DRAWN -	REVISED -
PLOT SCALE = 100.0000 ' / in.	CHECKED -	REVISED -
PLOT DATE = 8/11/2021	DATE - 12/3/2019	REVISED -

**STATE OF ILLINOIS
DEPARTMENT OF TRANSPORTATION**

SUMMARY OF QUANTITIES

SCALE: SHEET 5 OF 7 SHEETS STA. TO STA.

F.A. RTE.	SECTION	COUNTY	TOTAL SHEETS	SHEET NO.
VAR.	D2 SW2016-1	VAR.	116	8
CONTRACT NO. 64L12				
ILLINOIS FED. AID PROJECT				

SUMMARY OF QUANTITIES

CONSTRUCTION CODE

STP FUNDS

80% FED / 20% STATE

80% FED/ 10% STATE/ 10% LOCAL

100% LOCAL

100% LOCAL

CODE NO.	ITEM	UNIT	TOTAL QUANTITY	80% FED / 20% STATE		80% FED / 10% STATE / 10% LOCAL		100% LOCAL		100% LOCAL								
				ROADWAY	ROADWAY	ROADWAY	ROADWAY	ROADWAY	ROADWAY	SIGNALS	ROADWAY	ROADWAY						
				0021	0021	0021	0021	0021	0021	0021	0021	0021						
URBAN		URBAN		RURAL		RURAL		RURAL		RURAL	RURAL							
COAL VALLEY		ANDALUSIA		EDGINGTON		ALPHA		WOODHULL		ANDOVER	OSCO	COAL VALLEY	COAL VALLEY	ALPHA				
* 88200100	TRAFFIC SIGNAL BACKPLATE	EACH	2											2				
* 88800100	PEDESTRIAN PUSH-BUTTON	EACH	10															10
* 89501250	RELOCATE EXISTING TRAFFIC SIGNAL EQUIPMENT	EACH	1															1
* 89502210	MODIFY EXISTING CONTROLLER CABINET	EACH	2															2
* 89502375	REMOVE EXISTING TRAFFIC SIGNAL EQUIPMENT	EACH	2															2
* 89502380	REMOVE EXISTING HANDHOLE	EACH	1															1
* 89502385	REMOVE EXISTING CONCRETE FOUNDATION	EACH	2															2
* X0322951	CABLE SPLICE SPECIAL	EACH	7															7
X4402805	ISLAND REMOVAL	SQ FT	710	710														
X5012610	CONCRETE HEADWALL REMOVAL PARTIAL	EACH	1		1													
X6060714	CONCRETE MEDIAN (SPECIAL)	SQ FT	710	710														
Z0013798	CONSTRUCTION LAYOUT	L SUM	1.0	0.35	0.05	0.05	0.40	0.10	0.05	0.05								
* Z0025505	PROPERTY MARKERS	EACH	35	11			10	7		7								
* Z0033072	VIDEO VEHICLE DETECTION SYSTEM	EACH	2															2

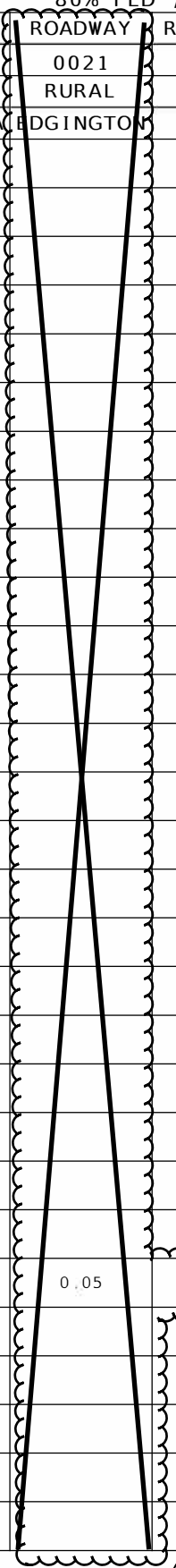

MODEL: Default
FILE NAME: P:\pjancom.dct\illinois.gov\PWDOT\Documents\DOT_Offices\District_2\Project\020216\CAD\data\CAD\sheet020216_AIC-ht-500_printer.dgn

* SPECIALTY ITEM

USER NAME = cuccioaj	DESIGNED - AIC	REVISED -
	DRAWN -	REVISED -
PLOT SCALE = 100.0000 ' / in.	CHECKED -	REVISED -
PLOT DATE = 8/11/2021	DATE - 12/3/2019	REVISED -

STATE OF ILLINOIS
DEPARTMENT OF TRANSPORTATION

SUMMARY OF QUANTITIES

SCALE: SHEET 6 OF 7 SHEETS STA. TO STA.

F.A. * RTE.	SECTION	COUNTY	TOTAL SHEETS	SHEET NO.
VAR.	D2 SW2016-1	VAR.	116	9
CONTRACT NO. 64L12				
ILLINOIS FED. AID PROJECT				

SUMMARY OF QUANTITIES

CONSTRUCTION CODE

STP FUNDS

80% FED / 20% STATE

80% FED/ 10% STATE/ 10% LOCAL

100% LOCAL

100% LOCAL

CODE NO.	ITEM	UNIT	TOTAL QUANTITY	80% FED / 20% STATE										80% FED/ 10% STATE/ 10% LOCAL	100% LOCAL	100% LOCAL
				ROADWAY	ROADWAY	ROADWAY	ROADWAY	ROADWAY	ROADWAY	ROADWAY	ROADWAY	SIGNALS	ROADWAY	ROADWAY		
				0021	0021	0021	0021	0021	0021	0021	0021	0021	0021	0021		
				URBAN	URBAN	RURAL	URBAN	RURAL	RURAL	RURAL	RURAL	URBAN	URBAN	URBAN		
				COAL VALLEY	ANDALUSIA	EDGINGTON	ALPHA	WOODHULL	ANDOVER	OSCO	COAL VALLEY	COAL VALLEY	ALPHA			
66900200	NON-SPECIAL WASTE DISPOSAL	CU YD	115	39	13		31	21	6	5						
66901001	REGULATED SUBSTANCES PRE-CONSTRUCTION PLAN	L SUM	1	0.30	0.10		0.30	0.20	0.05	0.05						
66901006	REGULATED SUBSTANCES MONITORING	CAL DA	15	4	2		4	3	1	1						
66901003	REGULATED SUBSTANCES FINAL CONSTRUCTION REPORT	L SUM	1	0.30	0.10		0.30	0.20	0.05	0.05						
66900530	SOIL DISPOSAL ANALYSIS	EACH	11	3	1		3	2	1	1						

* SPECIALTY ITEM

MODEL: Default
FILE: Model: P:\pub\baronm.dwg
PROJECT: I:\Projects\2025\16_CAD\Drawings\2025\16_AIC\11-500_Import.dgn

USER NAME = cuccioaj	DESIGNED - AJC	REVISED -
	DRAWN -	REVISED -
PLOT SCALE = 100.0000' / in.	CHECKED -	REVISED -
PLOT DATE = 8/11/2021	DATE - 12/3/2019	REVISED -

STATE OF ILLINOIS
DEPARTMENT OF TRANSPORTATION

SUMMARY OF QUANTITIES

SCALE: SHEET 7 OF 7 SHEETS STA. TO STA.

F.A. RTE.	SECTION	COUNTY	TOTAL SHEETS	SHEET NO.
VAR.	D2 SW2016-1	VAR.	116	10
CONTRACT NO. 64L12				
ILLINOIS FED. AID PROJECT				

SCHEDULE OF QUANTITIES - EDGINGTON

20200100 EARTH EXCAVATION						28000500 INLET AND PIPE PROTECTION						42400200 PORTLAND CEMENT CONCRETE SIDEWALK 5 INCH						
EDGINGTON						EDGINGTON						EDGINGTON						
QUANTITY BY QUADRANT (CU YD)						QUANTITY BY QUADRANT (EACH)						QUANTITY BY QUADRANT (SQ FT)						
IL 192 &	NE	NW	SW	SE	TOTAL	IL 192 &	NE	NW	SW	SE	TOTAL	IL 192 &	NE	NW	SW	SE	TOTAL	
140th St	3.9			6.5	10.4	140th St	1.0				1.0	140th St	222.0				423.0	645.0
					<i>Edginton Total</i>						<i>Edginton Total</i>						<i>Edginton Total</i>	
					10.4						1.0						645.0	

21101615 TOPSOIL FURNISH AND PLACE, 4"						35101400 AGGREGATE BASE COURSE, TYPE B						42400800 DETECTABLE WARNINGS						
EDGINGTON						EDGINGTON						EDGINGTON						
QUANTITY BY QUADRANT (SQ YD)						QUANTITY BY QUADRANT (TON)						QUANTITY BY QUADRANT (SQ FT)						
IL 192 &	NE	NW	SW	SE	TOTAL	IL 192 &	NE	NW	SW	SE	TOTAL	IL 192 &	NE	NW	SW	SE	TOTAL	
140th St	39.5				39.5	As directed by the eng					10.0	140th St	10.0				10.0	20.0
					<i>Edginton Total</i>						<i>Edginton Total</i>						<i>Edginton Total</i>	
					39.5						10.0						20.0	

25200110 SODDING, SALT TOLERANT						40600290 BITUMINOUS MATERIALS (TACK COAT)						44000100 PAVEMENT REMOVAL						
EDGINGTON						EDGINGTON						REYNOLDS						
QUANTITY BY QUADRANT (SQ YD)						QUANTITY BY QUADRANT (POUND)						QUANTITY BY QUADRANT (SQ YD)						
IL 192 &	NE	NW	SW	SE	TOTAL	IL 192 &	NE	NW	SW	SE	TOTAL	IL 192 &	NE	NW	SW	SE	TOTAL	
140th St	39.5				39.5	140th St	4.0			13.3	17.3	140th St					26.2	26.2
					<i>Edginton Total</i>						<i>Edginton Total</i>						<i>Edginton Total</i>	
					39.5						17.3						26.2	

25200200 SUPPLEMENTAL WATERING						40600990 TEMPORARY RAMP						44000161 HOT-MIX ASPHALT SURFACE REMOVAL, 3"						
EDGINGTON						EDGINGTON						REYNOLDS						
QUANTITY BY QUADRANT (UNIT)						QUANTITY BY QUADRANT (SQ YD)						QUANTITY BY QUADRANT (SQ YD)						
IL 192 &	NE	NW	SW	SE	TOTAL	IL 192 &	NE	NW	SW	SE	TOTAL	IL 192 &	NE	NW	SW	SE	TOTAL	
140th St	0.4				0.4	140th St	2.7			2.4	5.1	140th St	8.9				29.6	38.5
					<i>Edginton Total</i>						<i>Edginton Total</i>						<i>Edginton Total</i>	
					0.4						5.1						38.5	

28000250 TEMPORARY EROSION CONTROL SEEDING						40800050 INCIDENTAL HOT-MIX ASPHALT SURFACING						44000500 COMBINATION CURB AND GUTTER REMOVAL						
EDGINGTON						EDGINGTON						EDGINGTON						
QUANTITY BY QUADRANT (POUND)						QUANTITY BY QUADRANT (TON)						QUANTITY BY QUADRANT (FOOT)						
IL 192 &	NE	NW	SW	SE	TOTAL	IL 192 &	NE	NW	SW	SE	TOTAL	IL 192 &	NE	NW	SW	SE	TOTAL	
140th St	2.5				2.5	140th St	1.6			5.4	7.0	140th St	39.0				37.0	76.0
					<i>Edginton Total</i>						<i>Edginton Total</i>						<i>Edginton Total</i>	
					2.5						7.0						76.0	

44000600 SIDEWALK REMOVAL					
EDGINGTON					
QUANTITY BY QUADRANT (SQ FT)					
IL 192 &	NE	NW	SW	SE	TOTAL
140th St	169.0				169.0
					<i>Edginton Total</i>
					353.0

SHEET DELETED

MODEL: Default
 FILE: I:\M&E_Planroom\dot Illinois.gov\PI\DOT\Documents\DOT_Offices\District 2\Projects\ID2025\16_CAD\data\CAD\sheet\ID2025_16_AIC-ent-Schedule_Importent_NEW.dgn
 PROJECT: ID2025\16_CAD\data\CAD\sheet\ID2025_16_AIC-ent-Schedule_Importent_NEW.dgn

USER NAME = cuccioaj	DESIGNED -	REVISED -
	DRAWN -	REVISED -
PLOT SCALE = 100,0091' / In.	CHECKED -	REVISED -
PLOT DATE = 8/11/2021	DATE -	REVISED -

STATE OF ILLINOIS
DEPARTMENT OF TRANSPORTATION

SCHEDULE OF QUANTITIES			
SCALE:	SHEET 6	OF 15 SHEETS	STA. TO STA.

F.A. RTE.	SECTION	COUNTY	TOTAL SHEETS	SHEET NO.
VAR.	D2 SW2016-1	VAR.	16	16
ILLINOIS FED. AID PROJECT			CONTRACT NO. 64L12	

SHEET DELETED

CHAIN IL92 CONTAINS:
CUR A869220 CUR A869230

BEGINNING CHAIN IL92 DESCRIPTION

CURVE DATA
CURVE A869220
P.I. STATION 130+03.15 N 1,719,842.5579 E 2,128,289.2687
DELTA = 1° 56' 03.57" (LT)
DEGREE = 0° 50' 00.15"
TANGENT = 296.2281
LENGTH = 592.0900
RADIUS = 6,875.1577
EXTERNAL = 6.3788
LONG CHORD = 591.9070
MID. ORD. = 6.3729
P.C. STATION 127+06.92 N 1,719,874.4196 E 2,127,994.7591
P.T. STATION 132+99.01 N 1,719,836.1463 E 2,128,585.4274
C.C. N 1,726,709.6934 E 2,128,734.2363
BACK = S 83° 49' 31.60" E
AHEAD = S 88° 45' 35.17" E
CHORD BEAR = S 86° 17' 33.38" E

COURSE FROM PT A869220 TO PC A869230 S 88°45' 35.17" E DIST 10,369.4229

CURVE DATA

CURVE A869230
P.I. STATION 242+87.85 N 1,719,598.2992 E 2,139,571.6871
DELTA = 0° 46' 18.46" (LT)
DEGREE = 0° 03' 44.29"
TANGENT = 619.4111
LENGTH = 1,238.8035
RADIUS = 91,965.0938
EXTERNAL = 2.0859
LONG CHORD = 1,238.7941
MID. ORD. = 2.0859
P.C. STATION 236+68.43 N 1,719,611.7060 E 2,138,952.4211
P.T. STATION 249+07.24 N 1,719,593.2352 E 2,140,191.0775
C.C. N 1,811,555.2554 E 2,140,942.9528
BACK = S 88° 45' 35.17" E
AHEAD = S 89° 31' 53.63" E
CHORD BEAR = S 89° 08' 44.40" E

REFERENCE TIES

POINT	NORTH	EAST	ELEVATION	STATION	OFFSET	DESCRIPTION
1	1719705.8133	2132798.5488	782.1277	175+13.97	39.11' RT	PK NAIL E-LEVEL TOPO SURVEY POINT
2	1719781.5232	2132716.5588	782.7701	174+30.36	34.81' LT	PIN W/ CAP E-LEVEL TOPO SURVEY POINT
3	1719790.9739	2132967.9201	783.7159	176+81.46	49.69' LT	CHISELED SQUARE W/ SIDE ON SIGN BASE CHISELED SQUARE (TBM)

TIES ARE NOT PROVIDED POINT (LOCATED OUTSIDE OF AVAILABLE TOPO SURVEY).

HORIZONTAL CONTROL POINTS
N.T.S. POINTS NO. 1 AND 2

USER NAME = cuccioaj	DESIGNED -	REVISED -
	DRAWN -	REVISED -
PLOT SCALE = 6000.0000 ' / in.	CHECKED -	REVISED -
PLOT DATE = 8/10/2021	DATE -	REVISED -

STATE OF ILLINOIS
DEPARTMENT OF TRANSPORTATION

1L 192 AND 140TH ST WEST (EDGINGTON)
HORIZONTAL & VERTICAL CONTROL

SCALE: 1" = 400' SHEET 1 OF 1 SHEETS STA. TO STA.

F.A. RTE.	SECTION	COUNTY	TOTAL SHEETS	SHEET NO.
VAR.	D25W2016-1	ROCK ISLAND	116	30
		CONTRACT NO. 64112		
ILLINOIS FED. AID PROJECT				

REV. 10/20/21

MODEL: Default
FILE NAME: p:\work\p\140th\DOT\Documents\DOT - Offices\Bartel 2\Project\102025\16\CAD\Drawings\102025\16_A1C-SubPage Numbering.dgn

SHEET DELETED

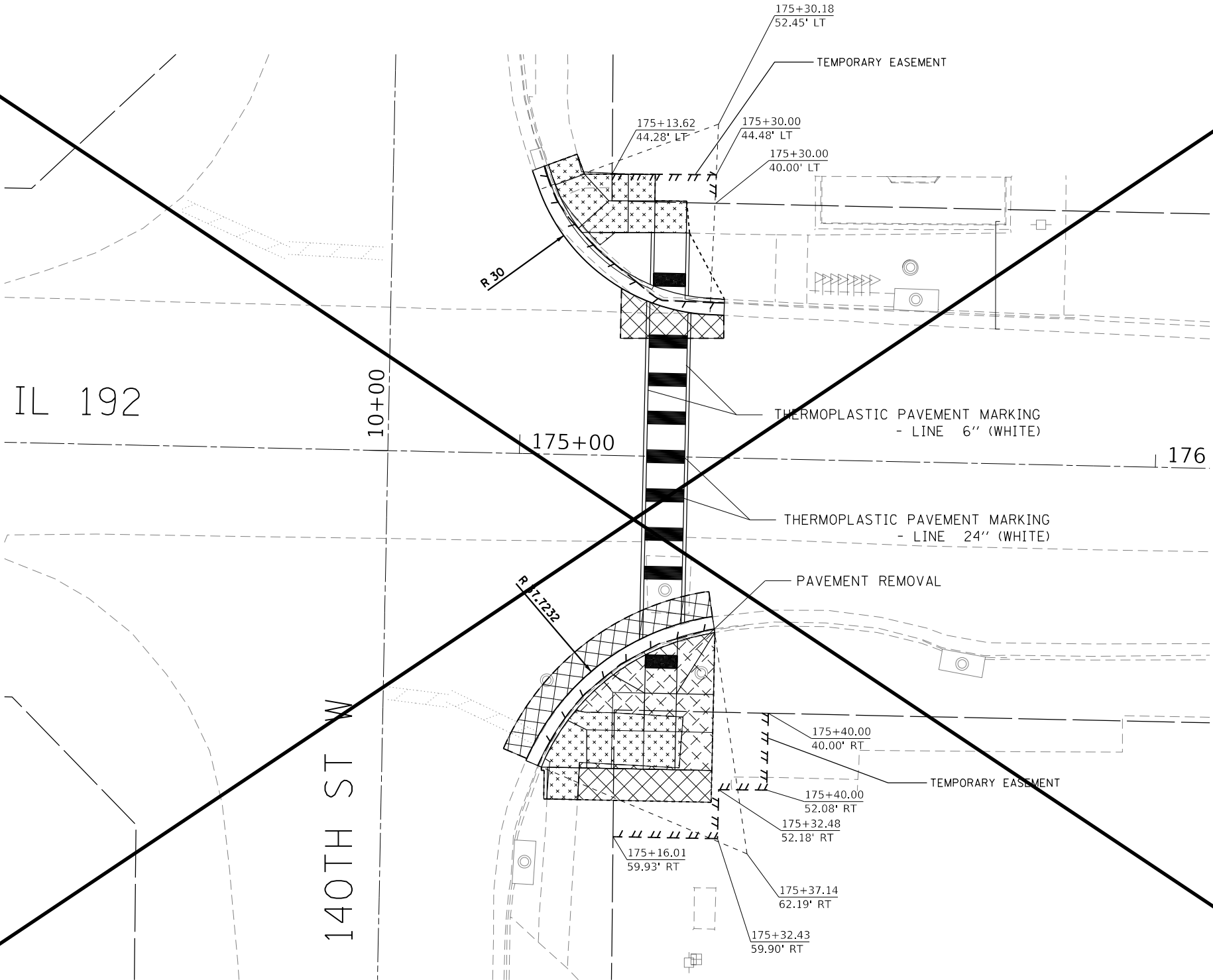

LEGEND:

- LIMIT OF CONSTRUCTION
- EXISTING ROW
- TEMPORARY EASEMENT
- PROPOSED ROW
- COMBINATION CURB AND GUTTER REMOVAL
- DETECTABLE WARNINGS
- HOT-MIX ASPHALT SURFACE REMOVAL, 3"
- CLASS C PATCHES, TYPE II & III, 8 INCH
- SIDEWALK REMOVAL
- DRIVEWAY REMOVAL
- PAVEMENT REMOVAL

USER NAME = cuccklaaj	DESIGNED -	REVISED -
	DRAWN -	REVISED -
PLOT SCALE = 6000,0000 ' / In.	CHECKED -	REVISED -
PLOT DATE = 8/11/2021	DATE -	REVISED -

**STATE OF ILLINOIS
DEPARTMENT OF TRANSPORTATION**

RIGHT OF WAY AND REMOVAL SHEETS - EDGINGTON
SCALE: 1" = 20' SHEET 1 OF 1 SHEETS STA. TO STA.

F.A.S. RTE.	SECTION	COUNTY	TOTAL SHEETS	SHEET NO.
1205	D2 SW 2016-1	ROCK ISLAND	17	43
			CONTRACT NO. 68112	
			ILLINOIS FED. AID PROJECT	

MODEL: Default
 FILE: \\media-prod\planroom\dot\illinois\pwr\IUDOT\Documents\IUDOT_Offices\IUDOT_2\Projects\ID2025\16\CAD\Drawings\CAD\Drawings\ID2025\16_A\1-C\Sheet\Page_Number\Sheet1.dgn

SHEET DELETED

NE RAMP

140TH ST WEST

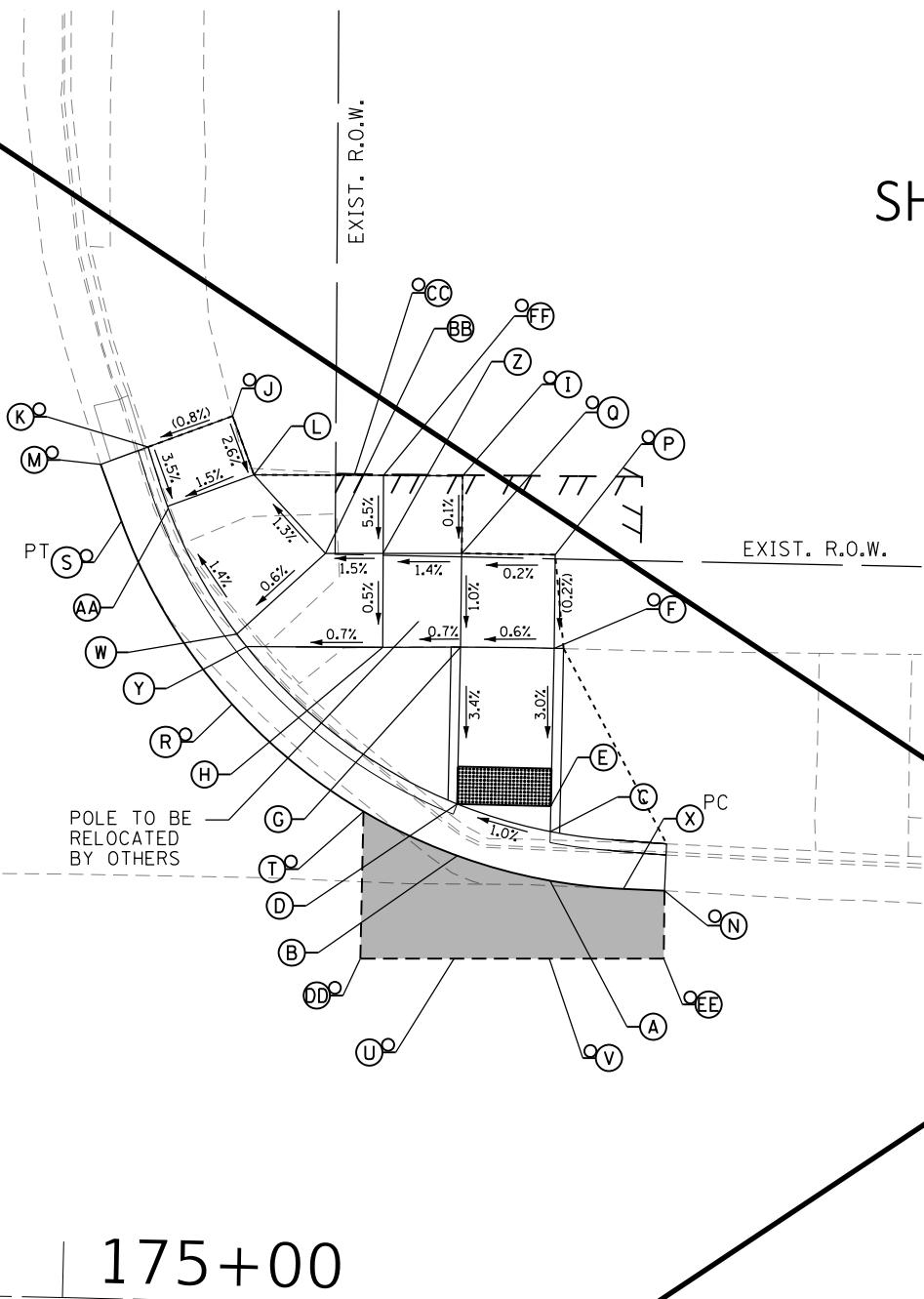

POINT	STATION	OFFSET	SIDE	ELEVATION
A	175+25.50	22.82	LT	782.35
B	175+20.50	24.06	LT	782.30
C	175+25.50	25.44	LT	782.31
D	175+20.50	26.80	LT	782.26
E	175+25.50	26.80	LT	782.32
F	175+25.50	35.22	LT	782.57
G	175+20.50	35.18	LT	782.54
H	175+16.34	35.08	LT	782.51
I	175+20.41	44.33	LT	782.59
J	175+08.06	47.25	LT	782.50
K	175+03.59	45.50	LT	782.46
L	175+09.27	44.14	LT	782.41
M	175+01.07	44.52	LT	781.97
N	175+31.66	22.41	LT	782.41
O	175+32.72	24.92	LT	782.79
P	175+25.50	40.25	LT	782.58
Q	175+20.45	40.15	LT	782.59
R	175+08.37	31.86	LT	782.05
S	175+02.24	41.54	LT	781.96
T	175+15.50	26.29	LT	782.20
U	175+20.50	18.55	LT	782.46
V	175+25.59	18.66	LT	782.50
W	175+08.54	35.62	LT	782.45
X	175+29.47	22.46	LT	782.39
Y	175+09.07	34.96	LT	782.46
Z	175+16.25	40.09	LT	782.53
AA	175+04.74	42.24	LT	782.34
BB	175+13.18	40.03	LT	782.49
CC	175+14.65	44.29	LT	782.61
DD	175+15.50	18.44	LT	782.46
EE	175+31.71	18.79	LT	782.50
FF	175+16.18	44.26	LT	782.60

175+00

IL 192

LEGEND:

- LIMIT OF CONSTRUCTION
- PROPOSED ELEVATION
- EXISTING ELEVATION
- SIDEWALK/PAVEMENT GRADE
- [Hatched Box] DETECTABLE WARNINGS
- [Solid Box] 3" INCIDENTAL HOT-MIX ASPHALT SURFACING
- [Diagonal Lines Box] CLASS C PATCHES, TYPE II & III, 8 INCH
- [Dashed Box] PCC DRIVEWAY PAVEMENT, 7 INCH

MODEL: Default
 FILE: I:\a\c\p\p\planroom\dat\Illinois\p\p\p\DOT\Documents\DOT_Offices\District 2\Projects\ID2025\16_AIC_sht-140th.dgn

USER NAME = cuccioaj	DESIGNED -	REVISED -
	DRAWN -	REVISED -
PLOT SCALE = 6000.5455' / In.	CHECKED -	REVISED -
PLOT DATE = 8/10/2021	DATE -	REVISED -

**STATE OF ILLINOIS
DEPARTMENT OF TRANSPORTATION**

IL 192 AND 140TH ST WEST (EDGINGTON) SIDEWALK RAMP DETAIL			
SCALE:	SHEET 1	OF 2 SHEETS	STA. TO STA.

F.A.P. RTE.	SECTION	COUNTY	TOTAL SHEETS	SHEET NO.
VAR.	D2 SW2016-1	ROCK ISLAND	116	73
CONTRACT NO. 64112				
ILLINOIS FED. AID PROJECT				

10

175+00

IL 192

SE RAMP

SHEET DELETED

POINT	STATION	OFFSET	SIDE	ELEVATION
A	175+20.50	28.33	RT	782.06
B	175+25.50	26.31	RT	782.11
C	175+20.50	31.24	RT	782.02
D	175+25.50	29.03	RT	782.07
E	175+25.50	31.24	RT	782.08
F	175+20.50	37.24	RT	782.06
G	175+25.50	37.24	RT	782.11
H	175+20.50	43.22	RT	782.12
I	175+25.50	43.22	RT	782.17
J	175+20.50	49.20	RT	782.08
K	175+25.50	49.19	RT	782.12
L	175+31.33	49.18	RT	782.17
M	175+31.33	43.22	RT	782.11
N	175+31.33	37.24	RT	782.16
O	175+15.50	43.22	RT	782.10
P	175+15.50	49.20	RT	782.03
Q	175+11.51	43.20	RT	782.09
R	175+10.47	49.22	RT	781.98
S	175+05.47	49.23	RT	781.91
T	175+05.50	54.23	RT	781.89
U	175+10.34	54.22	RT	781.92
V	175+30.89	24.99	RT	782.19
W	175+02.08	48.26	RT	781.48
X	175+31.33	27.50	RT	782.49
Y	175+15.50	37.24	RT	782.07
Z	175+08.51	41.81	RT	782.06
AA	175+06.41	40.31	RT	781.68
BB	175+04.52	49.23	RT	781.83
CC	175+02.21	47.94	RT	781.49
DD	175+15.48	34.51	RT	782.26
EE	175+14.12	35.64	RT	782.24
FF	175+30.23	21.04	RT	782.35
GG	175+03.15	37.99	RT	781.88
HH	174+98.49	46.46	RT	781.59
II	175+11.64	49.22	RT	782.00
JJ	175+31.33	54.18	RT	782.21
KK	175+20.50	23.93	RT	782.28
LL	175+25.50	22.12	RT	782.32

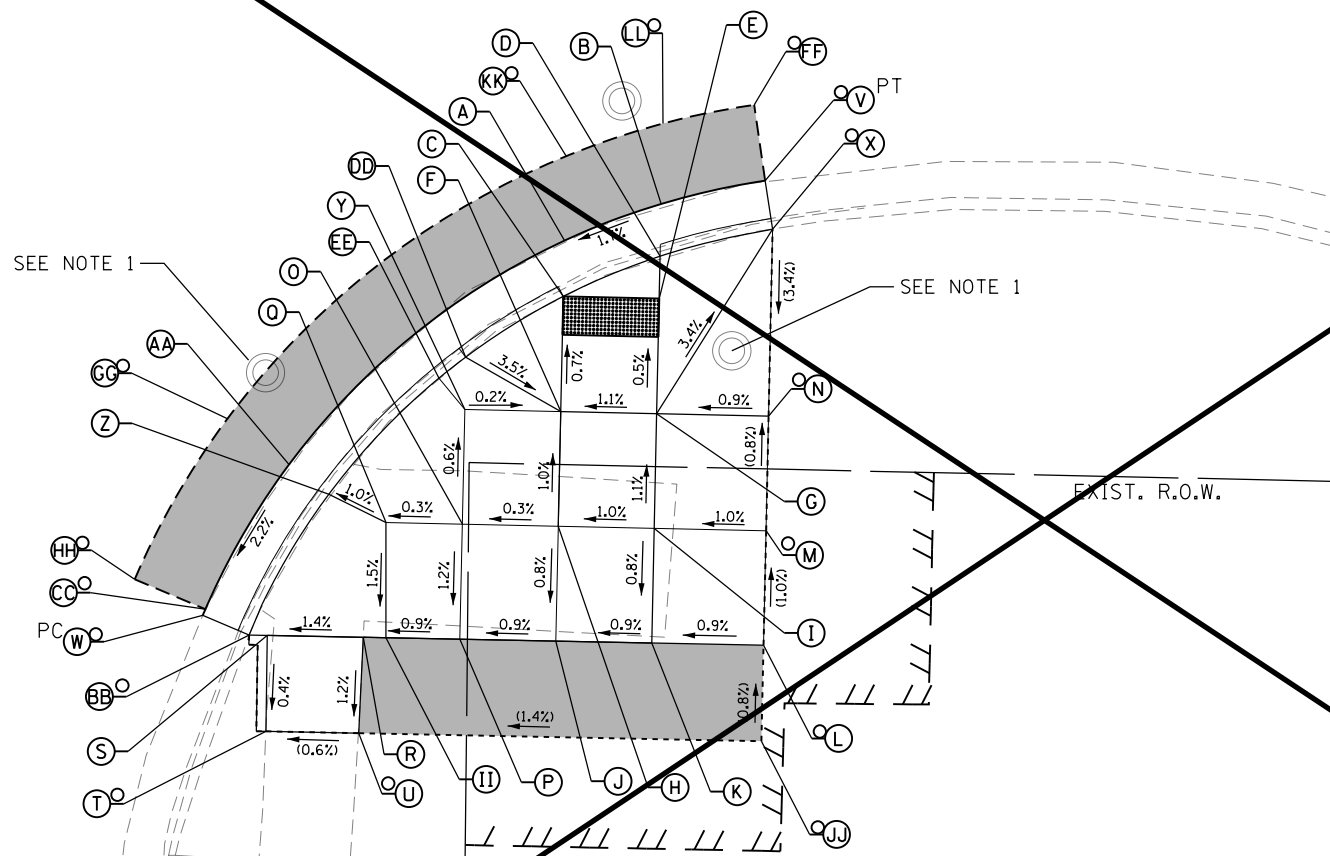

LEGEND:

- LIMIT OF CONSTRUCTION
- PROPOSED ELEVATION
- EXISTING ELEVATION
- SIDEWALK/PAVEMENT GRADE
- [Hatched] DETECTABLE WARNINGS
- [Solid] 3" INCIDENTAL HOT-MIX ASPHALT SURFACING
- [Diagonal] CLASS C PATCHES, TYPE II & III, 8 INCH
- [Dashed] PCC DRIVEWAY PAVEMENT, 7 INCH

NOTES:
1. MANHOLE TO BE ADJUSTED

140TH ST WEST

EXIST. R.O.W.

EXIST. R.O.W.

SEE NOTE 1

SEE NOTE 1

MODEL: Default
FILE: I:\a\c\p\planroom\dat\hink\p\w\DOT\Documents\DOT_Offices\District 2\Projects\ID2025\16\CAD\planroom\CAD\hink\sheet\ID2025\16_AIC_sht-16.dgn

USER NAME = cuccioaj	DESIGNED -	REVISED -
	DRAWN -	REVISED -
PLOT SCALE = 6000,5455' / in.	CHECKED -	REVISED -
PLOT DATE = 8/10/2021	DATE -	REVISED -

**STATE OF ILLINOIS
DEPARTMENT OF TRANSPORTATION**

**IL 192 AND 140TH ST WEST (EDGINGTON)
SIDEWALK RAMP DETAIL**

SCALE: SHEET 2 OF 2 SHEETS STA. TO STA.

F.A.P. RTE.	SECTION	COUNTY	TOTAL SHEETS	SHEET NO.
VAR.	D2 SW2016-1	ROCK ISLAND	116	74
ILLINOIS FED. AID PROJECT			CONTRACT NO. 64112	