

| | | | | |
|---|------------|----------------|--------------|-----------|
| F.A.P. RTE. | SECTION | COUNTY | TOTAL SHEETS | SHEET NO. |
| 330 | 465 VB-R-1 | COOK | 103 | 19 |
| STA. 175+51.76 | | TO STA. 184+00 | | |
| FED. ROAD DIST. NO. 1 ILLINOIS FED. AID PROJECT | | | | |
| CONTRACT NO. 60407 | | | | |

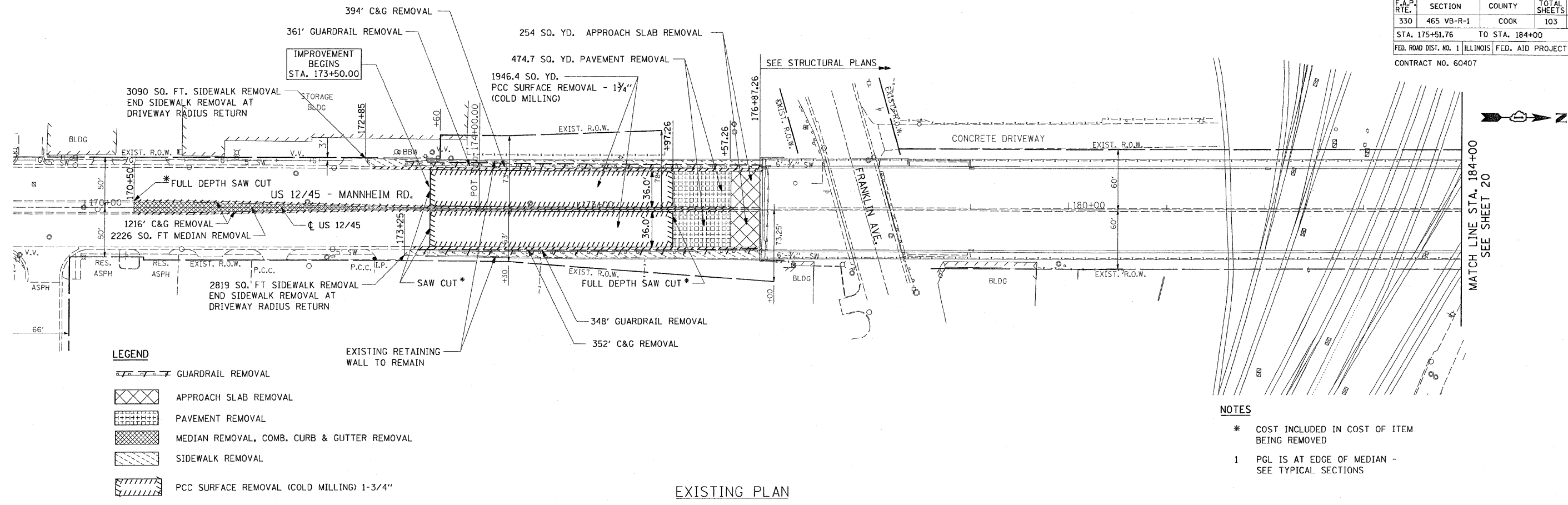

- LEGEND**
- GUARDRAIL REMOVAL
 - APPROACH SLAB REMOVAL
 - PAVEMENT REMOVAL
 - MEDIAN REMOVAL, COMB. CURB & GUTTER REMOVAL
 - SIDEWALK REMOVAL
 - PCC SURFACE REMOVAL (COLD MILLING) 1-3/4"

- NOTES**
- * COST INCLUDED IN COST OF ITEM BEING REMOVED
 - 1 PGL IS AT EDGE OF MEDIAN - SEE TYPICAL SECTIONS

EXISTING PLAN

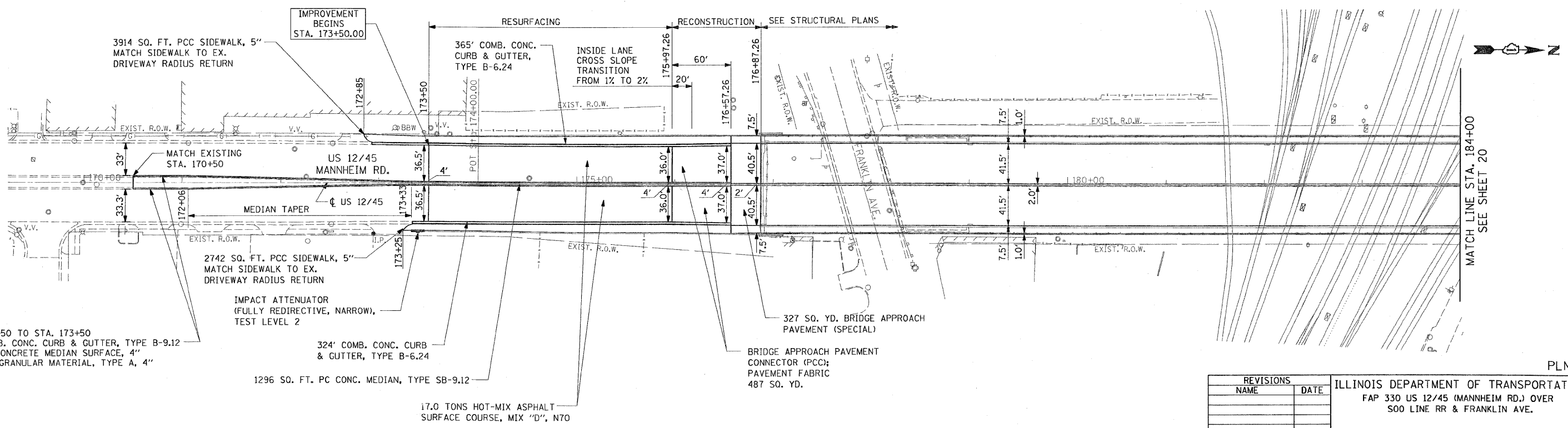

STA. 170+50 TO STA. 173+50
 600' COMB. CONC. CURB & GUTTER, TYPE B-9.12
 2181 SF CONCRETE MEDIAN SURFACE, 4"
 SUBBASE GRANULAR MATERIAL, TYPE A, 4"

324' COMB. CONC. CURB & GUTTER, TYPE B-6.24

1296 SQ. FT. PC CONC. MEDIAN, TYPE SB-9.12

17.0 TONS HOT-MIX ASPHALT SURFACE COURSE, MIX "D", N70

BRIDGE APPROACH PAVEMENT CONNECTOR (PCC); PAVEMENT FABRIC
 487 SQ. YD.

PROPOSED PLAN

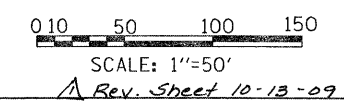

| REVISIONS | |
|-----------|------|
| NAME | DATE |
| | |
| | |
| | |
| | |
| | |
| | |
| | |

ILLINOIS DEPARTMENT OF TRANSPORTATION
 FAP 330 US 12/45 (MANNHEIM RD.) OVER
 S00 LINE RR & FRANKLIN AVE.

ROADWAY PLAN
 STA. 170+50 TO STA. 184+00

SCALE: 1" = 50'
 DATE: JULY 8, 2009
 DRAWN BY: CJO
 CHECKED BY: PWK

L:\work\533346\cadd\drawings\Roadway\19r-dwg.dgn 10/1/2009