

F.A.P. RTE.	SECTION	COUNTY	TOTAL SHEETS	SHEET NO.
330	465 VB-R-1	COOK	103	15
STA.	TO STA.			
FED. ROAD DIST. NO.	ILLINOIS	FED. AID PROJECT		
CONTRACT NO. 60407				

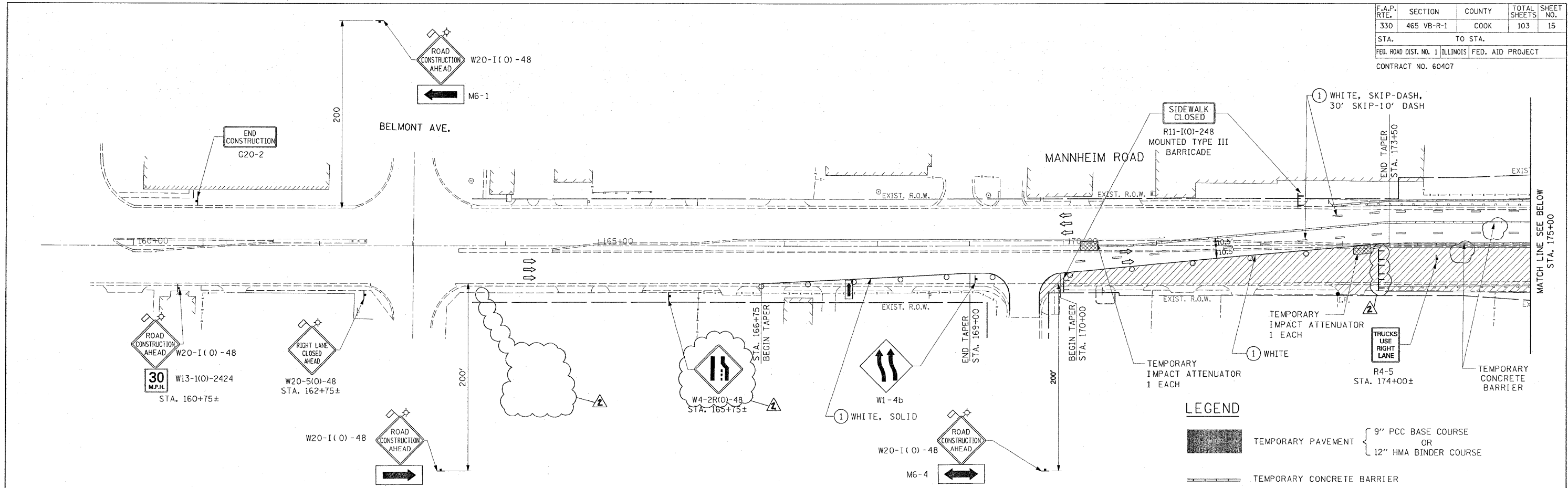

LEGEND

- TEMPORARY PAVEMENT { 9" PCC BASE COURSE OR 12" HMA BINDER COURSE }
- TEMPORARY CONCRETE BARRIER
- WORK ZONE
- DIRECTION OF TRAFFIC
- DRUM OR TYPE II PLASTIC BARRICADE WITH STEADY BURNING LIGHT, 50' C-C ON CURVE/TAPER 100' C-C ON TANGENT
- TRAFFIC SIGN
- PAVEMENT MARKING REMOVAL
- TYPE III BARRICADE
- TEMPORARY PAVEMENT MARKING-LINE 4"

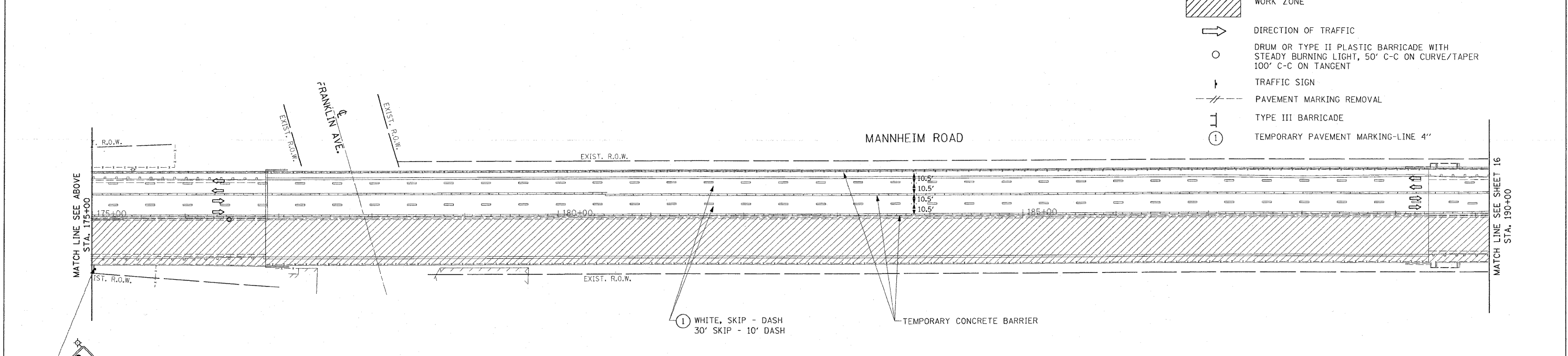

L:\WORK\63346\cadd\cra\manga\Roadway\15MOT1stg3.dgn 10/21/2009

W21-1a(0)
STA. 175+00±

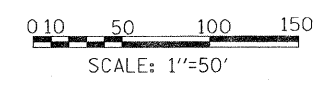

EARTH TECH | AECOM

REVISIONS	
NAME	DATE
ADDENDUM 2	10-19-09

MOT-8

ILLINOIS DEPARTMENT OF TRANSPORTATION
FAP 330 US 12/45 (MANNHEIM RD.) OVER
500 LINE RR & FRANKLIN AVE.

**MAINTENANCE OF TRAFFIC
STAGE III**

SCALE: 1"= 50'
DATE: JULY 8, 2009

DRAWN BY: CJO
CHECKED BY: PWK