

F.A.P. RTE.	SECTION	COUNTY	TOTAL SHEETS	SHEET NO.
330	465 VB-R-1	COOK	103	15
STA.		TO STA.		
FED. ROAD DIST. NO. 1		ILLINOIS FED. AID PROJECT		
CONTRACT NO. 60407				

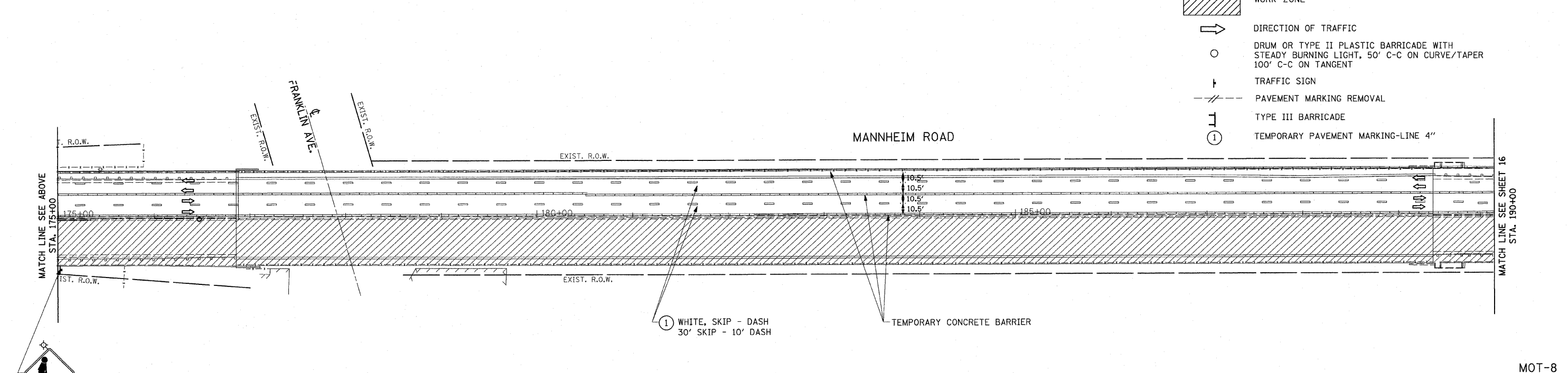
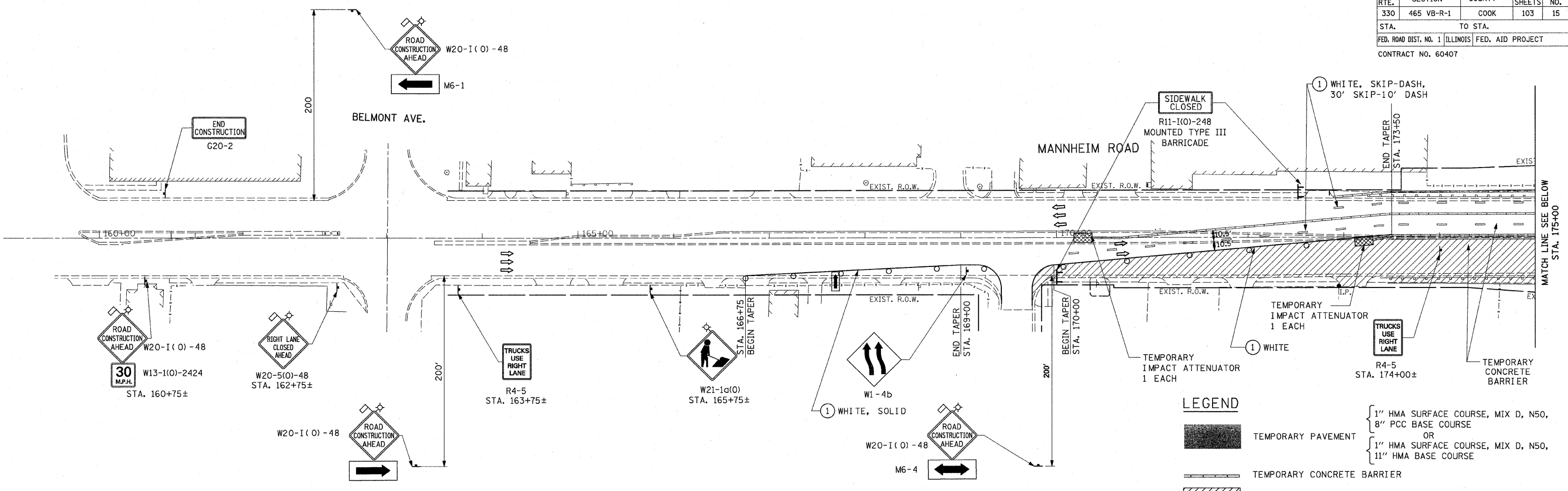

LEGEND

- 1" HMA SURFACE COURSE, MIX D, N50,
8" PCC BASE COURSE
OR
1" HMA SURFACE COURSE, MIX D, N50,
11" HMA BASE COURSE
- TEMPORARY PAVEMENT
- TEMPORARY CONCRETE BARRIER
- WORK ZONE
- DIRECTION OF TRAFFIC
- DRUM OR TYPE II PLASTIC BARRICADE WITH STEADY BURNING LIGHT, 50' C-C ON CURVE/TAPER 100' C-C ON TANGENT
- TRAFFIC SIGN
- PAVEMENT MARKING REMOVAL
- TYPE III BARRICADE
- TEMPORARY PAVEMENT MARKING-LINE 4"

L:\WORK\53346\cadd\drawings\Roadway\15MOT-stg3.dgn 7/8/2009

REVISIONS		ILLINOIS DEPARTMENT OF TRANSPORTATION FAP 330 US 12/45 (MANNHEIM RD.) OVER SOO LINE RR & FRANKLIN AVE. MAINTENANCE OF TRAFFIC STAGE III
NAME	DATE	

SCALE: 1"=50' DRAWN BY: CJO
DATE: JULY 8, 2009 CHECKED BY: PWK

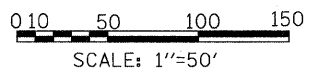

EARTH TECH | AECOM

MOT-8