

THE EXISTING INTERCONNECT CABLE SHALL BE DISCONNECTED AT THE EXISTING CONTROLLER LOCATED AT SCHOENBECK ROAD AND PALATINE ROAD AND PULLED BACK, COILED, AND STORED IN THIS HANDHOLE UNTIL NEEDED FOR PROPOSED INTERCONNECT WORK.

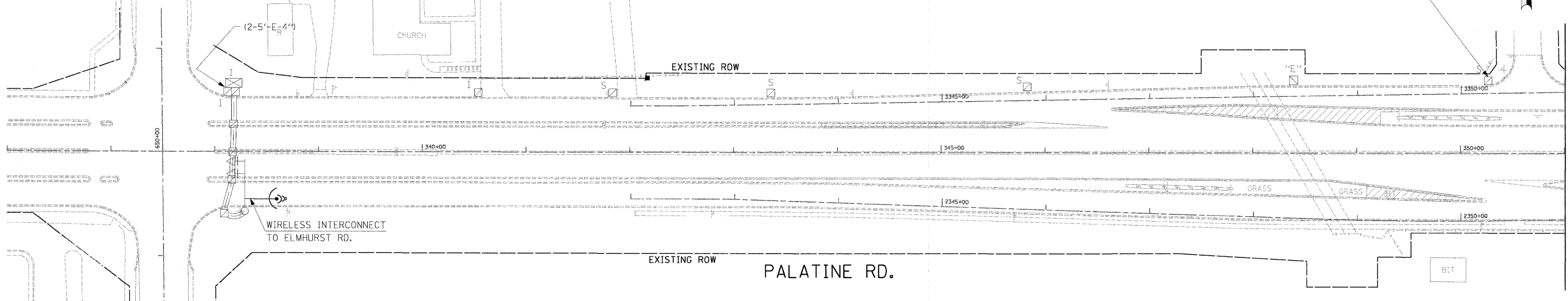

SCHOENBECK RD



MATCH LINE 351+00

MATCH LINE 351+00

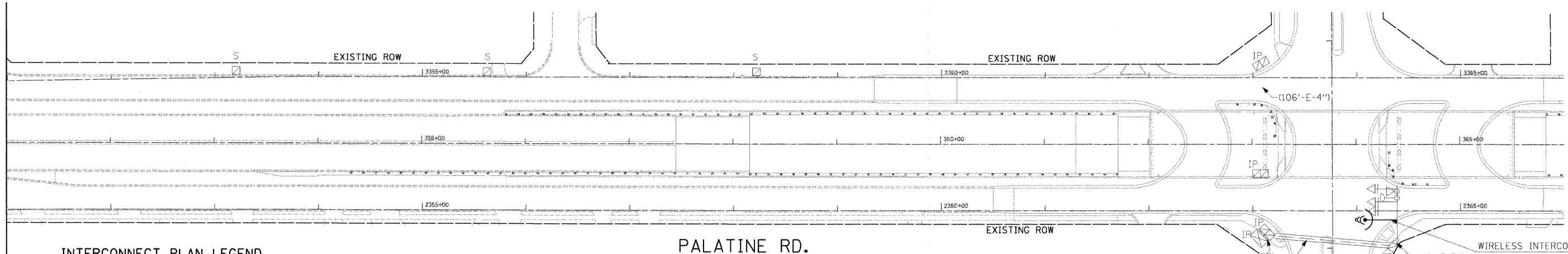

**INTERCONNECT PLAN LEGEND**

	PROPOSED	EXISTING		PROPOSED	EXISTING
CONTROLLER			DOUBLE HANDHOLE		
SERVICE INSTALLATION			GALVANIZED STEEL CONDUIT IN TRENCH OR PUSHED		
SIGNAL HEAD			PEDESTRIAN PUSHBUTTON DETECTOR		
SIGNAL HEAD WITH BACKPLATE			EMERGENCY VEHICLE SYSTEM DETECTOR		
SIGNAL HEAD, PEDESTRIAN			CONFIRMATION BEACON		
SIGNAL POST			SIGNAL HEAD, OPTICALLY PROGRAMMED		
MAST ARM ASSEMBLY AND POLE, STEEL			WIRELESS INTERCONNECT ANTENNA		
MAST ARM ASSEMBLY AND POLE, ALUMINUM					
COMBINATION MAST ARM ASSEMBLY AND POLE, STEEL WITH LUMINAIRE					
UNIT DUCT	UD				
COMMON TRENCH	CT				
HANDHOLE					
HEAVY DUTY HANDHOLE					

PALATINE RD.

ELMHURST RD.

**GO** GANDHI AND ASSOCIATES, INC.  
ENGINEERS AND PLANNERS  
6055 N. NORTHWEST HIGHWAY  
SUITE 306  
CHICAGO, ILLINOIS 60631 TEL: (773) 774-5910

FILE NAME =	USER NAME = #USER#	DESIGNED - PKG	REVISED -	<b>STATE OF ILLINOIS DEPARTMENT OF TRANSPORTATION</b>	TEMPORARY INTERCONNECT PLAN PALATINE ROAD SCHOENBECK ROAD TO ELMHURST RD.			F.A.P. RTE. 305	SECTION 0913.1-T	COUNTY COOK	TOTAL SHEETS 39	SHEET NO. 18J
#FILE#		DRAWN - MAA, SHM	REVISED -		SCALE: 1"= 50'	SHEET NO.	OF SHEETS	STA.	TO STA.	CONTRACT NO. 60E53		
		CHECKED - PKG	REVISED -		FED. ROAD DIST. NO. 1 [ILLINOIS] FED. AID PROJECT							
		DATE -	REVISED -									