

NOTES:

- NOTE 1: THE CONTRACTOR SHALL CONSTRUCT THE HANDHOLE IN SUCH A MANNER THAT IT WILL INTERCEPT THE EXISTING INTERCONNECT CONDUIT.
- NOTE 2: PRIOR TO REMOVAL OF THE INTERCONNECT CONDUIT IN THE CONSTRUCTION AREA OF THE PROPOSED BOX CULVERT, THE EXISTING INTERCONNECT CABLE SHALL BE DISCONNECTED AT THE EXISTING CONTROLLER AT THE INTERSECTION OF SCHOENBECK ROAD AND PALATINE ROAD, PULLED BACK, COILED, AND STORED IN THIS HANDHOLE UNTIL NEEDED FOR PROPOSED INTERCONNECT WORK.
- NOTE 3: WHERE THE PROPOSED 2" CONDUIT IS CROSSING THE PROPOSED BOX CULVERT, THE CONDUIT SHALL BE INSTALLED ON TOP OF THE PROPOSED BOX CULVERT AND SHALL BE PAID FOR AS "CONDUIT IN TRENCH" AND IS INCLUDED IN THE PAY ITEM. THE "TRENCH AND BACKFILL FOR ELECTRICAL WORK" IS NOT CONSIDERED FOR PAYMENT FOR THE PORTION OF THE PROPOSED 2" CONDUIT INSTALLED ON TOP OF THE BOX CULVERT.

SCHOENBECK RD

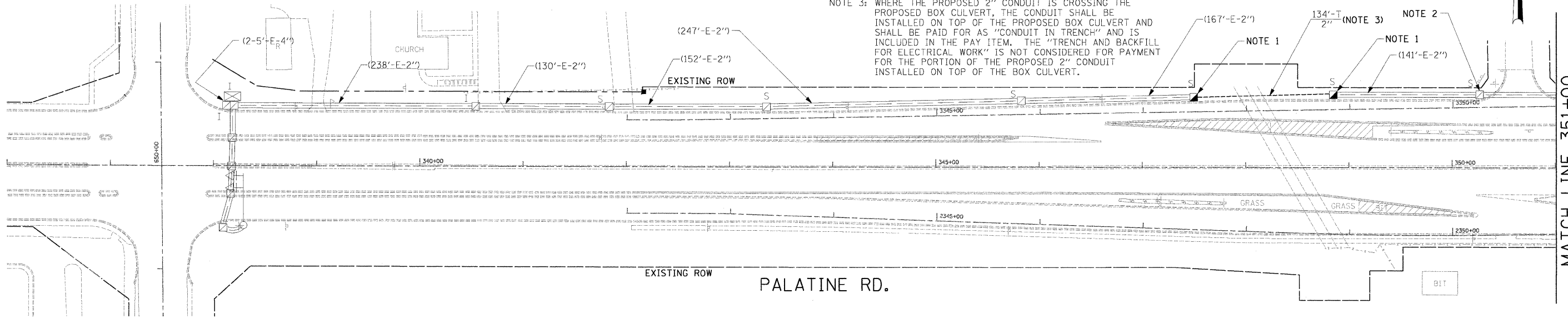

MATCH LINE 351+00

PALATINE RD.

MATCH LINE 351+00

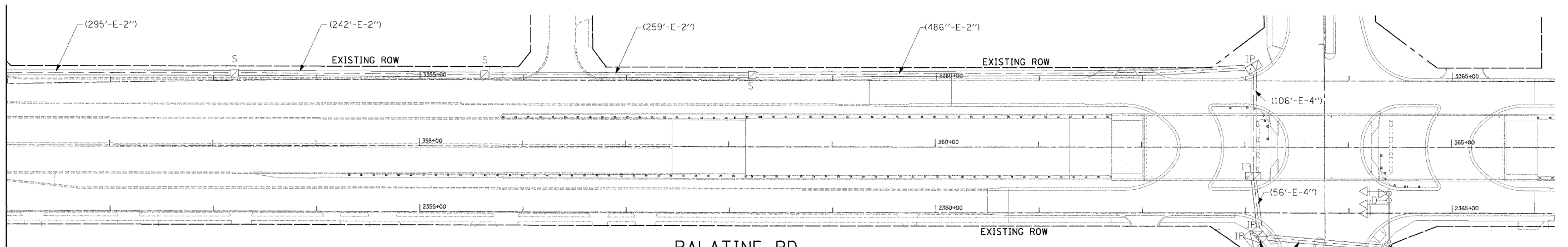

PALATINE RD.

ELMHURST RD.

INTERCONNECT PLAN LEGEND

	PROPOSED	EXISTING		PROPOSED	EXISTING
CONTROLLER			DOUBLE HANDHOLE		
SERVICE INSTALLATION			GALVANIZED STEEL CONDUIT IN TRENCH OR PUSHED		
SIGNAL HEAD			PEDESTRIAN PUSHBUTTON DETECTOR		
SIGNAL HEAD WITH BACKPLATE			EMERGENCY VEHICLE SYSTEM DETECTOR		
SIGNAL HEAD, PEDESTRIAN			CONFIRMATION BEACON		
SIGNAL POST			SIGNAL HEAD, OPTICALLY PROGRAMMED		
MAST ARM ASSEMBLY AND POLE, STEEL			WIRELESS INTERCONNECT ANTENNA		
MAST ARM ASSEMBLY AND POLE, ALUMINUM					
COMBINATION MAST ARM ASSEMBLY AND POLE, STEEL WITH LUMINAIRE					
UNIT DUCT	UD				
COMMON TRENCH	CT				
HANDHOLE					
HEAVY DUTY HANDHOLE					

FILE NAME =	USER NAME = #USER#	DESIGNED - PKG	REVISED -	STATE OF ILLINOIS DEPARTMENT OF TRANSPORTATION	INTERCONNECT PLAN PALATINE ROAD SCHOENBECK ROAD TO ELMHURST RD.			F.A.P. RTE. 305	SECTION 0913.1-T	COUNTY COOK	TOTAL SHEETS 39	SHEET NO. 18K
#FILE#	PLOT SCALE = #SCALE#	DRAWN - MAA, SHM	REVISED -		SCALE: 1" = 50'	SHEET NO.	OF SHEETS	STA.	TO STA.	CONTRACT NO. 60E53		
	PLOT DATE = #DATE#	CHECKED - PKG	REVISED -		FED. ROAD DIST. NO. 1 [ILLINOIS] FED. AID PROJECT							
		DATE -	REVISED -									

GA GANDHI AND ASSOCIATES, INC.
ENGINEERS AND PLANNERS
6035 N. NORTHWEST HIGHWAY
SUITE 306
CHICAGO, ILLINOIS 60631 TEL. (773) 774-5910