

STAGE 1

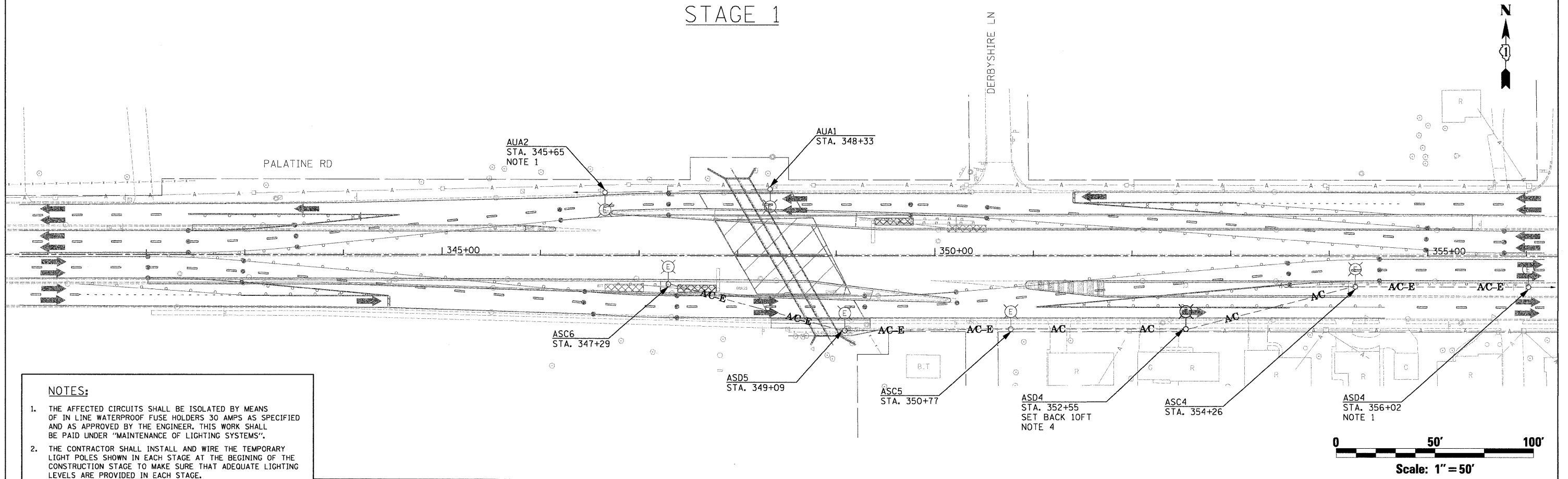

- NOTES:**
1. THE AFFECTED CIRCUITS SHALL BE ISOLATED BY MEANS OF IN LINE WATERPROOF FUSE HOLDERS 30 AMPS AS SPECIFIED AND AS APPROVED BY THE ENGINEER, THIS WORK SHALL BE PAID UNDER "MAINTENANCE OF LIGHTING SYSTEMS".
 2. THE CONTRACTOR SHALL INSTALL AND WIRE THE TEMPORARY LIGHT POLES SHOWN IN EACH STAGE AT THE BEGINING OF THE CONSTRUCTION STAGE TO MAKE SURE THAT ADEQUATE LIGHTING LEVELS ARE PROVIDED IN EACH STAGE.
 3. THE TEMPORARY AND/OR PROPOSED LIGHT POLES SHALL BE INSTALLED, AND MADE FULLY OPERATIONAL BEFORE ANY EXISTING LIGHT POLES ARE DISCONNECTED OR REMOVED.
 4. THIS LIGHTING UNIT WILL HAVE 40FT WOOD POLE, 30FT MH, 15FT MAST ARM, 200 WATT HPS LUMINAIRE, TYPE III, 240 VOLT PHASE TO NEUTRAL.
 5. THIS LIGHTING UNIT WILL HAVE 40FT WOOD POLE, 30FT MH, 15FT MAST ARM, 200 WATT HPS LUMINAIRE, TYPE III, 240 VOLT PHASE TO PHASE.

STAGE 2

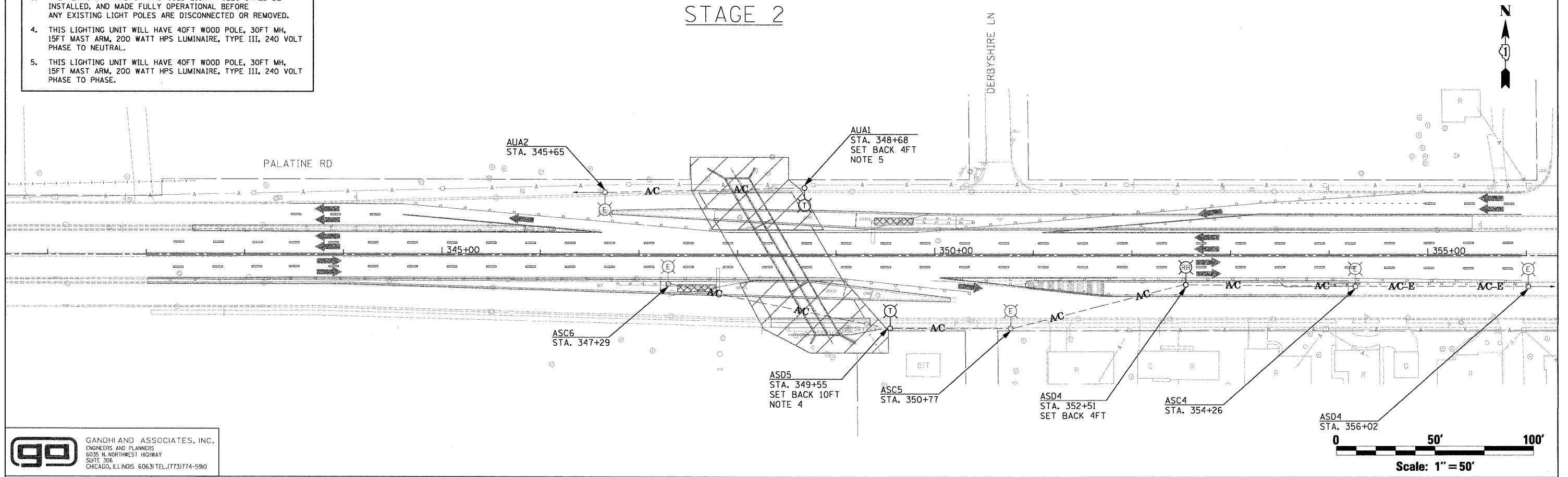

GA GANDHI AND ASSOCIATES, INC.
ENGINEERS AND PLANNERS
6035 N. NORTHWEST HIGHWAY
SUITE 306
CHICAGO, ILLINOIS 60631 TEL. (773) 774-5910

FILE NAME =	USER NAME = #USER#	DESIGNED - #DES	REVISED -
#FILE#		DRAWN - #DRAWN	REVISED -
	PLOT SCALE = #SCALE#	CHECKED - #CHKD	REVISED -
	PLOT DATE = #DATE#	DATE - #DATE	REVISED -

**STATE OF ILLINOIS
DEPARTMENT OF TRANSPORTATION**

**McDONALD CREEK CULVERT
TEMPORARY LIGHTING**

SCALE: SHEET NO. OF SHEETS STA. TO STA.

F.A.P. RTE.	SECTION	COUNTY	TOTAL SHEETS	SHEET NO.
305	0913.1-T	COOK	39	22
CONTRACT NO. 60E53				

FED. ROAD DIST. NO. 1 ILLINOIS FED. AID PROJECT