

EXISTING ROADWAY AND PAVEMENT MARKING PLAN

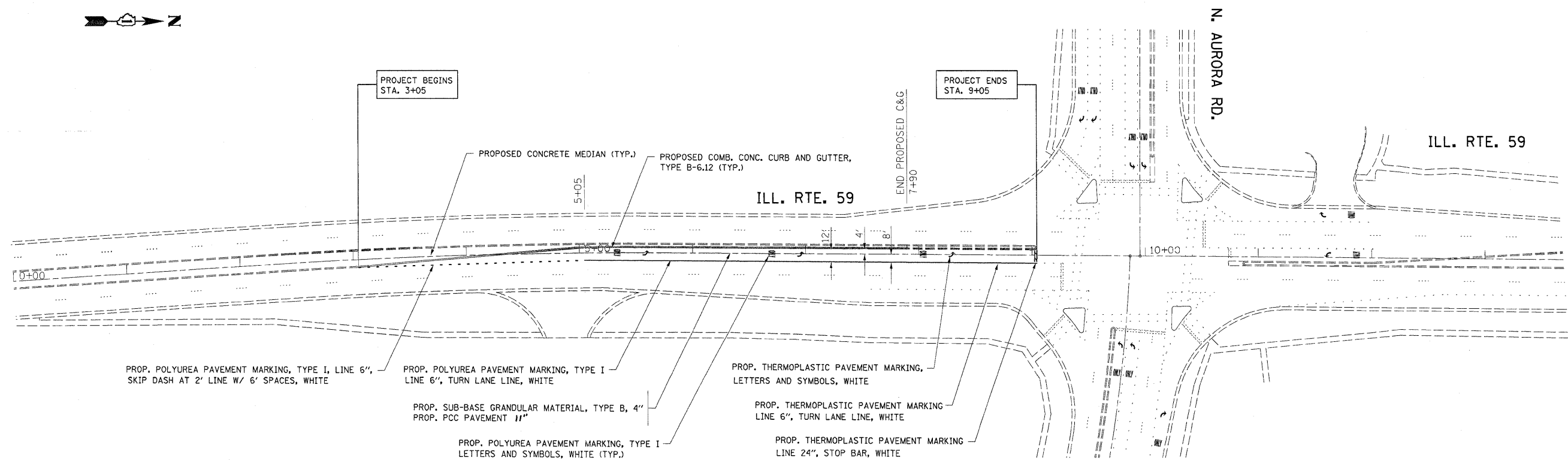

PROP. POLYUREA PAVEMENT MARKING, TYPE I, LINE 6",
SKIP DASH AT 2' LINE W/ 6' SPACES, WHITE

PROP. POLYUREA PAVEMENT MARKING, TYPE I
LINE 6", TURN LANE LINE, WHITE

PROP. SUB-BASE GRANULAR MATERIAL, TYPE B, 4"
PROP. PCC PAVEMENT 11"

PROP. POLYUREA PAVEMENT MARKING, TYPE I
LETTERS AND SYMBOLS, WHITE (TYP.)

PROP. THERMOPLASTIC PAVEMENT MARKING,
LETTERS AND SYMBOLS, WHITE

PROP. THERMOPLASTIC PAVEMENT MARKING
LINE 6", TURN LANE LINE, WHITE

PROP. THERMOPLASTIC PAVEMENT MARKING
LINE 24", STOP BAR, WHITE

PROPOSED ROADWAY AND PAVEMENT MARKING PLAN

FILE NAME =	USER NAME = shiranisb	DESIGNED -	REVISED -	STATE OF ILLINOIS DEPARTMENT OF TRANSPORTATION	EXISTING AND PROPOSED ROADWAY AND PAVEMENT MARKING PLANS IL 59 AT N AURORA ROAD				F.A.P. RTE.	SECTION	COUNTY	TOTAL SHEETS	SHEET NO.
ct:\pw_work\PMIDOT\SHIRANISB\0147522\016209-shr-plan.dgn	PLOT SCALE = 50.0000' / IN.	DRAWN -	REVISED -						338	112 N-3	DUPAGE	12	5
PLOT DATE = 8/20/2009	DATE -	CHECKED -	REVISED -		SCALE: SHEET NO. OF SHEETS STA. TO STA.				CONTRACT NO. 60118				
					ILLINOIS FED. AID PROJECT								