

REF-EDRS  
REF-PDRS

F.A.P. RTE.	SECTION	COUNTY	TOTAL SHEETS	SHEET NO.
332/876	2002-113R	WILL	242	78
STA. 60+295		TO STA. 60+625		
FED. ROAD DIST. NO. 1		ILLINOIS FED. AID PROJECT		

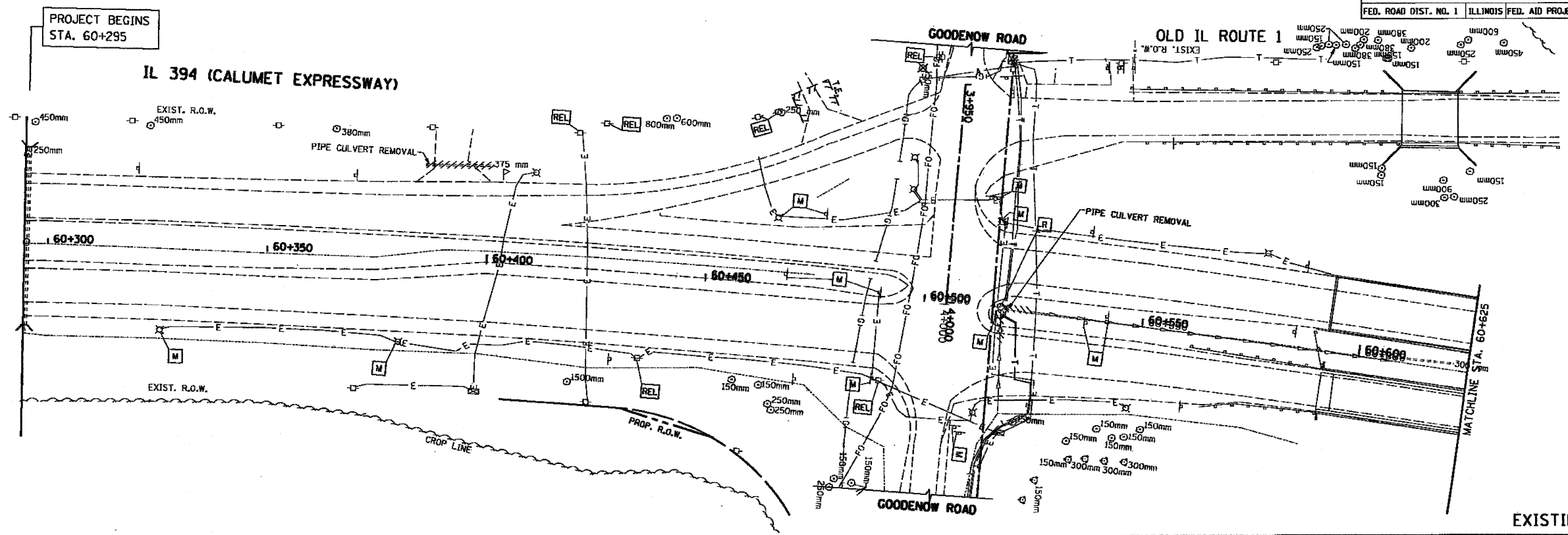

EXISTING  
PROPOSED

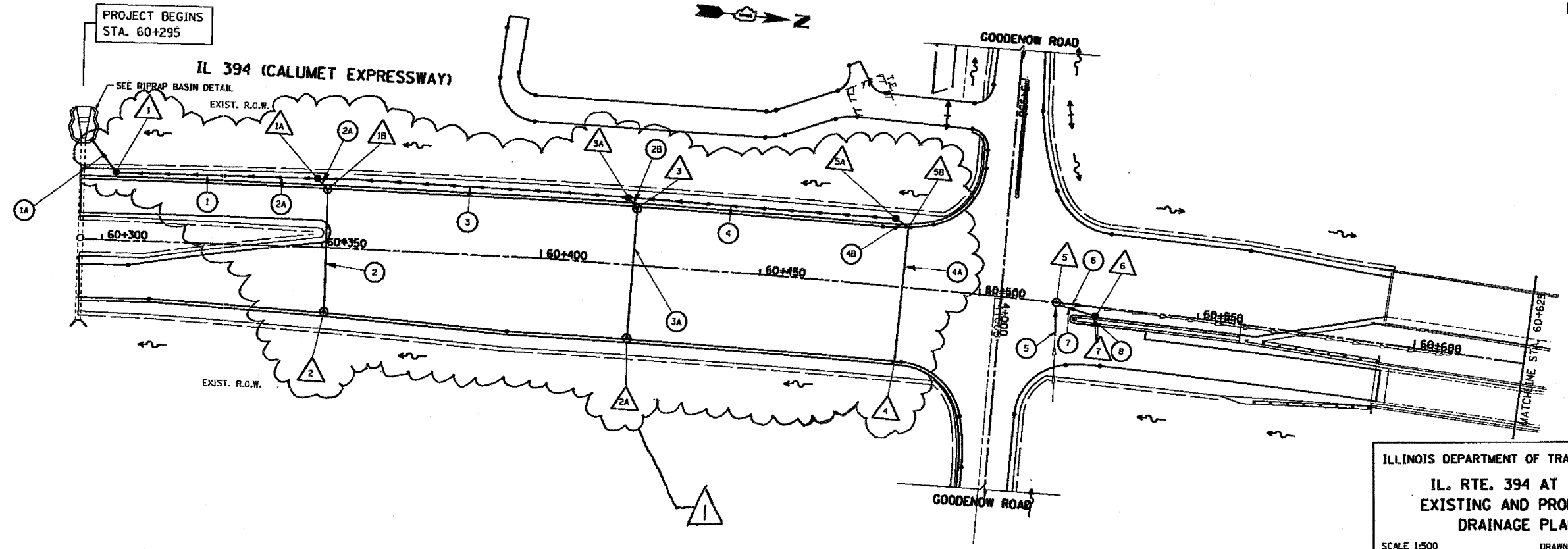

ILLINOIS DEPARTMENT OF TRANSPORTATION  
**IL. RTE. 394 AT IL. 1  
 EXISTING AND PROPOSED  
 DRAINAGE PLAN**  
 SCALE 1:500  
 DATE 10/28/2009  
 DRAWN BY  
 CHECKED BY

REVISION  $\Delta$  10/28/09 SHB

10/28/2009  
 c:\pw\work\pwwork\BYUNSH\1010364\typicals.dgn  
 byunsh