

REF-TOPO
REF-240

F.A.P. RTE.	SECTION	COUNTY	TOTAL SHEETS	SHEET NO.
332/876	2002-113R	WILL	242	119A
STA. 59+950		TO STA. 60+295		
FED. ROAD DIST. NO. 1		ILLINOIS FED. AID PROJECT		

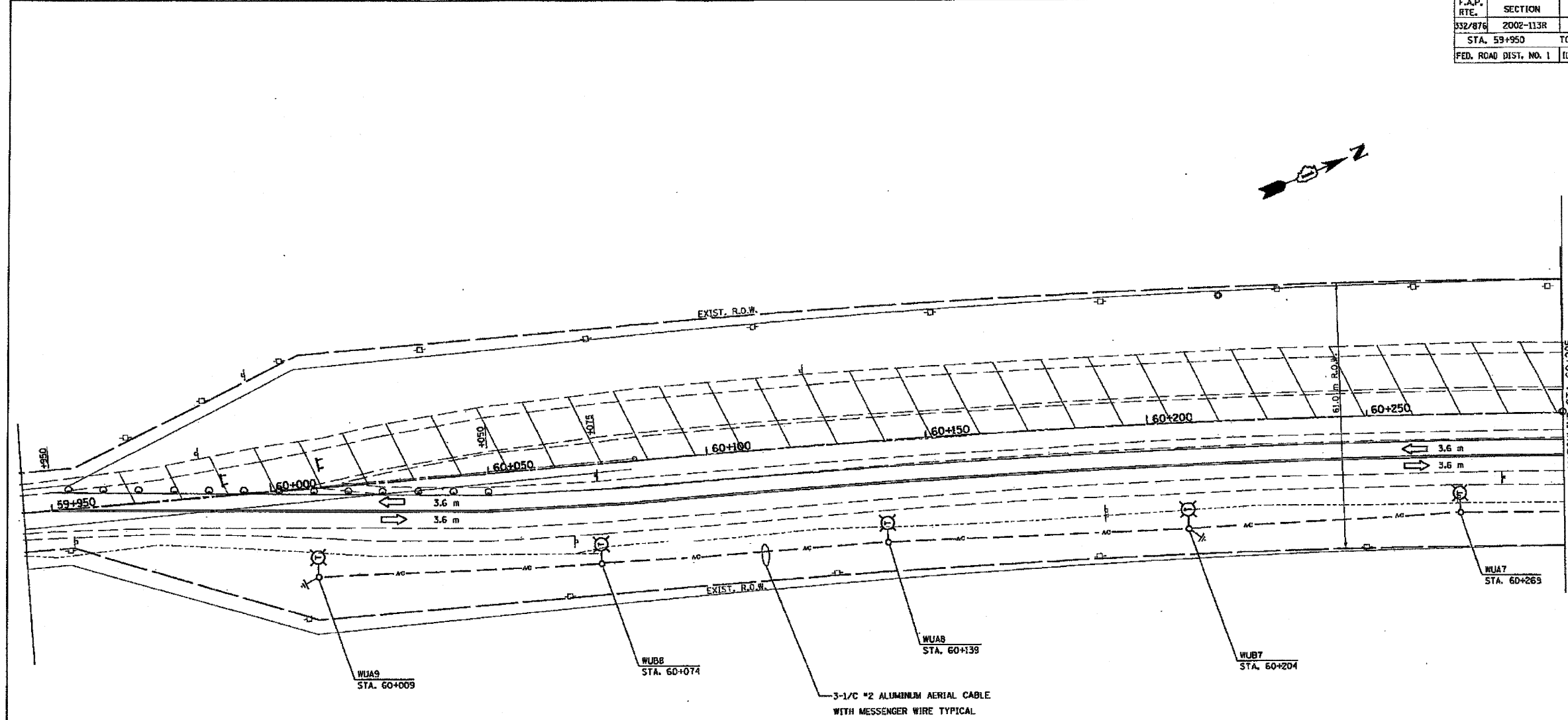

- NOTES:**
1. ALL TEMPORARY LIGHT POLES SHALL HAVE A MINIMUM SETBACK OF 9M FROM EDGE OF TRAVELED PAVEMENT UNLESS NOTED OTHERWISE.
 2. INSTALL AND ENERGIZE TEMPORARY LIGHTING SYSTEM PRIOR TO CLOSURE OF SOUTH BOUND LANES. TEMPORARY LIGHTING MUST BE OPERATIONAL BEFORE EXISTING LIGHTING IS REMOVED.

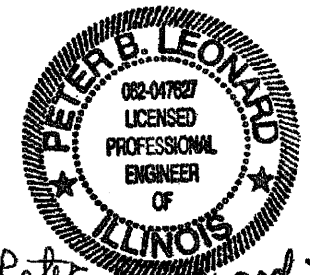

Peter B. Leonard 7/19/09
Exp. 11/30/09

HOH ASSOCIATES, INC.
2660.05
HOH CAD FILE No. ES.DGN
PLOT SCALE 1 = 1

REVISIONS	
NAME	DATE

ILLINOIS DEPARTMENT OF TRANSPORTATION
IL. RTE. 394 AT GOODENOW
STAGE 2
LIGHTING PLAN
SCALE 1:500
DATE 12-1-2005
DRAWN BY MEK
CHECKED BY RER

E5

DATE-TIME
DGN-SPEC
USER