

F.A.P. RTE.	SECTION	COUNTY	TOTAL SHEETS	SHEET NO.
332/876	2002-113R	WILL	242	32
STA. 60+295 TO STA. 60+650				
FED. ROAD DIST. NO. 1			ILLINOIS FED. AID PROJECT	

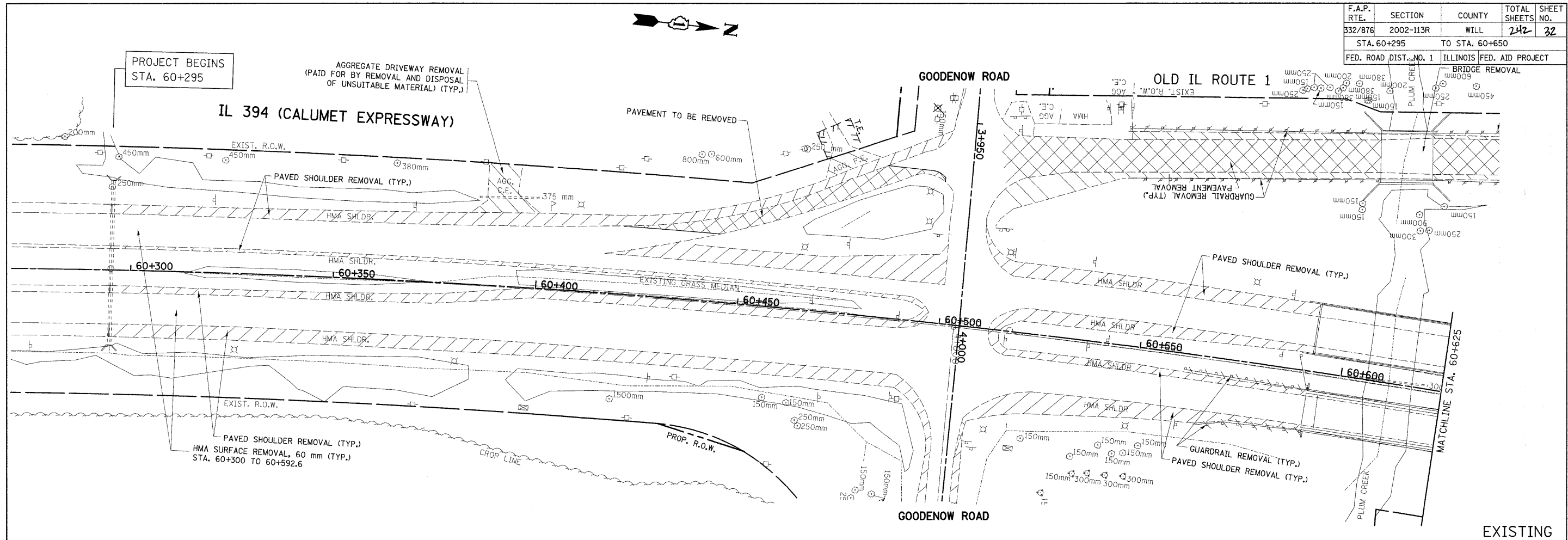

EXISTING

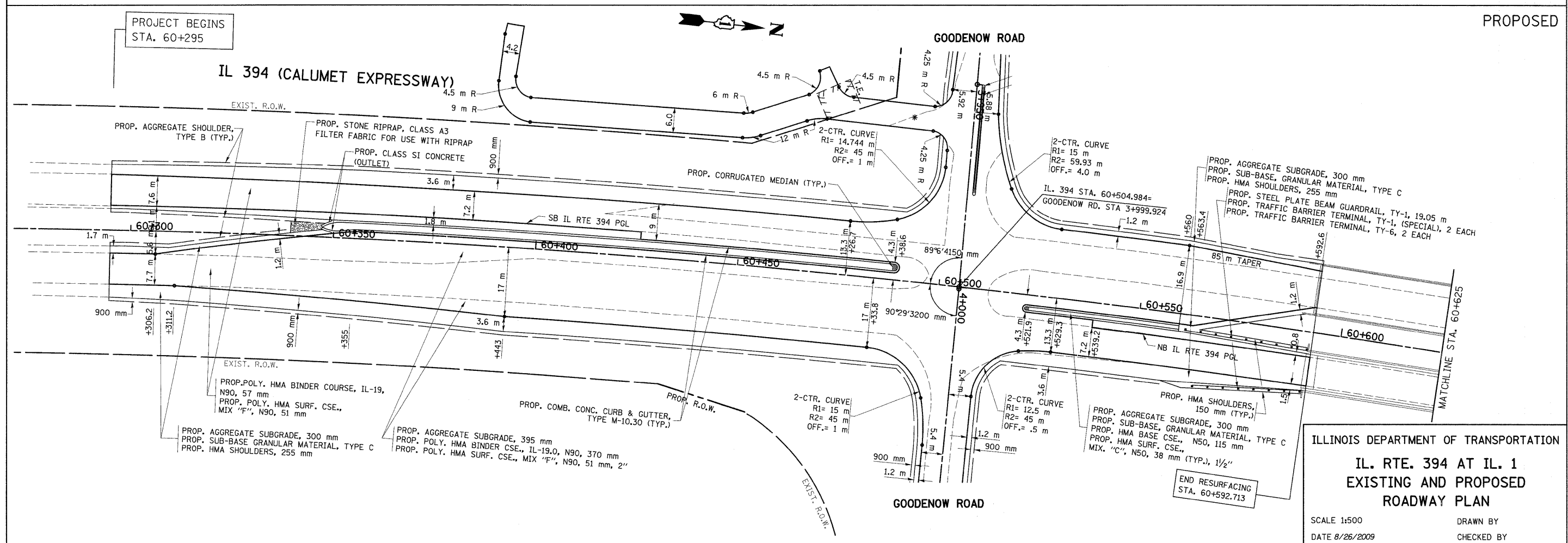

PROPOSED

ILLINOIS DEPARTMENT OF TRANSPORTATION
IL. RTE. 394 AT IL. 1
EXISTING AND PROPOSED
ROADWAY PLAN

SCALE 1:500
 DATE 8/26/2009
 DRAWN BY
 CHECKED BY