

| | | | | |
|-----------------------|----------------|---------------------------|--------------|-----------|
| F.A.P. RTE. | SECTION | COUNTY | TOTAL SHEETS | SHEET NO. |
| 332/876 | 2002-113R | WILL | 242 | 47 |
| STA. 60+300 | TO STA. 61+650 | | | |
| FED. ROAD DIST. NO. 1 | | ILLINOIS FED. AID PROJECT | | |

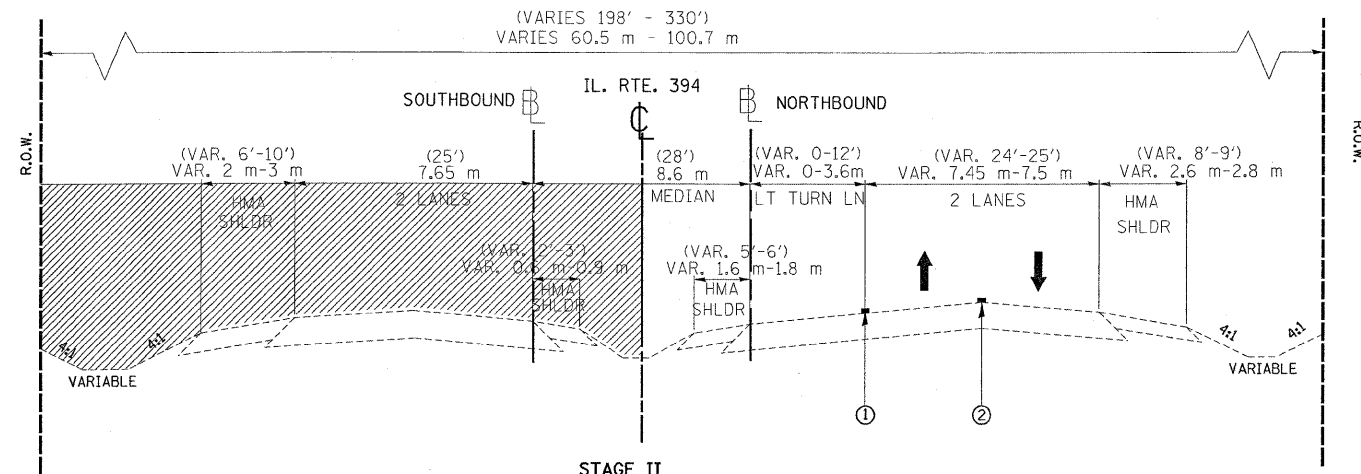

STAGE II
PROPOSED TYPICAL CROSS SECTION
ILL. RTE. 394
STA. 60+295 TO STA. 60+490

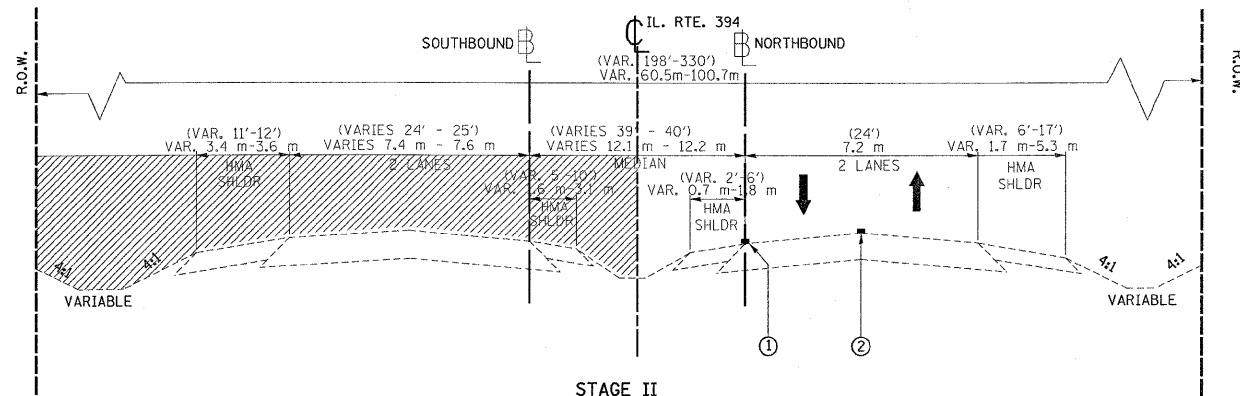

STAGE II
PROPOSED TYPICAL CROSS SECTION
ILL. RTE. 394
STA. 60+490 TO STA. 60+580

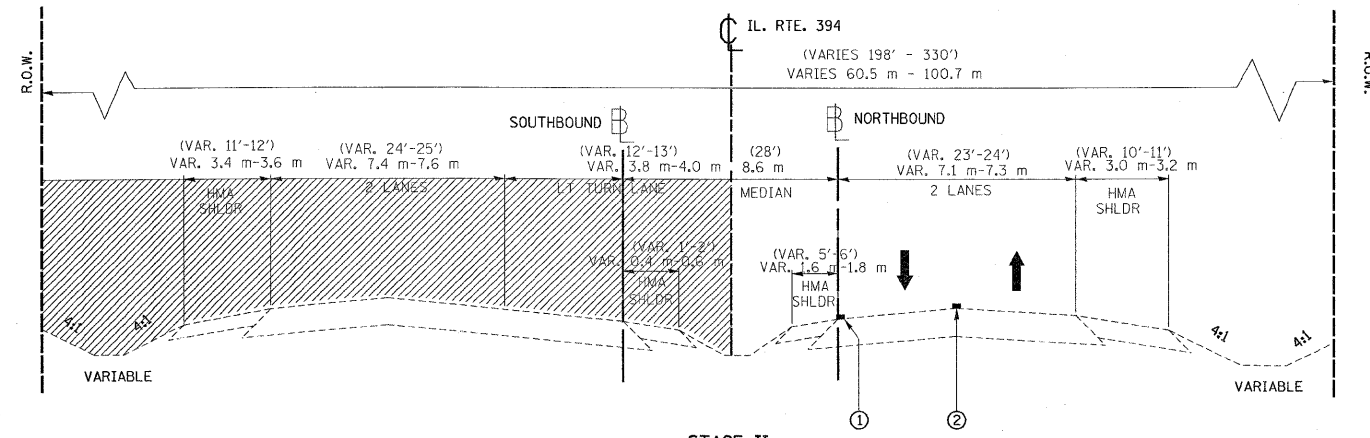

STAGE II
PROPOSED TYPICAL CROSS SECTION
ILL. RTE. 394
STA. 60+580 TO STA. 61+650

SUGGESTED STAGE CONSTRUCTION:

- A) INCLUDES THE RECONSTRUCTION AND RESURFACING OF THE SOUTHBOUND LANES OF ILL. RTE. 394. CONSTRUCTION ELEMENTS WILL INCLUDE RECONSTRUCTION OF THE WEST SIDE OF ILL. RTE. 394 AT ITS INTERSECTION WITH REALIGNED ILL. RTE. 1 FROM STA. 61+215.794 TO STA. 61+650, RECONSTRUCTION OF THE WEST SIDE OF ILL. RTE. 394 AT ITS INTERSECTION WITH GOODENOW RD. FROM APPROXIMATELY STA. 60+300 TO STA. 60+592.713, AND RESURFACING OF THE WEST SIDE OF ILL. RTE. 394 FROM STA. 60+630.631 TO STA. 61+215.794
- B) TWO-WAY TRAFFIC WILL BE SHIFTED TO THE NORTHBOUND LANES, THE SOUTHBOUND LANES WILL BE CLOSED FROM STA. 60+300 TO STA. 61+650. TRAFFIC WILL CROSS-OVER TO THE NORTHBOUND LANES JUST NORTH OF THE PROPOSED ILL. RTE. 394 AND REALIGNED ILL. RTE. 1 INTERSECTION. THE CROSSOVER NORTH OF ILL. RTE. 394 AND ILL. RTE. 1 IS TO BE BUILT ON THIS STAGE. TRAFFIC WILL CROSS-OVER BACK TO THE SOUTHBOUND LANES SOUTH OF GOODENOW RD WHERE ILL. RTE. 394 MERGES BOTH SOUTHBOUND AND NORTHBOUND LANES. THE SOUTHBOUND THROUGH TRAFFIC ON ILL. RTE. 1 WILL BE DIRECTED TO ILL. RTE. 394 VIA GOODENOW RD. PAGE # SHOWS THE WORK ZONE AND TRAFFIC FLOW FOR STAGE II.

LEGEND:

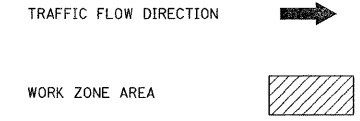

LEGEND:

- ① TEMPORARY PAVEMENT MARKING, WHITE EDGE LINE, 100 mm
- ② TEMPORARY PAVEMENT MARKING, DOUBLE YELLOW, 100 mm

| REVISIONS | |
|-----------|------|
| NAME | DATE |
| | |
| | |
| | |
| | |
| | |
| | |
| | |

ILLINOIS DEPARTMENT OF TRANSPORTATION
SUGGESTED MAINTENANCE.
OF TRAFFIC
ILL. RTE. 394
STAGE II

SCALE: NONE
DATE: **DATE**

DRAWN BY
CHECKED BY