

IL 394 (CALUMET EXPRESSWAY)

F.A.P. RTE.	SECTION	COUNTY	TOTAL SHEETS	SHEET NO.
332/876	2002-113R	WILL	247	50
STA. 60+975		TO STA. 61+650		
FED. ROAD DIST. NO. 1		ILLINOIS FED. AID PROJECT		

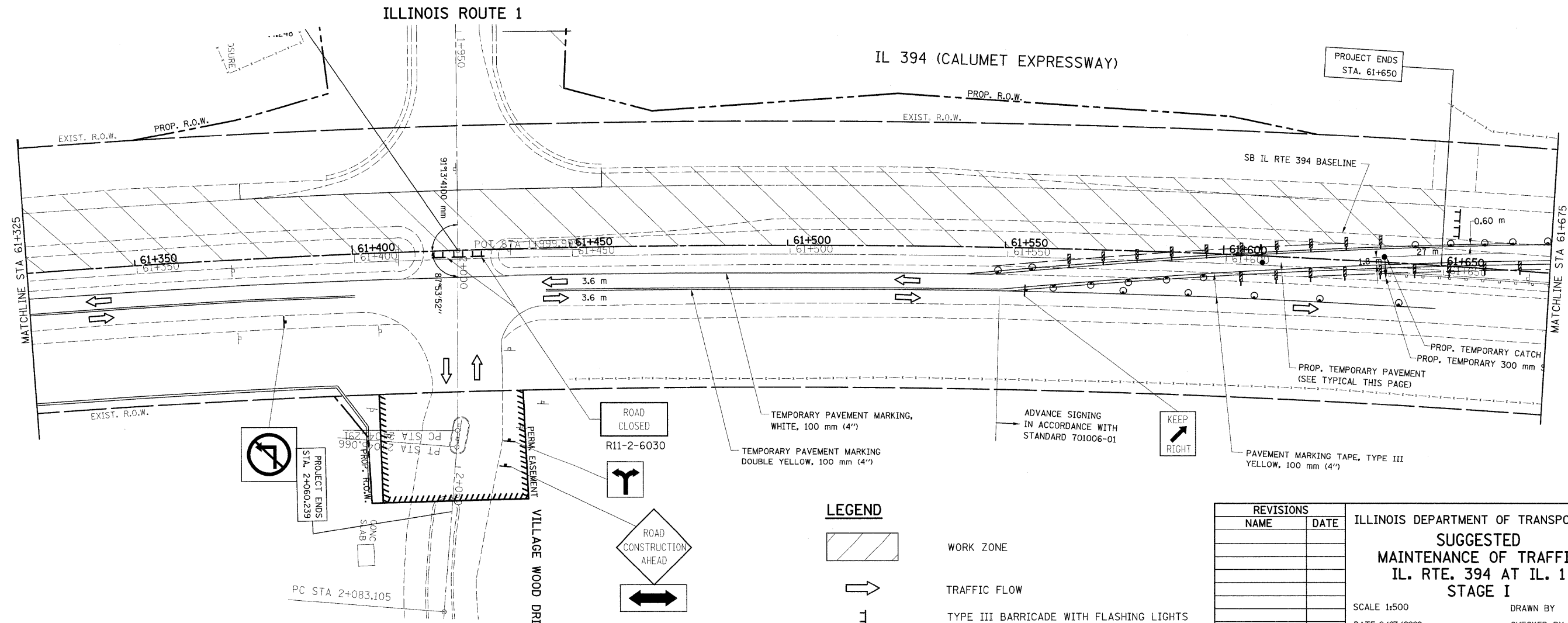
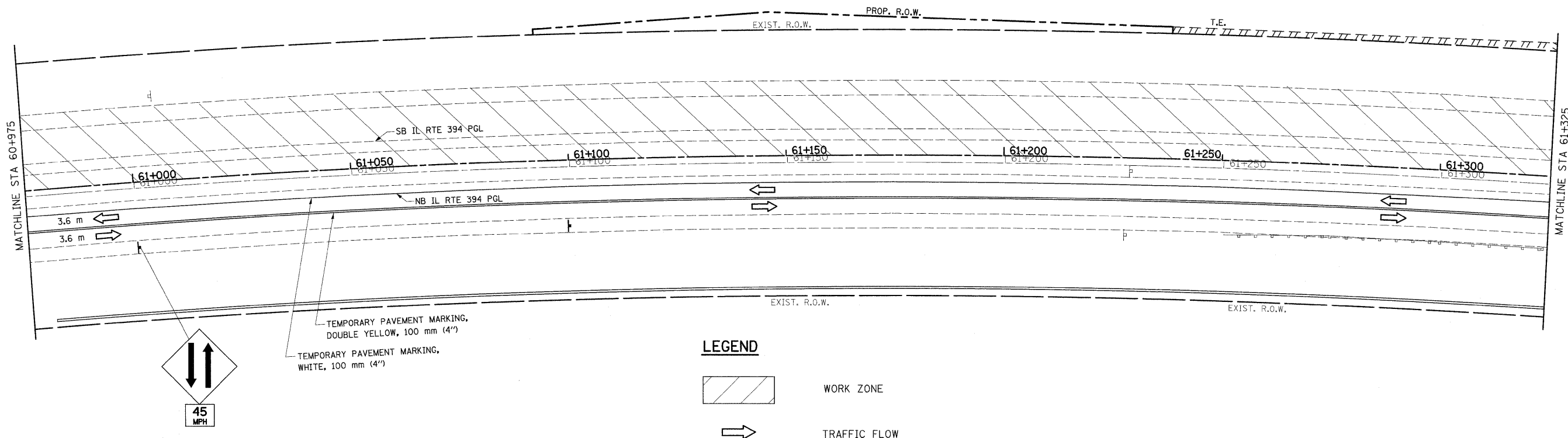

REVISIONS	
NAME	DATE

ILLINOIS DEPARTMENT OF TRANSPORTATION
SUGGESTED MAINTENANCE OF TRAFFIC
IL. RTE. 394 AT IL. 1
STAGE I
SCALE 1:500
DATE 8/27/2009
DRAWN BY
CHECKED BY