

PLAN	SURVEYED	BY	DATE
NOTE BOOK NO.	ALIGNMENT CHECKED		
	RT. OF WAY CHECKED		
	ROAD FILE NAME		

PROFILE	SURVEYED	BY	DATE
NOTE BOOK NO.	GRADES CHECKED		
	B.M. NOTED		
	STRUCTURE NOTATIONS CHECKED		

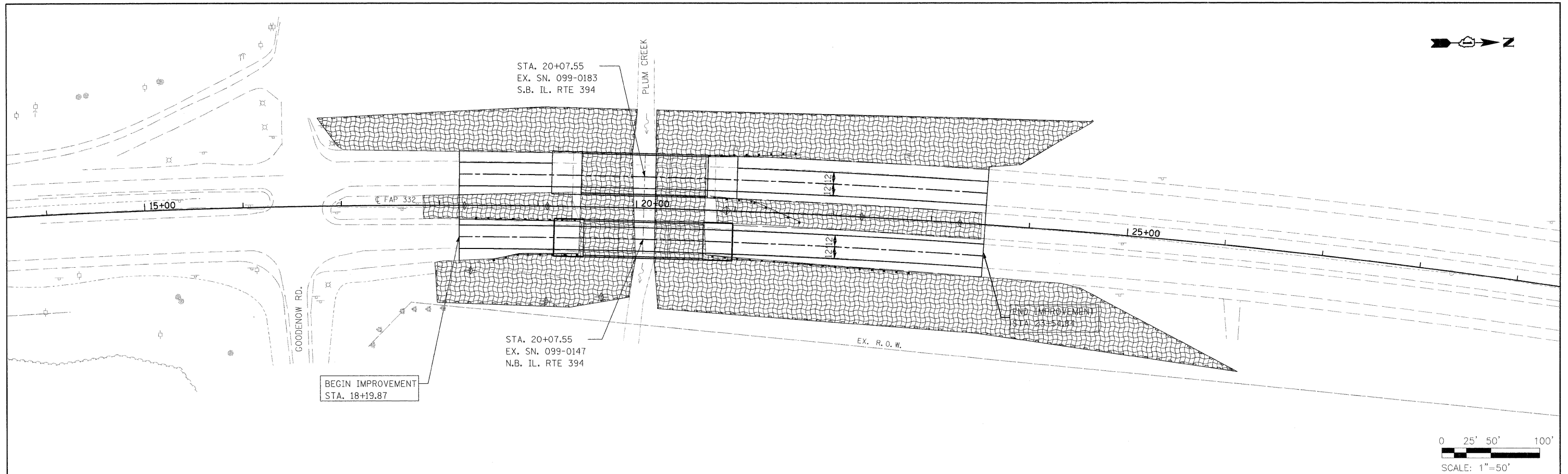

IL RTE 394 EROSION CONTROL PLAN

LEGEND:

- TEMPORARY DITCH CHECK
- INLET AND PIPE PROTECTION
- PERIMETER EROSION BARRIER
- EROSION CONTROL BLANKET AND PERMANENT SEEDING
- CLASS 3 (TEMPORARY EROSION CONTROL SEEDING AS NEEDED)

NOTES:

1. THE CONTRACTOR SHALL PREVENT DEBRIS FROM FALLING INTO PLUM CREEK DURING THE REMOVAL OF THE EXISTING BRIDGE. THIS WORK IS INCLUDED IN THE PAY ITEM FOR REMOVAL OF THE EXISTING STRUCTURE AND WILL NOT BE PAID FOR SEPERATELY, BUT IS CONSIDERED INCLUDED IN OTHER CONTRACT ITEMS.
2. ALL EROSION CONTROL ITEMS TO BE FURNISHED AND MAINTAINED BY THE CONTRACTOR FOR THE ENTIRE DURATION OF THE PROJECT, AS DIRECTED BY THE ENGINEER.

FILE NAME =	USER NAME = #USER#	DESIGNED DB	REVISED -	<b>STATE OF ILLINOIS DEPARTMENT OF TRANSPORTATION</b>	<b>IL RTE 394 OVER PLUM CREEK EROSION CONTROL PLAN</b>		F.A.P. RTE.	SECTION	COUNTY	TOTAL SHEETS	SHEET NO.	
#FILE#		DRAWN NS/RM	REVISED -		332	2002-113R	WILL	242	66	CONTRACT NO. 62542		
		CHECKED AS	REVISED -		SCALE: 1"=50'		SHEET NO. 1 OF SHEETS		STA.	TO STA.	FED. ROAD DIST. NO. 1 ILLINOIS FED. AID PROJECT	
		DATE MARCH 2009	REVISED -									