

RESTORATION OF WORK AREA, RESTORATION OF TRAFFIC SIGNAL WORK AREA SHALL BE INCIDENTAL TO THE RELATED PAY ITEM SUCH AS FOUNDATION, CONDUIT, HANDHOLE, TRENCH AND BACKFILL, ETC., AND NO EXTRA COMPENSATION SHALL BE ALLOWED. ALL ROADWAY SURFACES SUCH AS SHOULDERS, MEDIANS, SIDEWALKS, PAVEMENT, ETC. SHALL BE REPLACED IN KIND. ALL DAMAGE TO MOWED LAWNS SHALL BE REPLACED WITH AN APPROVED SOG, AND ALL DAMAGE TO UNMOWED FIELDS SHALL BE SEEDING IN ACCORDANCE WITH STANDARD SPECIFICATIONS 252 AND 250 RESPECTIVELY.

**GENERAL NOTES FOR TEMPORARY RED FLASHER SIGNALS**

1. ALL EQUIPMENT FOR THE RED FLASHER SIGNALS, INCLUDING SUPPLEMENTAL STOP SIGNS AND ADVANCE WARNING SIGNS, SHALL BE FURNISHED BY THE CONTRACTOR. STOP SIGNS, ADVANCE WARNING SIGN FACES (AND SUPPLEMENTAL PLAQUES) AND WOOD SUPPORT POSTS SHALL BE OF ALL NEW (UNUSED) MATERIAL AND CONFORM TO IDOT FABRICATION AND INSTALLATION STANDARDS.
2. THE CONTROLLER USED FOR RED FLASHER SIGNAL OPERATION SHALL BE NEMA MICROPROCESSOR BASED.
3. ALL FLASHING RED SIGNAL SECTIONS SHALL BE 12" (300 mm). HEADS SHALL BE PLACED AS INDICATED ON THE TEMPORARY TRAFFIC SIGNAL PLAN OR AS DIRECTED BY THE ENGINEER. THE CONTRACTOR SHALL FURNISH ENOUGH SLACK TO RELOCATE HEADS TO ANY POSITION ON THE SPAN WIRE OR AT LOCATIONS ILLUSTRATED ON THE PLANS FOR CONSTRUCTION STAGING. THE TEMPORARY RED FLASHER SIGNALS SHALL REMAIN IN OPERATION DURING ALL SIGNAL HEAD RELOCATIONS. EACH TEMPORARY RED FLASHER SIGNAL HEAD SHALL HAVE ITS OWN CABLE FROM THE CONTROLLER CABINET TO THE SIGNAL HEAD.
4. FLASHING RED SIGNAL HEADS SHALL BE SECURED TO BOTH THE SPAN WIRE AND TETHER WIRE IN ACCORDANCE WITH IDOT STANDARD 880001 ("SPAN WIRE MOUNTED SIGNALS AND FLASHING BEACON INSTALLATION").
5. ALL EXISTING STREET NAME AND INTERSECTION REGULATORY SIGNS SHALL BE REMOVED FROM EXISTING POLES, RELOCATED AND SECURELY FASTENED TO THE SIGNAL SPAN WIRE OR WOOD POLE AS DIRECTED BY THE ENGINEER.
6. THE EXISTING STOP SIGNS AND FLASHING BEACONS SHALL REMAIN IN PLACE AND OPERATIONAL UNTIL THE TEMPORARY RED FLASHER SIGNALS ARE ACTIVATED.

F.A.P. RTE.	SECTION	COUNTY	TOTAL SHEETS	SHEET NO.
332/876	2002-113R	WILL	242	100
STA. _____		TO STA. _____		
FED. ROAD DIST. NO. _____		ILLINOIS FED. AID PROJECT		
CONTRACT NO. 62542				

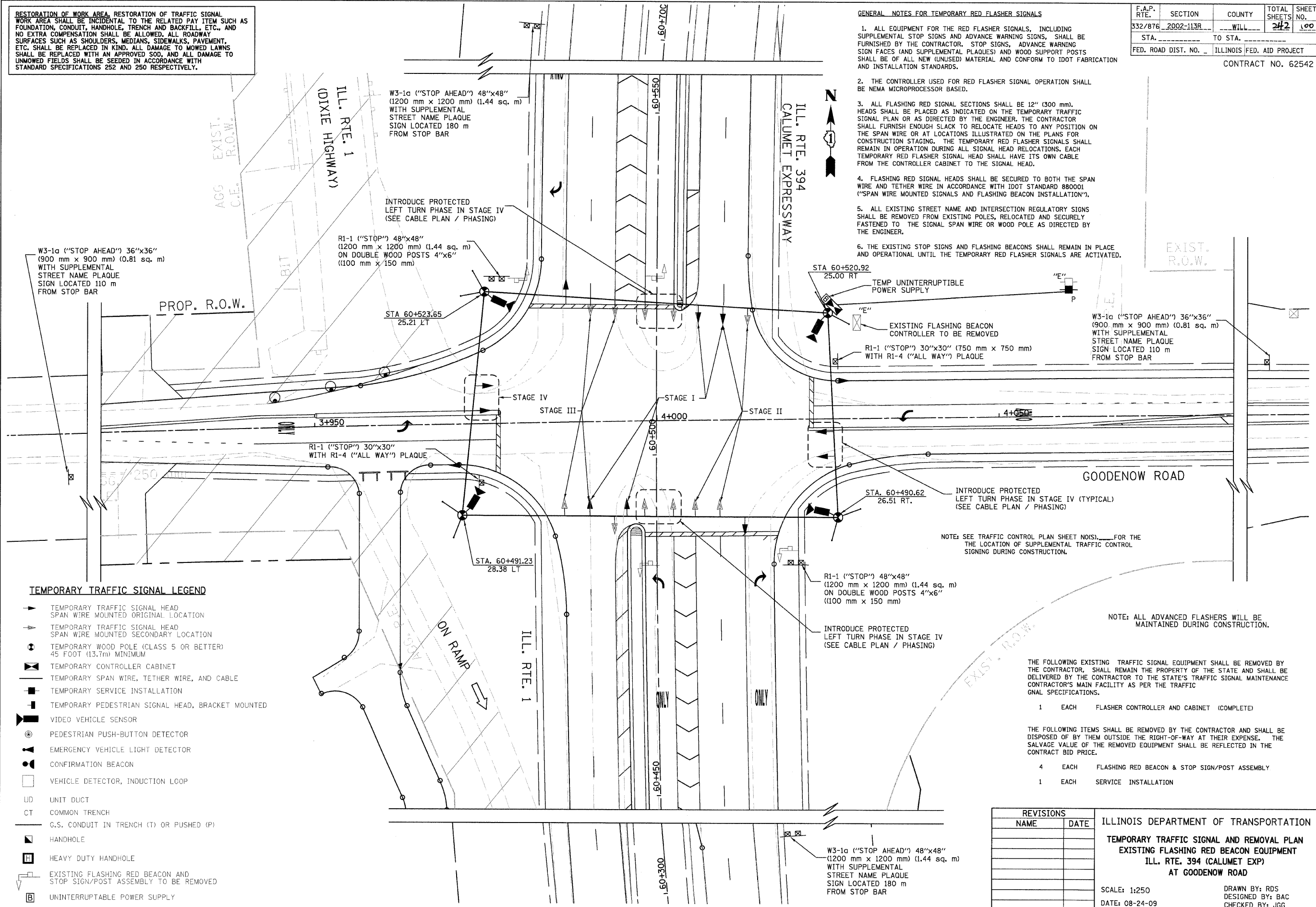

**TEMPORARY TRAFFIC SIGNAL LEGEND**

- ▶ TEMPORARY TRAFFIC SIGNAL HEAD SPAN WIRE MOUNTED ORIGINAL LOCATION
- ◀ TEMPORARY TRAFFIC SIGNAL HEAD SPAN WIRE MOUNTED SECONDARY LOCATION
- ⊙ TEMPORARY WOOD POLE (CLASS 5 OR BETTER) 45 FOOT (13.7m) MINIMUM
- ⊞ TEMPORARY CONTROLLER CABINET
- TEMPORARY SPAN WIRE, TETHER WIRE, AND CABLE
- TEMPORARY SERVICE INSTALLATION
- ⊞ TEMPORARY PEDESTRIAN SIGNAL HEAD, BRACKET MOUNTED
- ⊞ VIDEO VEHICLE SENSOR
- ⊙ PEDESTRIAN PUSH-BUTTON DETECTOR
- ▶ EMERGENCY VEHICLE LIGHT DETECTOR
- ⊙ CONFIRMATION BEACON
- VEHICLE DETECTOR, INDUCTION LOOP
- UD UNIT DUCT
- CT COMMON TRENCH
- G.S. CONDUIT IN TRENCH (T) OR PUSHED (P)
- ⊞ HANDHOLE
- ⊞ HEAVY DUTY HANDHOLE
- ⊞ EXISTING FLASHING RED BEACON AND STOP SIGN/POST ASSEMBLY TO BE REMOVED
- ⊞ UNINTERRUPTIBLE POWER SUPPLY

THE FOLLOWING EXISTING TRAFFIC SIGNAL EQUIPMENT SHALL BE REMOVED BY THE CONTRACTOR, SHALL REMAIN THE PROPERTY OF THE STATE AND SHALL BE DELIVERED BY THE CONTRACTOR TO THE STATE'S TRAFFIC SIGNAL MAINTENANCE CONTRACTOR'S MAIN FACILITY AS PER THE TRAFFIC SIGNAL SPECIFICATIONS.

- 1 EACH FLASHER CONTROLLER AND CABINET (COMPLETED)

THE FOLLOWING ITEMS SHALL BE REMOVED BY THE CONTRACTOR AND SHALL BE DISPOSED OF BY THEM OUTSIDE THE RIGHT-OF-WAY AT THEIR EXPENSE. THE SALVAGE VALUE OF THE REMOVED EQUIPMENT SHALL BE REFLECTED IN THE CONTRACT BID PRICE.

- 4 EACH FLASHING RED BEACON & STOP SIGN/POST ASSEMBLY
- 1 EACH SERVICE INSTALLATION

ILLINOIS DEPARTMENT OF TRANSPORTATION  
**TEMPORARY TRAFFIC SIGNAL AND REMOVAL PLAN**  
**EXISTING FLASHING RED BEACON EQUIPMENT**  
**ILL. RTE. 394 (CALUMET EXP)**  
**AT GOODENOW ROAD**

SCALE: 1:250  
 DATE: 08-24-09

DRAWN BY: RDS  
 DESIGNED BY: BAC  
 CHECKED BY: JGG

REVISIONS	
NAME	DATE