

REF: T0P00  
REF: pr6

ILLINOIS ROUTE 1

F.A.P. RTE.	SECTION	COUNTY	TOTAL SHEETS	SHEET NO.
332/876	2002-113R	WILL	242	115
STA. 61+325		TO STA. 61+650		
FED. ROAD DIST. NO. 1		ILLINOIS FED. AID PROJECT		

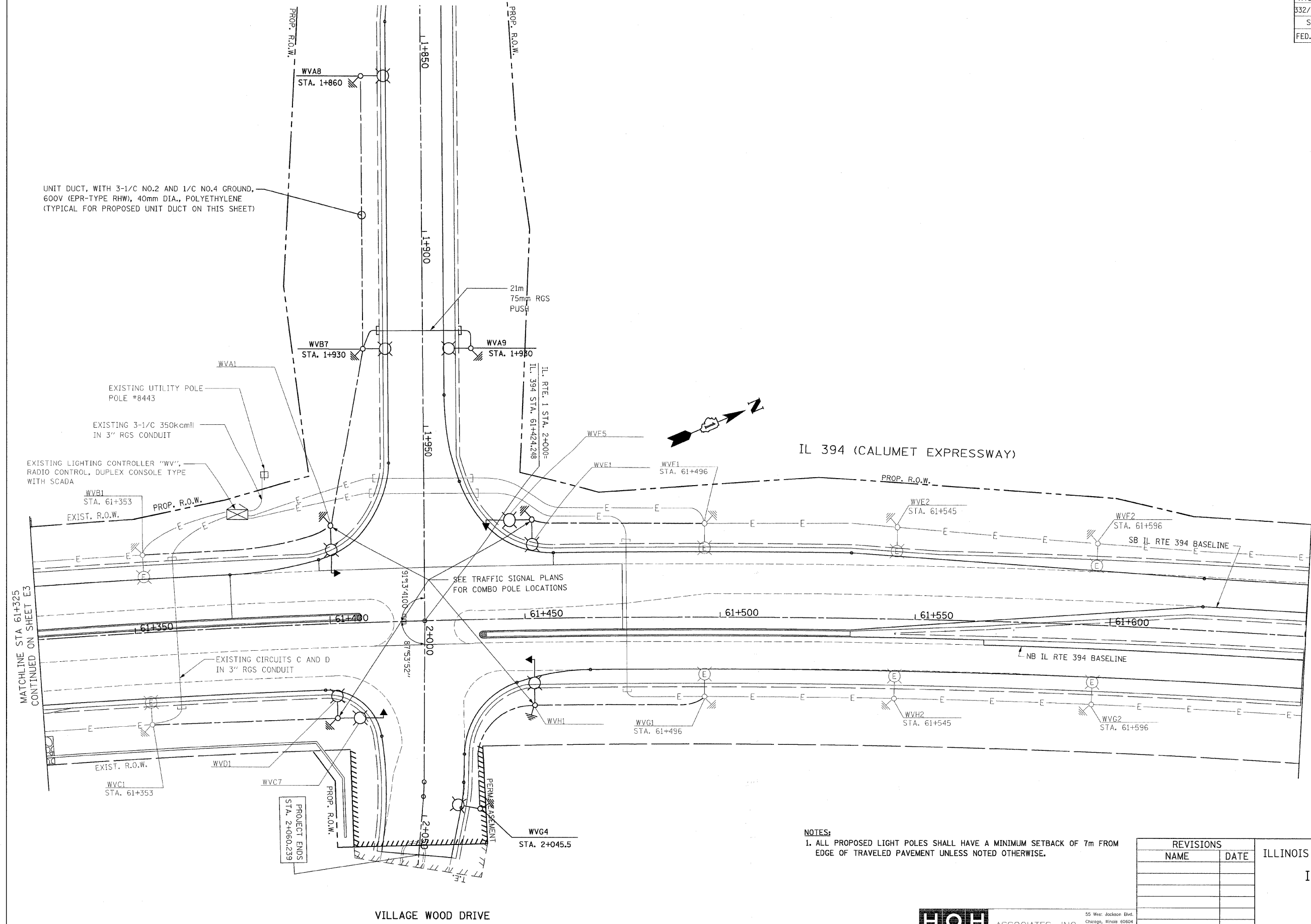

UNIT DUCT, WITH 3-1/C NO.2 AND 1/C NO.4 GROUND, 600V (EPR-TYPE RHW), 40mm DIA., POLYETHYLENE (TYPICAL FOR PROPOSED UNIT DUCT ON THIS SHEET)

EXISTING UTILITY POLE POLE #8443

EXISTING 3-1/C 350kcmil IN 3" RGS CONDUIT

EXISTING LIGHTING CONTROLLER "WV", RADIO CONTROL, DUPLEX CONSOLE TYPE WITH SCADA

SEE TRAFFIC SIGNAL PLANS FOR COMBO POLE LOCATIONS

EXISTING CIRCUITS C AND D IN 3" RGS CONDUIT

IL 394 (CALUMET EXPRESSWAY)

VILLAGE WOOD DRIVE

NOTES:  
1. ALL PROPOSED LIGHT POLES SHALL HAVE A MINIMUM SETBACK OF 7m FROM EDGE OF TRAVELED PAVEMENT UNLESS NOTED OTHERWISE.



Peter B. Leonard 7/19/09  
Exp. 11/30/109

E4

REVISIONS	
NAME	DATE

ILLINOIS DEPARTMENT OF TRANSPORTATION  
IL. RTE. 394 AT IL. 1  
PROPOSED LIGHTING PLAN  
SCALE 1:500  
DATE 11-18-2005  
DRAWN BY MEK  
CHECKED BY RER

**HOH ASSOCIATES, INC.**  
55 West Jackson Blvd.  
Chicago, Illinois 60604  
312/246-8131

PROJECT NUMBER: 2660.05  
HOH CAD FILE No.: E4.DGN  
PLOT SCALE: 1 = 1

\*DATE-TIME\*  
\*DGN-SPEC\*  
\*USER\*