

STATE OF ILLINOIS
DEPARTMENT OF TRANSPORTATION

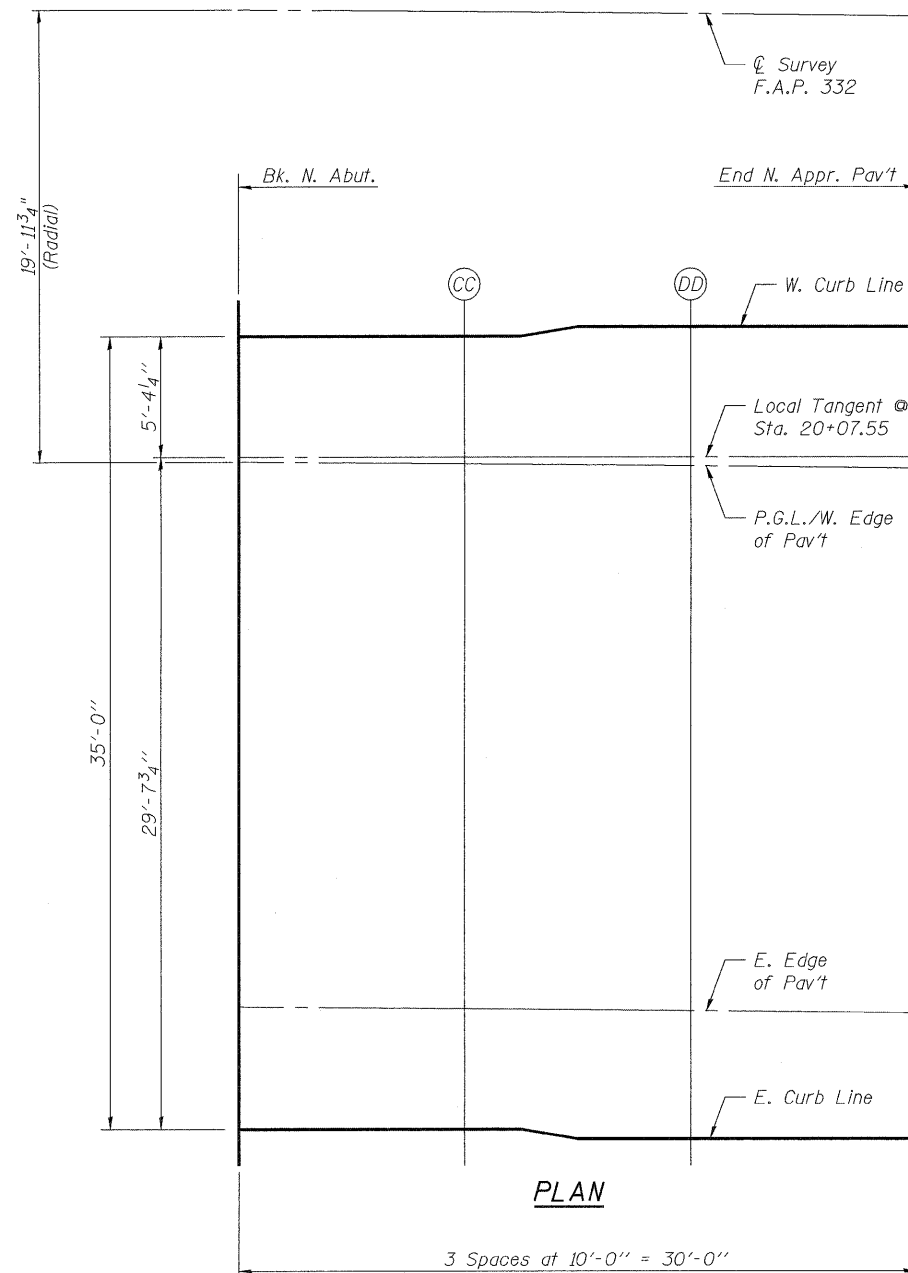
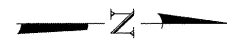

WEST CURB LINE

Location	Station	Offset	Theoretical Grade Elevations
Bk. N. Abut.	20+68.14	-5.57	726.27
CC	20+78.16	-5.65	726.30
DD	20+88.17	-6.16	726.35
End N. Appr. Pav't	20+98.19	-6.27	726.38

P.G.L. / WEST EDGE OF PAVEMENT

Location	Station	Offset	Theoretical Grade Elevations
Bk. N. Abut.	20+68.18	0.00	726.18
CC	20+78.21	0.00	726.22
DD	20+88.23	0.00	726.25
End N. Appr. Pav't	20+98.26	0.00	726.29

EAST EDGE OF PAVEMENT

Location	Station	Offset	Theoretical Grade Elevations
Bk. N. Abut.	20+68.36	24.01	725.81
CC	20+78.42	24.02	725.84
DD	20+88.48	24.02	725.88
End N. Appr. Pav't	20+98.53	24.02	725.91

EAST CURB LINE

Location	Station	Offset	Theoretical Grade Elevations
Bk. N. Abut.	20+68.41	29.43	725.72
CC	20+78.47	29.35	725.76
DD	20+88.53	29.67	725.79
End N. Appr. Pav't	20+98.60	29.56	725.82

Note:

The stations provided in these tables are measured along the Survey F.A.P. 332.
The offsets provided in these tables are measured from the Northbound Profile Grade Line.

DESIGNED	SK/GMK/LCM
CHECKED	GBC/GMK/SMK
DRAWN	RR/LCM/SK
CHECKED	GBC/GMK/SMK

TOP OF NORTH APPROACH SLAB ELEVATIONS
NORTHBOUND ILLINOIS ROUTE 394 OVER PLUM CREEK
STATION 20+07.55

SHEET NO. 8 26 SHEETS	F.A.P. RTE. 332	SECTION 2002-113R	COUNTY WILL	TOTAL SHEETS 242	SHEET NO. 153
	SN-099-0147		CONTRACT NO. 62542		
FED. ROAD DIST. NO. 1 ILLINOIS FED. AID PROJECT					

