

STATE OF ILLINOIS
DEPARTMENT OF TRANSPORTATION

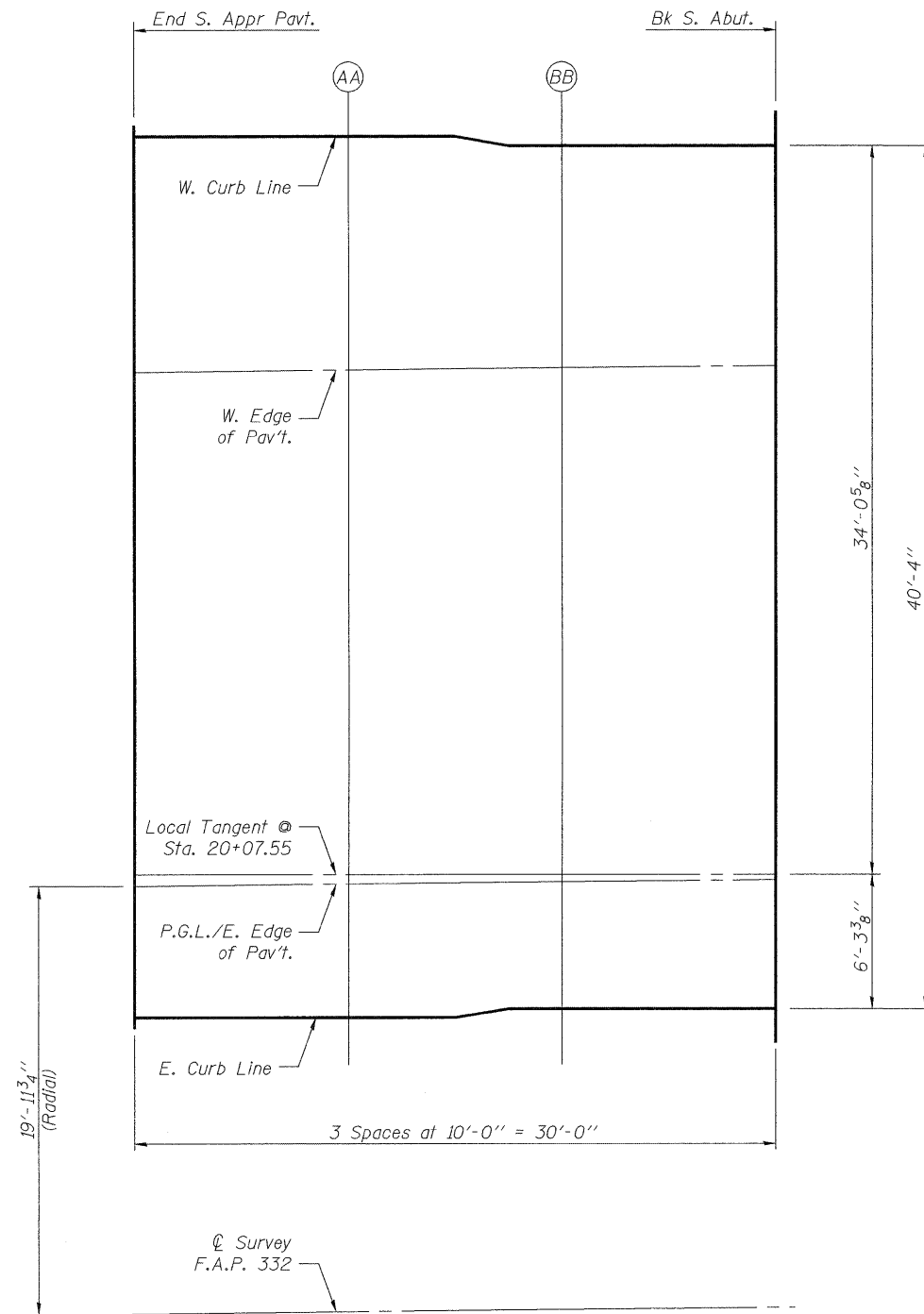
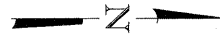

PLAN

DESIGNED	SK/GMK/LCM
CHECKED	GBC/GMK/SMK
DRAWN	RR/LCM/SK
CHECKED	GBC/GMK/SMK

Note:
The stations provided in these tables are measured along the \odot Survey F.A.P. 332.
The offsets provided in these tables are measured from the Southbound Profile Grade Line.

WEST EDGE OF PAVEMENT

Location	Station	Offset	Theoretical Grade Elevations
End of S. Appr. Pav't	19+14.09	-24.00	726.13
AA	19+24.03	-24.00	726.17
BB	19+33.98	-24.00	726.21
Bk. S. Abutment	19+43.92	-24.00	726.24

WEST CURB LINE

Location	Station	Offset	Theoretical Grade Elevations
End of S. Appr. Pav't	19+14.21	-35.02	726.36
AA	19+24.14	-34.91	726.39
BB	19+34.07	-34.40	726.42
Bk. S. Abutment	19+44.00	-34.31	726.46

P.G.L. / EAST EDGE OF PAVEMENT

Location	Station	Offset	Theoretical Grade Elevations
End of S. Appr. Pav't	19+13.80	0.00	725.62
AA	19+23.78	0.00	725.66
BB	19+33.76	0.00	725.70
Bk. S. Abutment	19+43.73	0.00	725.74

EAST CURB LINE

Location	Station	Offset	Theoretical Grade Elevations
End of S. Appr. Pav't	19+13.73	6.14	725.50
AA	19+23.71	6.25	725.53
BB	19+33.70	5.94	725.58
Bk. S. Abutment	19+43.68	6.02	725.62

TOP OF SOUTH APPROACH SLAB ELEVATIONS
SOUTHBOUND ILLINOIS ROUTE 394 OVER PLUM CREEK
STATION 20+07.55

SHEET NO. 6	F.A.P. RTE.	SECTION	COUNTY	TOTAL SHEETS	SHEET NO.
	332	2002-113R	WILL	242	177
23 SHEETS	SN-099-0183		CONTRACT NO. 62542		
FED. ROAD DIST. NO. 1 ILLINOIS FED. AID PROJECT					

