

STATE OF ILLINOIS
DEPARTMENT OF TRANSPORTATION

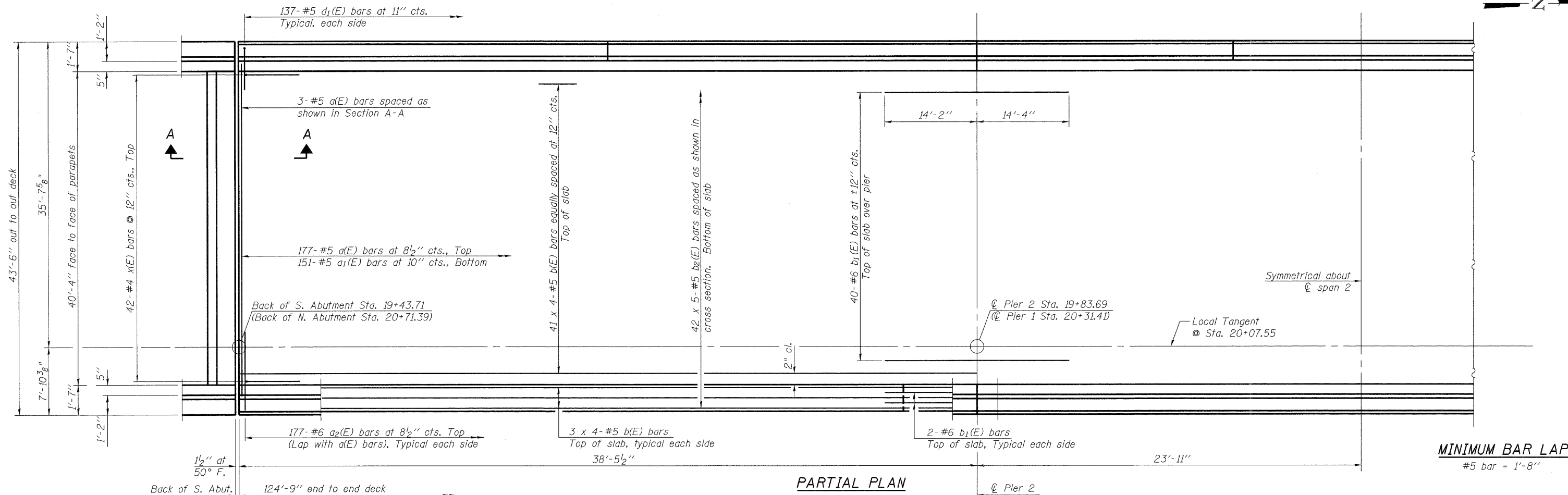

PARTIAL PLAN

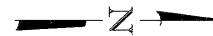
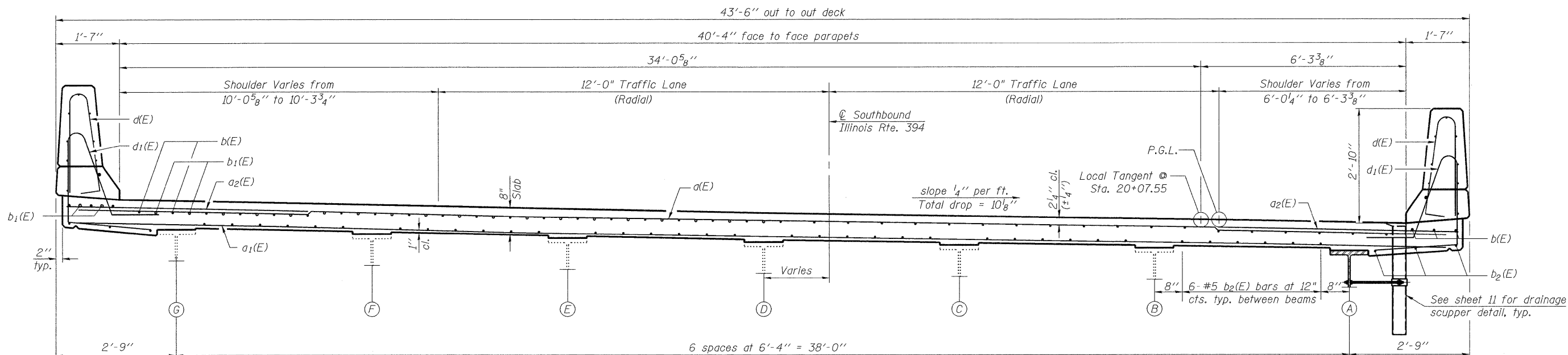

CROSS SECTION
(Looking North)

SUPERSTRUCTURE
SOUTHBOUND ILLINOIS ROUTE 394 OVER PLUM CREEK
STATION 20+07.55

Notes:
See Sheet 9 of 23 for superstructure details and Bill of Material.
Bars indicated thus 41x4-#5 etc. indicates 41 lines of bars with 4 lengths per line.
See Sheet 9 of 23 for parapet reinforcement.
See Sheet 9 of 23 for Section A-A.
Dimensions are based on a Rolled Rail Strip Seal Joint. If the Contractor elects to use the Welded Rail Strip Seal Joint, deck dimensions may require adjustments to satisfy the details on Base Sheet EJ-SSJ.

DESIGNED SK/GMK/LCM
CHECKED GBC/GMK/SMK
DRAWN RR/LCM/SK
CHECKED GBC/GMK/SMK

SHEET NO. 8 23 SHEETS	F.A.P. RTE.	SECTION	COUNTY	TOTAL SHEETS	SHEET NO.
	332	2002-113R	WILL	242	179
	SN-099-0183			CONTRACT NO.	62542
FED. ROAD DIST. NO. 1 ILLINOIS FED. AID PROJECT					

DEI Delta Engineering, Inc.
CONSULTING ENGINEERS, CONSTRUCTION MANAGERS, SUPERVISORS
111 N. JOHNSON BLVD. SUITE 300 CHICAGO, IL 60604-1001