

TYPICAL ENTRANCE/EXIT RAMP COMBINATION PAVEMENT MARKINGS

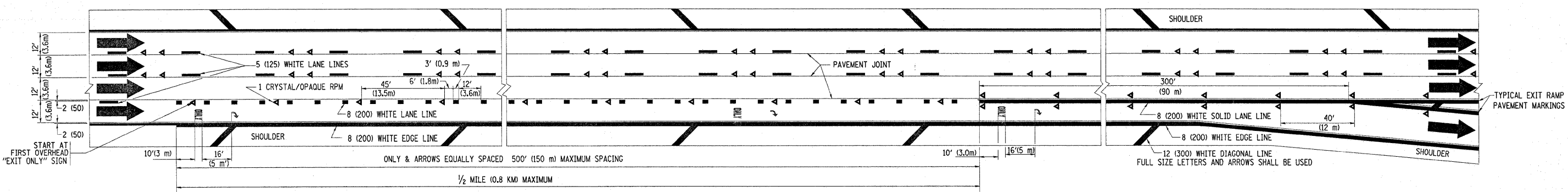

TYPICAL EXIT ONLY LANE PAVEMENT MARKINGS

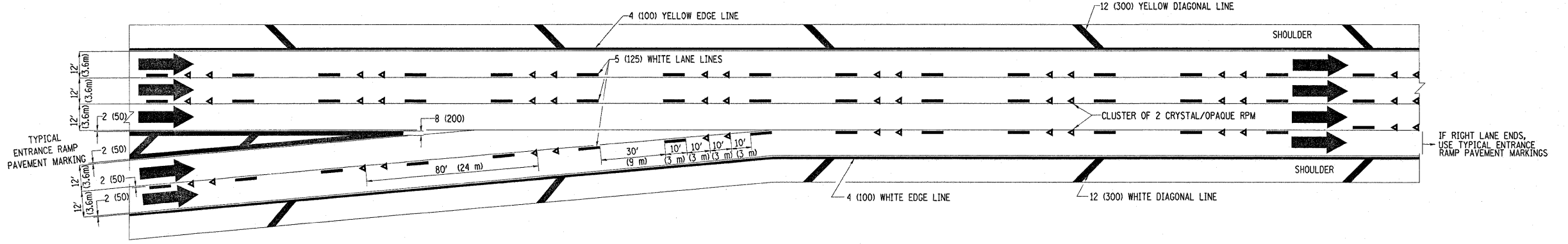

TYPICAL TWO LANE ENTRANCE RAMP PAVEMENT MARKINGS

FILE NAME =	USER NAME = banksl	DESIGNED - D.W.S.	REVISED - A.H. 03-96	STATE OF ILLINOIS DEPARTMENT OF TRANSPORTATION	MULTI-LANE FREEWAY PAVEMENT MARKING DETAILS		F.A.P. RTE.	SECTION	COUNTY	TOTAL SHEETS	SHEET NO.
est\pwork\PIWIDOT\BANKSL\08103641\01st4.dgn	PLOT SCALE = 50.0000' / 1".	CHECKED -	REVISED - J.A.F. 02-06				332/876	2002-113R	WILL	242	204
PLOT DATE = 8/25/2009	DATE - 01-90	REVISOR - S.P.B. 01-07	REVISED -				TC-12		CONTRACT NO. 62542		
							FED. ROAD DIST. NO. 1 ILLINOIS FED. AID PROJECT				
				SCALE: NONE		SHEET NO. 2 OF 2 SHEETS		STA. TO STA.			