

F.A.E. RTE.	SECTION	COUNTY	TOTAL SHEETS	SHEET NO.
332/876	2002-113B	WILL	242	233
STA. 61+575 TO STA. 61+625				
FED. ROAD DIST. NO. 1 ILLINOIS FED. AID PROJECT				

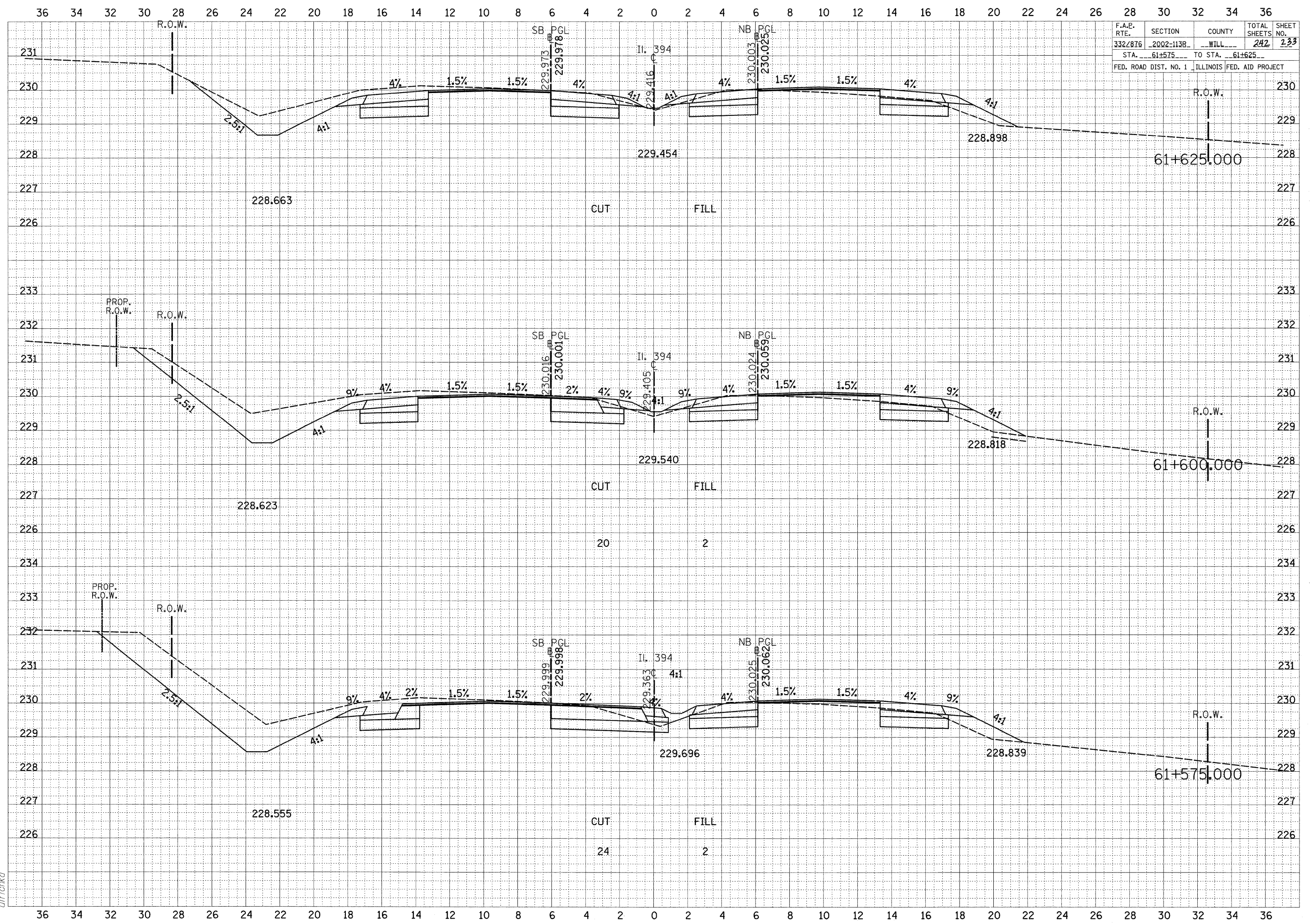

8/24/2009
 c:\pw_work\pwi\DOT\ULRICH\KD\010364\xs_11394_2.dgn
 ulrto.kd