

F.A.U. RTE. 2578	SECTION 532B	COUNTY DUPAGE	TOTAL SHEETS 117	SHEET NO. 112
STA. 164+88.06 TO STA. 165+25.00				
FED. ROAD DIST. NO. 1 ILLINOIS FED. AID PROJECT				
CONTRACT #62881				

DATE \_\_\_\_\_  
BY \_\_\_\_\_  
SURVEYED \_\_\_\_\_  
PLOTTED \_\_\_\_\_  
NOTE BOOK \_\_\_\_\_  
NO. \_\_\_\_\_  
AREAS CHECKED \_\_\_\_\_

DATE \_\_\_\_\_  
BY \_\_\_\_\_  
SURVEYED \_\_\_\_\_  
PLOTTED \_\_\_\_\_  
NOTE BOOK \_\_\_\_\_  
NO. \_\_\_\_\_  
AREAS CHECKED \_\_\_\_\_

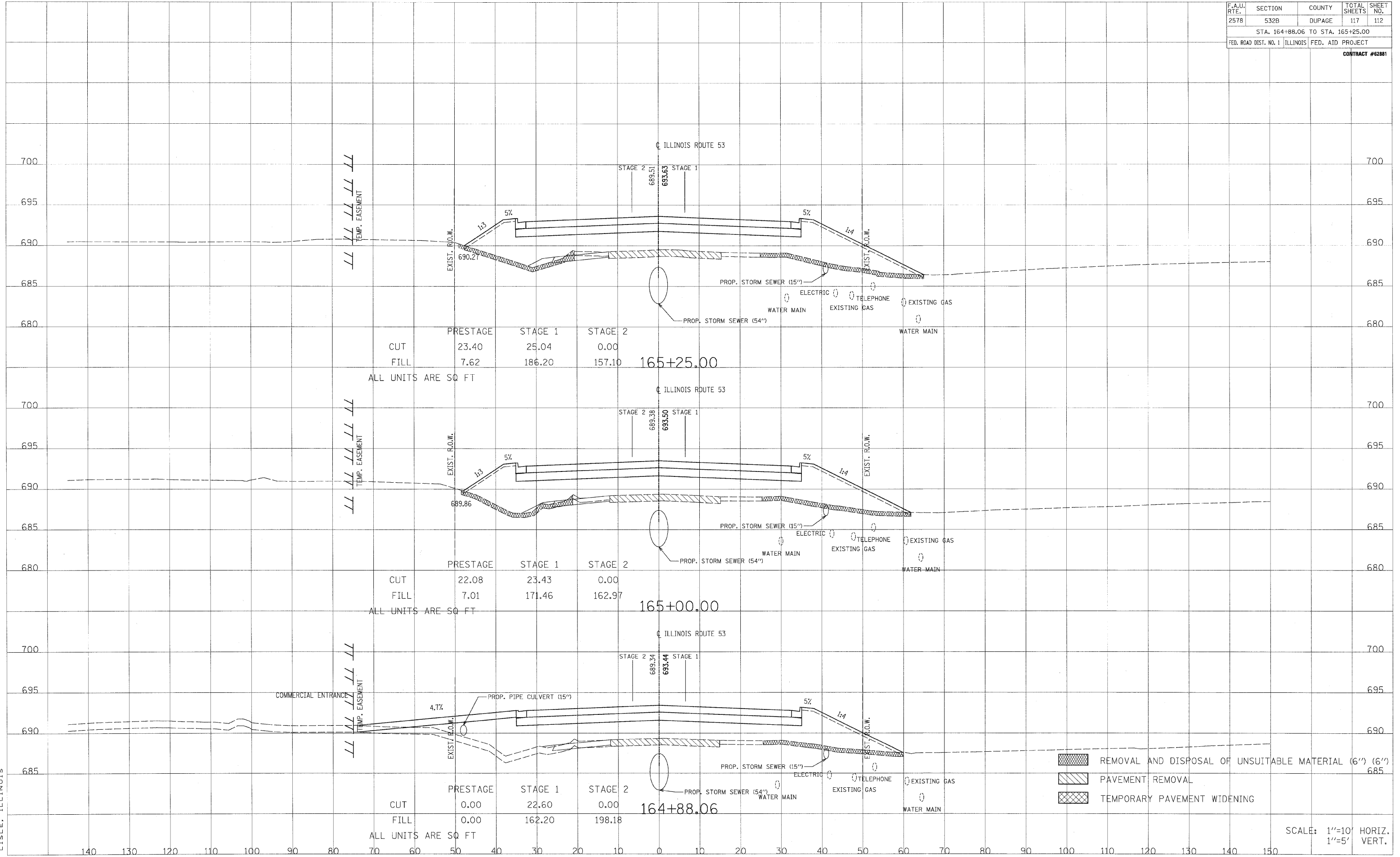

ALL UNITS ARE SQ FT

	PRESTAGE	STAGE 1	STAGE 2
CUT	23.40	25.04	0.00
FILL	7.62	186.20	157.10

ALL UNITS ARE SQ FT

	PRESTAGE	STAGE 1	STAGE 2
CUT	22.08	23.43	0.00
FILL	7.01	171.46	162.97

ALL UNITS ARE SQ FT

	PRESTAGE	STAGE 1	STAGE 2
CUT	0.00	22.60	0.00
FILL	0.00	162.20	198.18

- REMOVAL AND DISPOSAL OF UNSUITABLE MATERIAL (6") (6")
- PAVEMENT REMOVAL
- TEMPORARY PAVEMENT WIDENING

SCALE: 1"=10' HORIZ.  
1"=5' VERT.