

FINAL SURVEY	SURVEYED	DATE
NOTE BOOK	PLOTTED	BY
NO.	TEMPLATE	
	AREAS CHECKED	
	AREAS CHECKED	

ORIGINAL SURVEY	SURVEYED	DATE
NOTE BOOK	PLOTTED	BY
NO.	TEMPLATE	
	AREAS CHECKED	
	AREAS CHECKED	

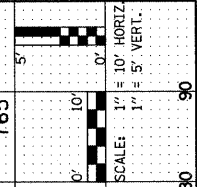
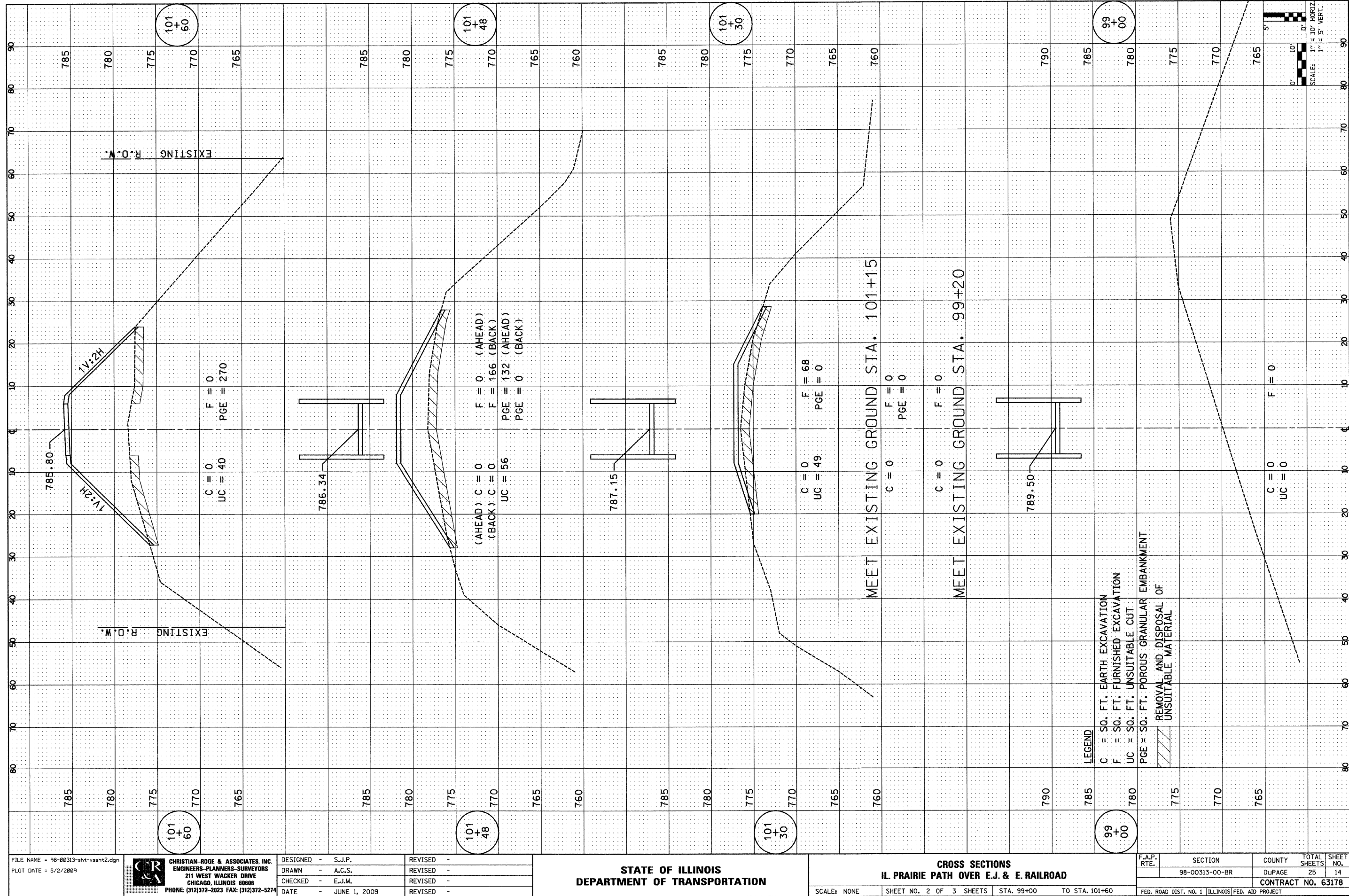

FILE NAME = 98-00313-sht-xssht2.dgn  
 PLOT DATE = 6/2/2009

**CHRISTIAN-ROGE & ASSOCIATES, INC.**  
 ENGINEERS-PLANNERS-SURVEYORS  
 211 WEST WACKER DRIVE  
 CHICAGO, ILLINOIS 60606  
 PHONE: (312)372-2023 FAX: (312)372-5274

DESIGNED	-	S.J.P.	REVISED	-
DRAWN	-	A.C.S.	REVISED	-
CHECKED	-	E.J.M.	REVISED	-
DATE	-	JUNE 1, 2009	REVISED	-

**STATE OF ILLINOIS**  
**DEPARTMENT OF TRANSPORTATION**

**CROSS SECTIONS**  
**IL PRAIRIE PATH OVER E.J. & E. RAILROAD**

F.A.P. RTE.	SECTION	COUNTY	TOTAL SHEETS	SHEET NO.
	98-00313-00-BR	DUPAGE	25	14
CONTRACT NO. 63178				
FED. ROAD DIST. NO. 1 ILLINOIS FED. AID PROJECT				