

FINAL SURVEY BY DATE
 SURVEYED PLOTTED
 NOTE BOOK AREA DATE
 AREAS CHECKED NO.

ORIGINAL SURVEY BY DATE
 SURVEYED PLOTTED
 NOTE BOOK AREA DATE
 AREAS CHECKED NO.

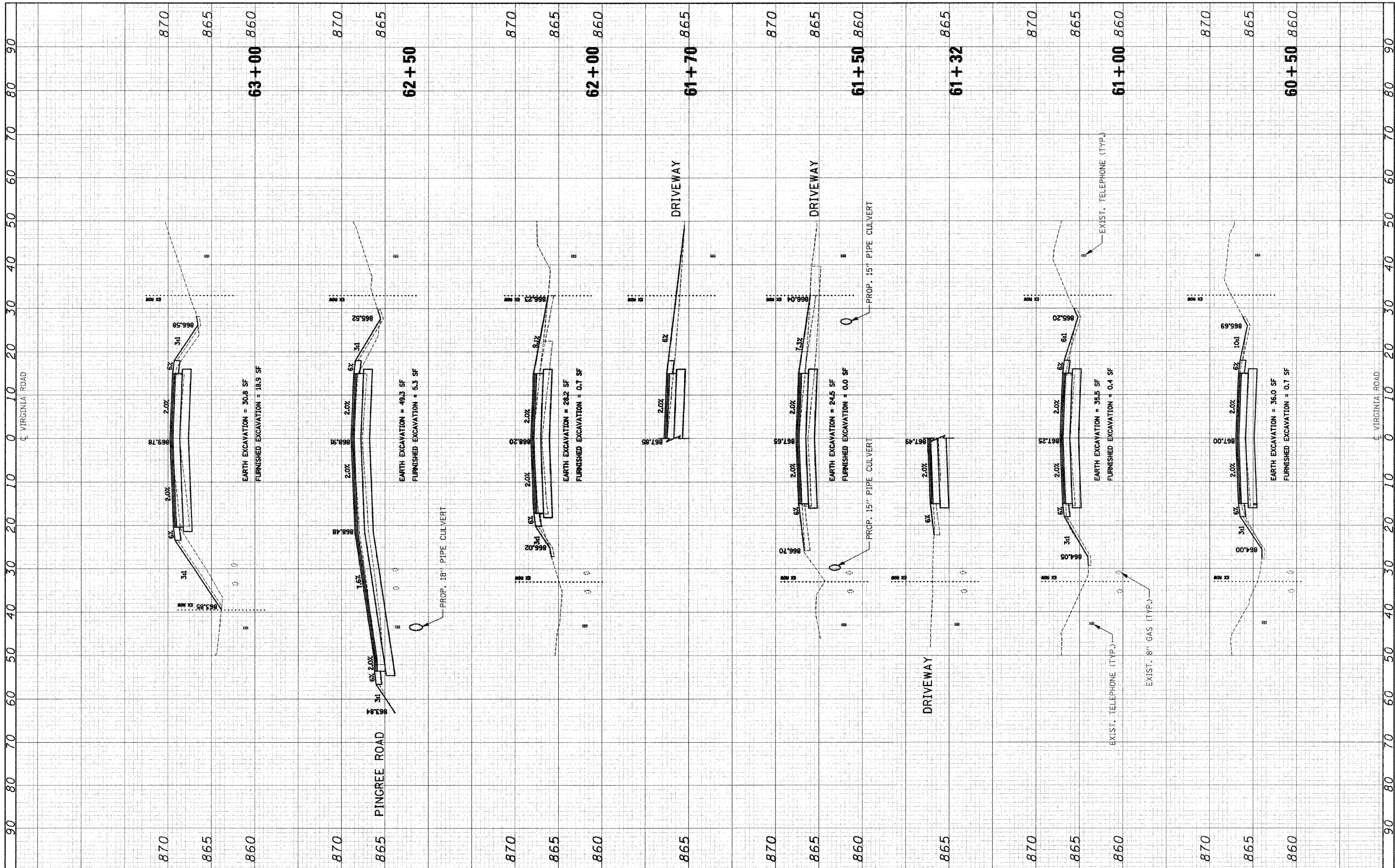

FILE NAME = J:\2211\cad\shoet\2211-shr-xa.dgn
 USER NAME = a-a
 PLOT SCALE = 10,0000 "/ IN.
 PLOT DATE = 9/23/2009

DESIGNED - RJD	REVISED -
DRAWN - ARA	REVISED -
CHECKED - GAB	REVISED -
DATE - 5-28-09	REVISED -

**STATE OF ILLINOIS
 DEPARTMENT OF TRANSPORTATION**

**CROSS SECTIONS
 VIRGINIA ROAD**

SCALE: 1"=10'H 1"=5'V SHEET NO. 9 OF 16 SHEETS STA. 60+50 TO STA. 63+00

F.A. RTE. 0121	SECTION 03-00362-00-PV	COUNTY MCHENRY	TOTAL SHEETS 54	SHEET NO. 47
FED. ROAD DIST. NO. ILLINOIS/FED. AID PROJECT: M-9003(255)			CONTRACT NO. 63195	