

FINAL SURVEY SURVEYED PLOTTED DATE SURVEYED PLOTTED DATE
 NOTE BOOK NO. AREAS CHECKED AREAS CHECKED

ORIGINAL SURVEY SURVEYED PLOTTED DATE SURVEYED PLOTTED DATE
 NOTE BOOK NO. AREAS CHECKED AREAS CHECKED

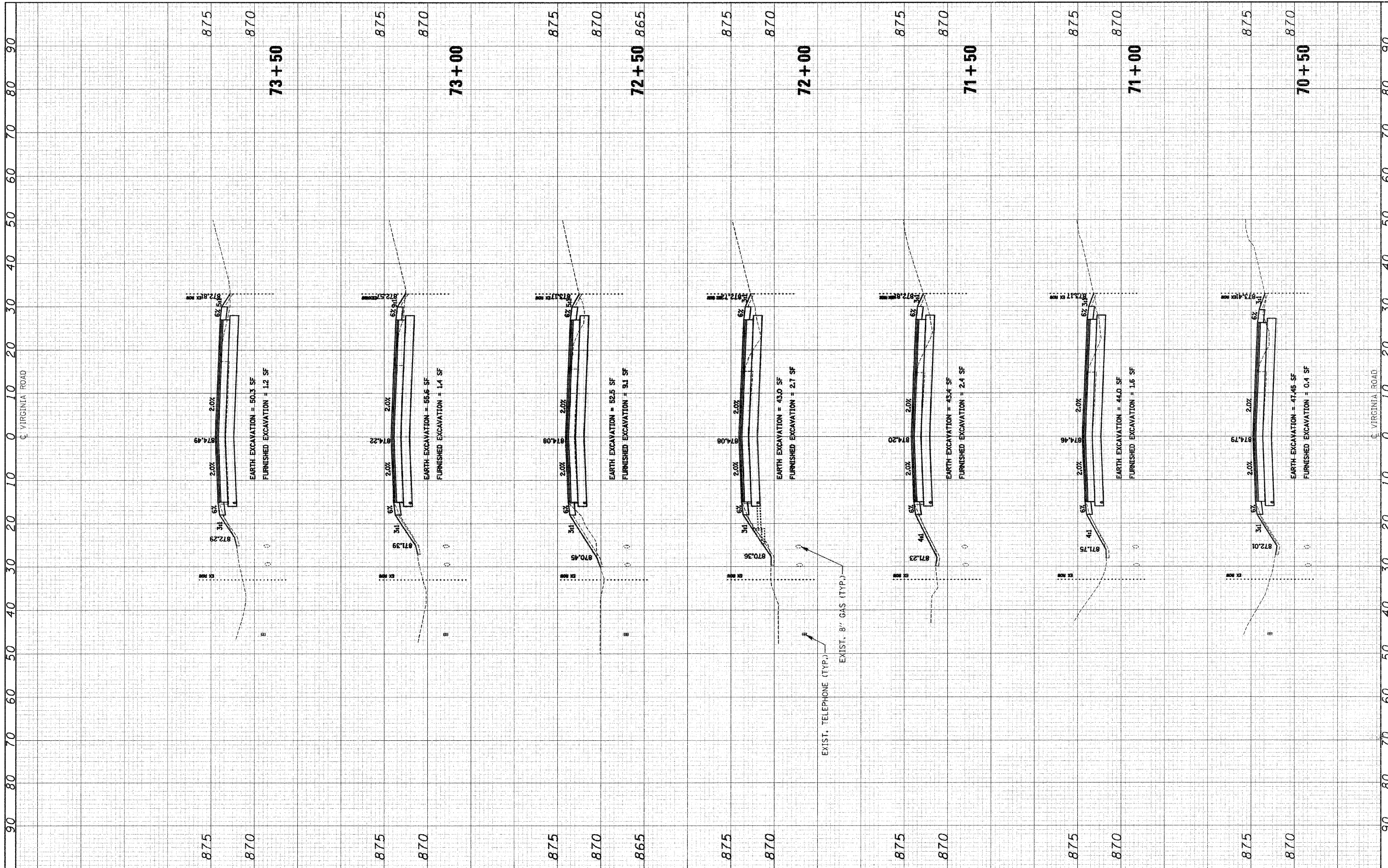

FILE NAME = J:\2211\road\sheet\2211-sht-xs.dgn
 USER NAME = ara

DESIGNED - RJD
 DRAWN - ARA
 CHECKED - GAB
 DATE - 5-28-09

REVISED -
 REVISED -
 REVISED -
 REVISED -

**STATE OF ILLINOIS
 DEPARTMENT OF TRANSPORTATION**

**CROSS SECTIONS
 VIRGINIA ROAD**
 SCALE: 1"=10'H 1/2"=5'V SHEET NO. 12 OF 16 SHEETS STA. 70+50 TO STA. 73+50

F.A. RTE.	SECTION	COUNTY	TOTAL SHEETS	SHEET NO.
0121	03-00362-00-PV	MCHENRY	54	50
CONTRACT NO. 63195				
FED. ROAD DIST. NO. ILLINOIS FED. AID PROJECT, M-9003(255)				