

PROPOSED TYPICAL SECTION  
ALDEN ROAD RECONSTRUCTION  
STATION 121+75 TO 122+54  
STATION 123+82 TO 125+20

**PROPOSED LEGEND**

- ① HOT-MIX ASPHALT SURFACE COURSE, MIX "D", N70-2" (PAID FOR AS HMA PAVEMENT (FULL DEPTH) 8")
- ② HOT-MIX ASPHALT BINDER COURSE, IL-19.0, N70-6" (PAID FOR AS HMA PAVEMENT (FULL DEPTH) 8") (IN 2 LIFTS)
- ③ AGGREGATE SUBGRADE, 12"
- ④ COMBINATION CONCRETE CURB & GUTTER, TYPE B-6.24
- ⑤ TOPSOIL FURNISH AND PLACE, 6" SODDING, SALT TOLERANT
- ⑥ PORTLAND CEMENT CONCRETE SIDEWALK, 5"
- ⑦ HOT-MIX ASPHALT SHOULDER, 6" (IN 2 LIFTS)
- ⑧ STEEL PLATE BEAM GUARD RAIL, TYPE A
- ⑨ AGGREGATE SHOULDERS, TYPE B 6"
- ⑩ SEEDING, CLASS 4A  
TOPSOIL FURNISH AND PLACE, 6"  
EROSION CONTROL BLANKET  
HEAVY DUTY EROSION CONTROL BLANKET  
ON SLOPES STEEPER THAN 3:1
- ⑪ SUB-BASE GRANULAR MATERIAL, TYPE B 4"
- ⑫ PIPE UNDERDRAINS 4"

**NOTES**

- (1) SEE PLAN SHEETS FOR LOCATIONS OF PROPOSED RIGHT OF WAY
- (2) SUPERELEVATION TRANSITION STA 128+80 TO 129+60. SEE PLAN SHEETS FOR MORE INFORMATION.
- (3) COMBINATION CONCRETE CURB AND GUTTER, TYPE B-6.24 BEGINS STA 124+87
- (4) SEE PLANS FOR GUARD RAIL LOCATIONS.
- (5) SEE LANDSCAPE PLAN FOR TRANSITION FROM SEEDING TO SODDING
- (6) SEE PLANS FOR PIPE UNDERDRAIN 4" LOCATIONS

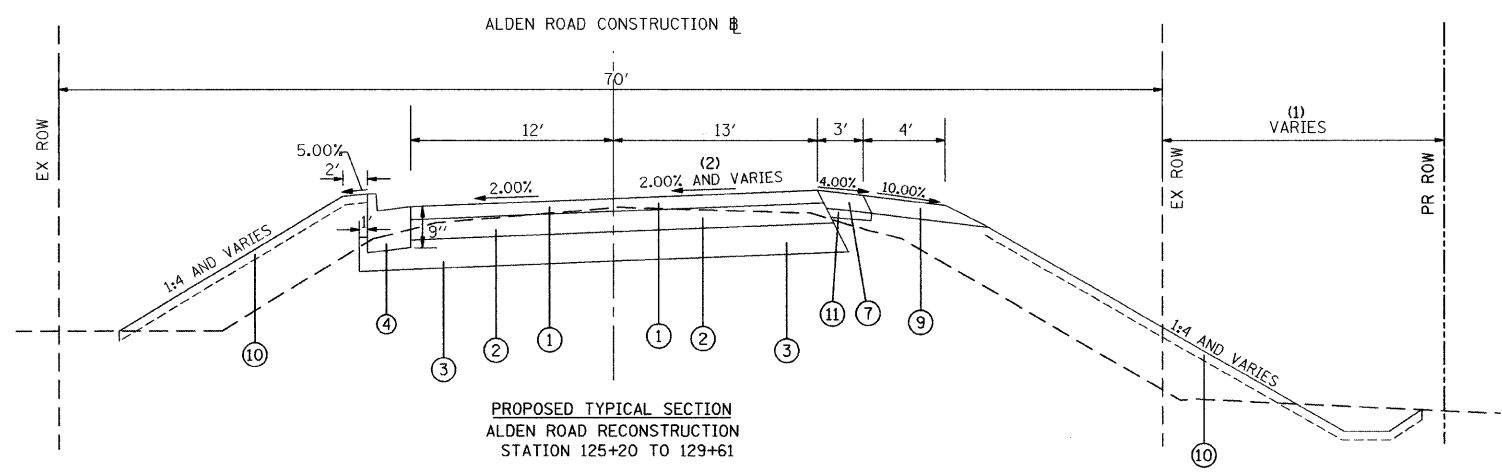

PROPOSED TYPICAL SECTION  
ALDEN ROAD RECONSTRUCTION  
STATION 125+20 TO 129+61

FILE NAME = g:\ch\4\8083\road\Sheets\0-189-Typ3.sht	USER NAME = DEComn	DESIGNED - RPJ	REVISED -	<b>STATE OF ILLINOIS DEPARTMENT OF TRANSPORTATION</b>	<b>ALDEN ROAD PROPOSED TYPICAL SECTIONS</b>			F.A.S. RTE. 0026	SECTION 02-00269-00-BR	COUNTY MCHENRY	TOTAL SHEETS 153	SHEET NO. 11
					NOT TO SCALE	SHEET NO. 3 OF 3 SHEETS	STA.	TO STA.	FED. ROAD DIST. NO. 1 ILLINOIS FED. AID PROJECT			
					CHECKED - DWB							
					DATE - 05/29/2009							