

FINAL	DATE
SURVEY	BY
NOTED	
BOOK	
NO.	

ORIGINAL	DATE
SURVEY	BY
NOTED	
BOOK	
NO.	

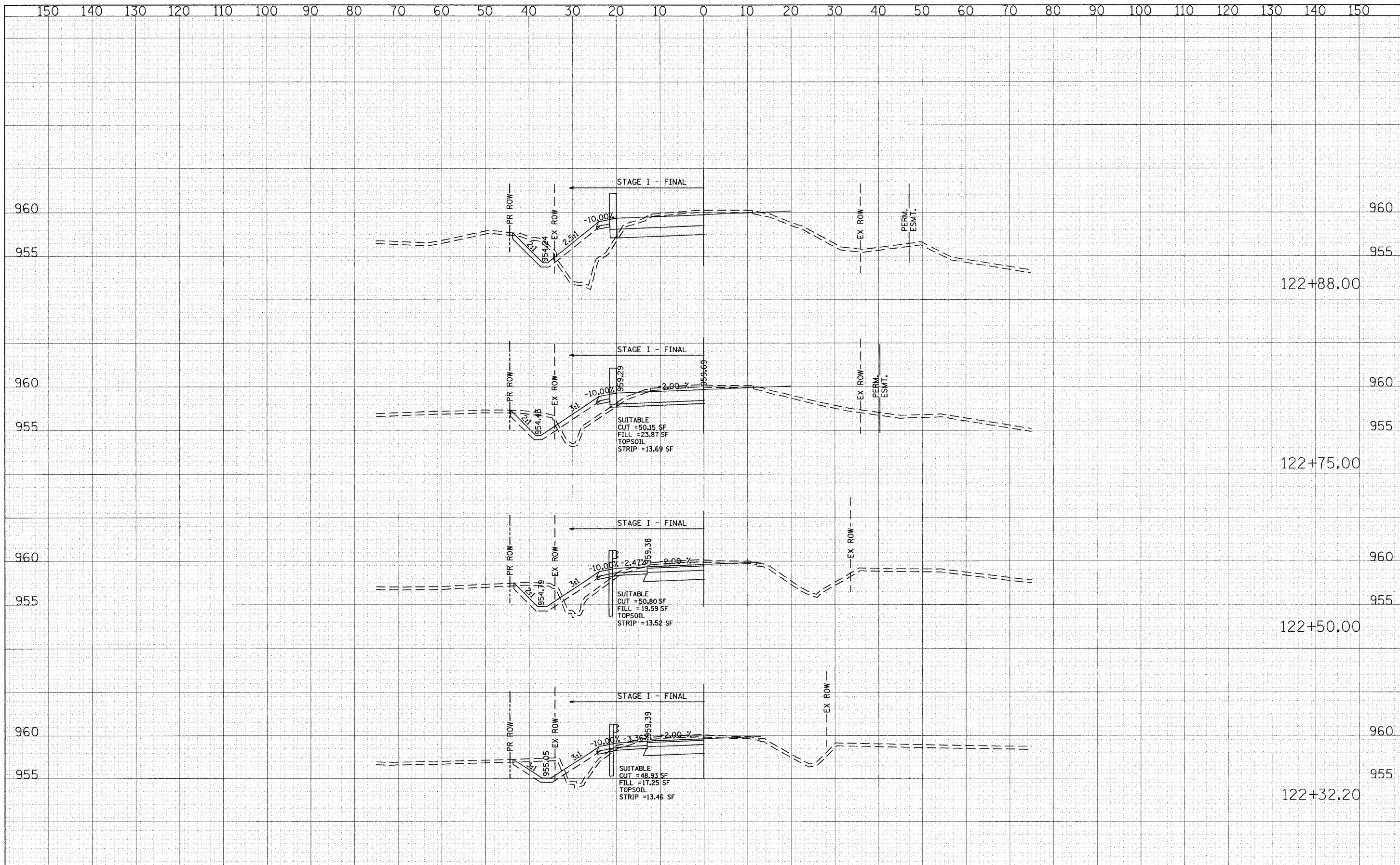

FILE NAME = g:\CH04\0083\Road\Sheets\smMOTStage1.sht
 USER NAME = CECComm

DESIGNED - CEC
 DRAWN - CEC
 CHECKED - DWB
 DATE - 09/28/2009

REVISED -
 REVISED -
 REVISED -
 REVISED -

**STATE OF ILLINOIS
 DEPARTMENT OF TRANSPORTATION**

**ALDEN ROAD
 MOT STAGE I
 CROSS SECTIONS**

SCALE: 1"=10'
 HORIZ. 1"=10'
 VERT. 1"=5'

SHEET NO. 16 OF 23 SHEETS | STA. 122+32.20 TO STA. 122+88.00

F.A. RTE.	SECTION	COUNTY	TOTAL SHEETS	SHEET NO.
0026	02-00269-00-BR	MCHENRY	153	39
CONTRACT NO.			63212	
FED. ROAD DIST. NO. ILLINOIS FED. AID PROJECT				