

FINAL	SURVEYED	DATE
SURVEY	PLOTTED	BY
NOTE BOOK	TEMPLATE	
	AREAS CHECKED	
NO.		

ORIGINAL	SURVEYED	DATE
SURVEY	PLOTTED	BY
NOTE BOOK	TEMPLATE	
	AREAS CHECKED	
NO.		

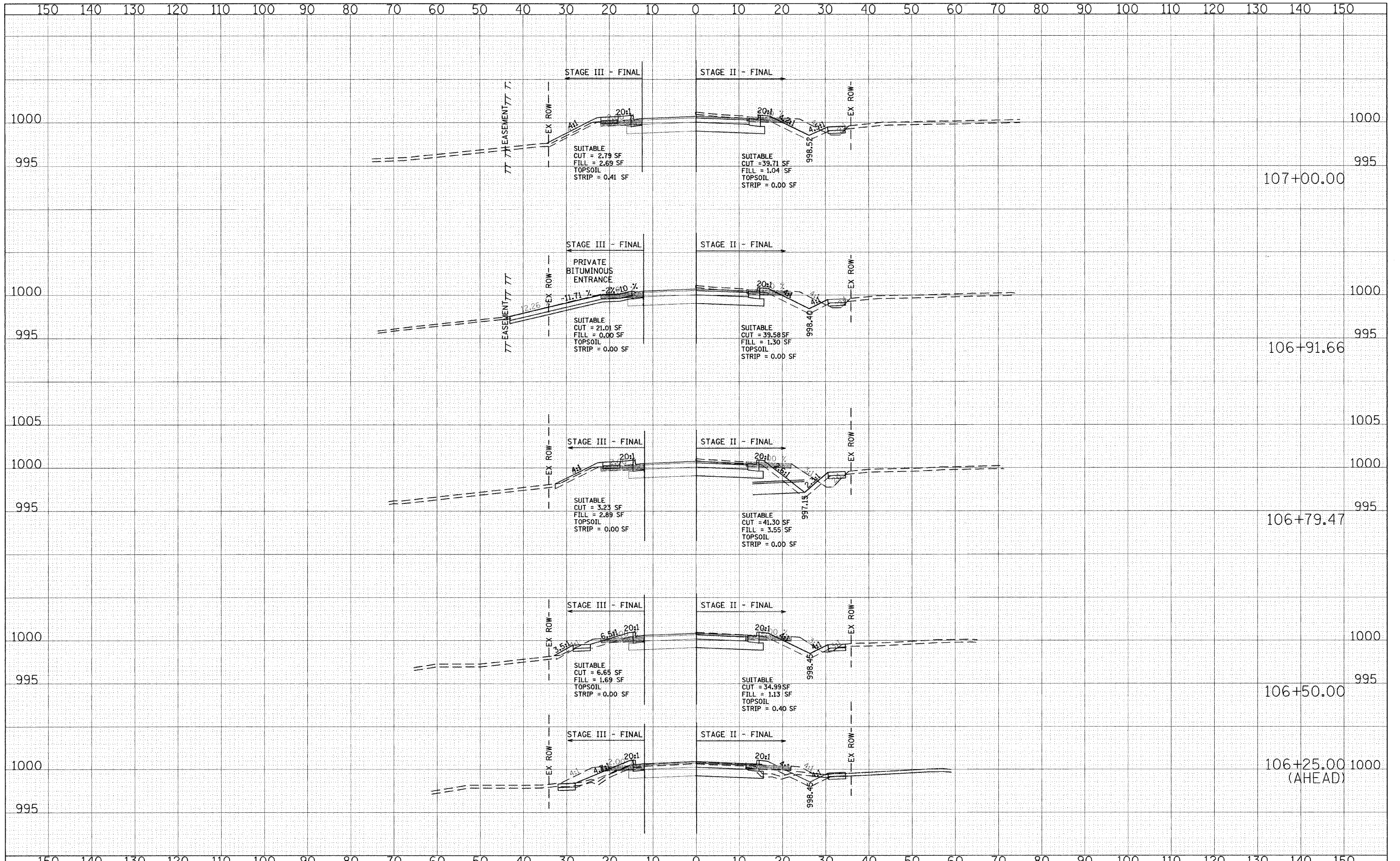

FILE NAME = g:\CH04\0083\Road\Sheets\sm\MOTStage2-3.SHT	USER NAME = CEComan	DESIGNED - CEC	REVISED -	STATE OF ILLINOIS DEPARTMENT OF TRANSPORTATION		ALDEN ROAD MOT STAGE II AND III CROSS SECTIONS		F.A. RTE. 0026	SECTION 02-00269-00-BR	COUNTY MCHENRY	TOTAL SHEETS 153	SHEET NO. 50
PLOT SCALE = 10.0000' / IN.	CHECKED - DWB	REVISED -	CONTRACT NO. 63212									
PLOT DATE = 9/28/2009	DATE - 09/28/2009	REVISED -	FED. ROAD DIST. NO. ILLINOIS FED. AID PROJECT									
			SCALE: SHEET NO. 1 OF 23 SHEETS STA. 106+00.00 TO STA. 107+00.00									