

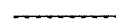





LEGEND

-  SUPER SILT FENCE (PAID FOR AS PERIMETER EROSION BARRIER X2) SEE DETAIL D, SHEET NO.75
-  PERIMETER EROSION BARRIER
-  TEMPORARY DITCH CHECKS
-  WETLAND BUFFER AREA
-  ROCK OUTLET PROTECTION SEE DETAILS A & B, SHEET NO.75 (PAID FOR AS STONE RIPRAP, CLASS A3 OR A4 AND FILTER FABRIC)
-  TREE PROTECTION WITH TEMPORARY FENCE (MINIMUM OF 10' ON EACH SIDE OF TREE), TREE ROOT PRUNING
-  INLET AND PIPE PROTECTION

TEMPORARILY INSTALL 4" OF STORM SEWER, RUBBER GASKET, CLASS A, TYPE 1, 24" PRIOR TO CONSTRUCTION OF TEMPORARY PAVEMENT IN STAGE 1 (TO BE REMOVED IN STAGE 2)

CONSTRUCT PROPOSED CATCH BASIN, 12" STORM SEWER, AND FLARED END SECTION PRIOR TO CONSTRUCTION OF TEMPORARY PAVEMENT IN STAGE 1 AS SHOWN ON THE DRAINAGE AND UTILITY SHEETS

IMPROVEMENT BEGINS ALDEN ROAD STATION 106+25

IMPROVEMENT ENDS ALDEN ROAD STATION 129+61

NOTES:

1. SEE LANDSCAPING PLAN FOR PERMANENT SODDING AND SEEDING
2. SEE SHEET 73 FOR EROSION CONTROL NOTES.
3. EROSION AND SEDIMENT CONTROL SHALL BE ADJUSTED ACCORDING TO TRAFFIC STAGING AND ENGINEER'S DIRECTION.
4. EROSION CONTROL BLANKET SHALL BE USED FOR ALL PERMANENT SEEDING LOCATIONS.
5. INLET FILTERS SHALL BE PLACED ON ALL OPEN GRATE STRUCTURES.
6. TREE PROTECTION SHALL CONSIST OF A TEMPORARY FENCE AROUND THE TREE IN ACCORDANCE WITH APPLICABLE PORTIONS OF SECTION 201 OF THE IDOT STANDARD SPECIFICATIONS.
7. PROPOSED STORM SEWER SHALL BE CONSTRUCTED IN ITS RESPECTIVE STAGE UNLESS OTHERWISE NOTED. SEE MOT SHEETS 21 TO 72 .

MAINTAIN EXIST DRAINAGE STRUCTURE THROUGH STAGE 1 UNTIL THE TEMPORARY PAVEMENT ON THE WEST SIDE IS CONSTRUCTED AT THE END OF STAGE 1 AND PROPOSED STRUCTURE 3-6 IS INSTALLED AS SHOWN ON THE DRAINAGE AND UTILITIES SHEETS

REMOVE EXIST 15" CMP AND CONSTRUCT 15" RCP STORM SEWER BETWEEN EXIST STRUCTURES IN PRE-STAGE 1. THE 15" STORM SEWER SHALL BE CONNECTED TO PROPOSED STRUCTURE 3-6 ONCE IT IS INSTALLED AT THE END OF STAGE 1 AND STRUCTURE 3-5 IN STAGE 2

CONSTRUCT TEMPORARY DITCH @ STATION 119+67 TO 121+50 PRIOR TO CONSTRUCTION OF TEMPORARY PAVEMENT AND STRUCTURE 3-6

MAINTAIN EXIST DRAINAGE STRUCTURE UNTIL STAGE 2 WHEN PROPOSED STRUCTURE 3-5 IS INSTALLED AS SHOWN ON THE DRAINAGE AND UTILITIES SHEETS

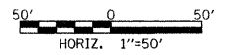
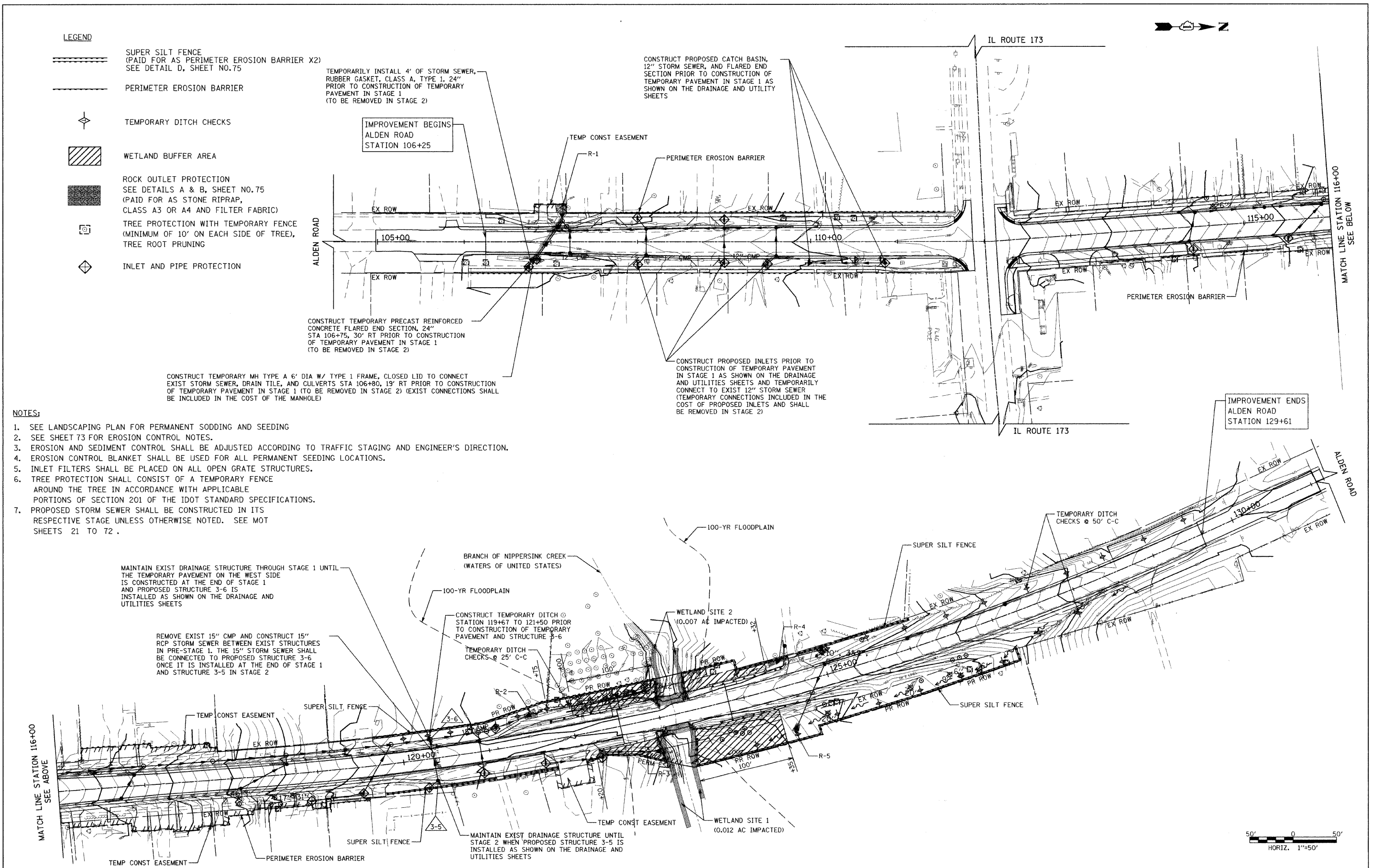

FILE NAME = g:\ch04\0083\road\Sheets\EC-681.sht	USER NAME = CEComan	DESIGNED - SDC	REVISED -	STATE OF ILLINOIS	ALDEN ROAD	F.A.S. RTE. 0026	SECTION 02-00269-00-BR	COUNTY MCHENRY	TOTAL SHEETS 153	SHEET NO. 74	
DRAWN - CEC				DEPARTMENT OF TRANSPORTATION				EROSION AND SEDIMENT CONTROL PLAN			
CHECKED - DWB				ST. 106 + 25 TO ST. 129 + 61				SCALE: SHEET NO. 2 OF 3 SHEETS STA. TO STA.			
PLOT DATE = 9/28/2009				DATE - 09/28/2009				FED. ROAD DIST. NO. 1 [ILLINOIS] FED. AID PROJECT			
PLOT SCALE = 50.000 ' / IN.				CONTRACT NO. 63212							