

PLAN	SURVEYED	DATE
	NOTED	
	BY	
	NO. _____	
	DATE _____	

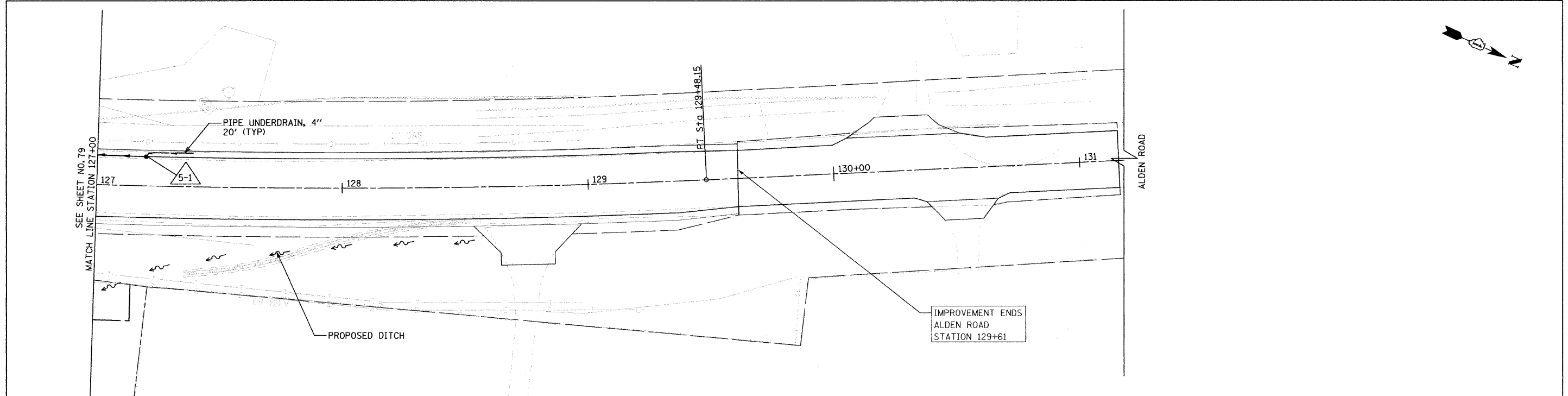

NOTE: SEE REMOVAL PLAN FOR EXISTING ITEMS TO BE REMOVED. DRAIN TILE SYSTEMS DISTURBED DURING DEVELOPMENT MUST BE RECONNECTED BY THOSE RESPONSIBLE FOR THEIR DISTURBANCE UNLESS APPROVED ENGINEERING PLANS INDICATE HOW THE DRAIN TILE SYSTEM IS TO BE CONNECTED TO THE PROPOSED STORMWATER MANAGEMENT SYSTEM. ALL ABANDONED DRAIN TILES SHALL BE REMOVED IN THEIR ENTIRETY.

SCHEDULE OF STORM SEWER STRUCTURES:

STR. NO.	STATION	OFFSET (FT)	TYPE	FRAME & GRATE	RIM ELEV.	NORTH EAST	NORTH WEST	SOUTH EAST	SOUTH WEST	EAST	WEST	SOUTH	NORTH
5-1	127+20	12 LT	CB TYPE A, 4' DIA	T24 F & G	972.20							966.50	

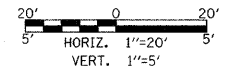

PROFILE	SURVEYED	DATE
	NOTED	
	BY	
	NO. _____	
	DATE _____	

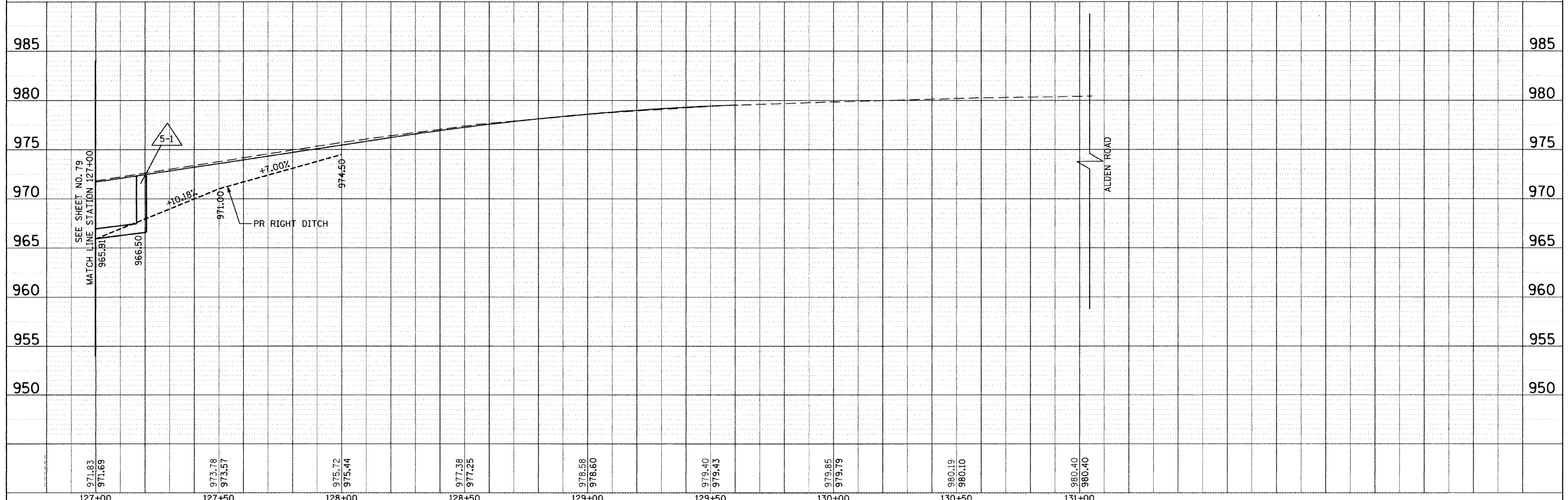

FILE NAME = g:\ch04\0093\road\Sheets\DU-505.SHT	USER NAME = CEC\comin	DESIGNED - CEC	REVISED -	STATE OF ILLINOIS DEPARTMENT OF TRANSPORTATION	ALDEN ROAD DRAINAGE AND UTILITIES PLAN	F.A. RTE. 0026	SECTION 02-00269-00-BR	COUNTY MCHENRY	TOTAL SHEETS 153	SHEET NO. 80
PLOT SCALE = 20.000' / IN.	CHECKED - DWB	REVISED -	SCALE: SHEET NO. 5 OF 5 SHEETS STA. 127+00 TO STA. 129+61			CONTRACT NO. 63212				
PLOT DATE = 8/25/2009	DATE - 08/25/2009	REVISED -	FED. ROAD DIST. NO. ILLINOIS FED. AID PROJECT							