

LEGEND:
 CHANNEL EXCAVATION

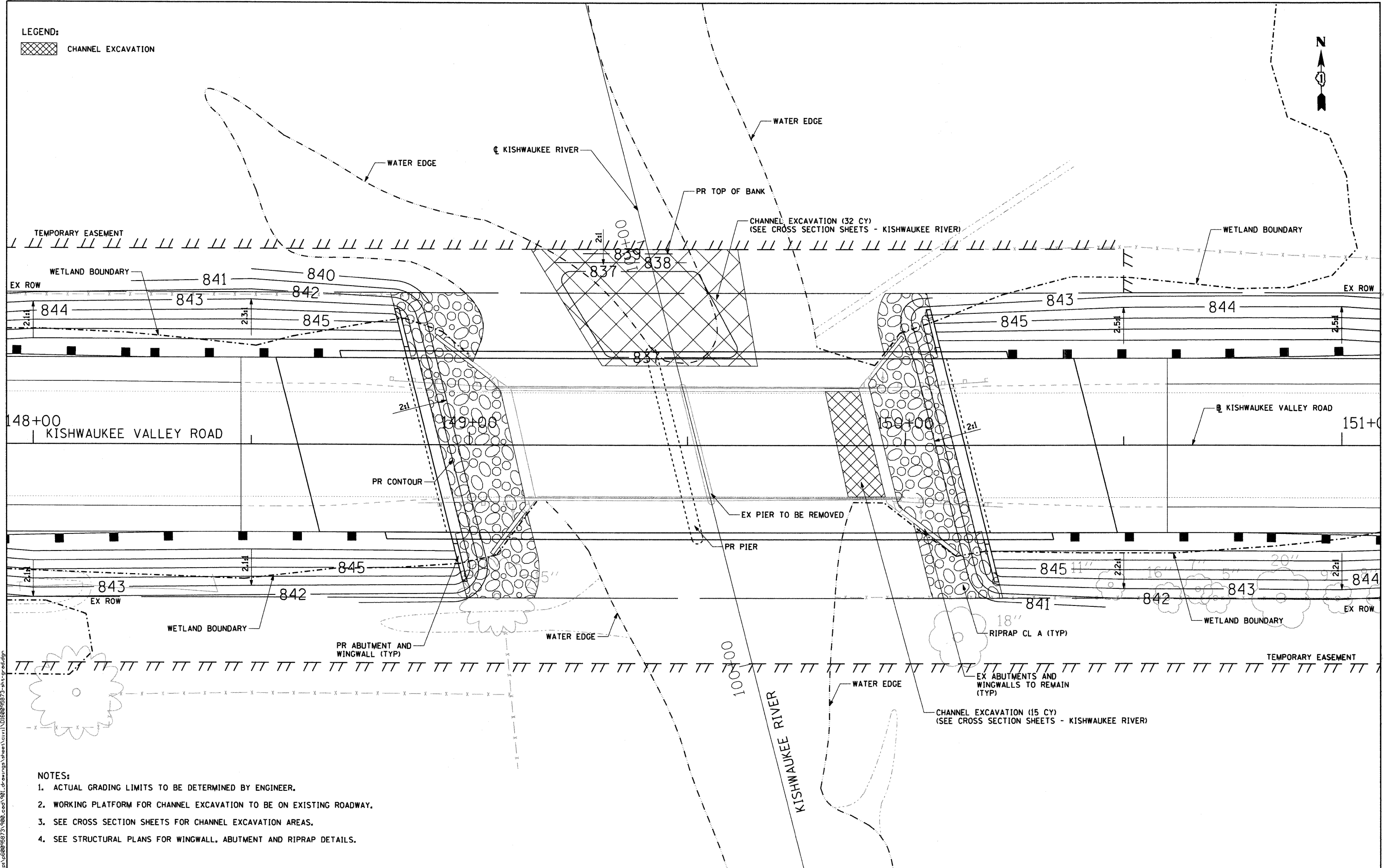

FILE NAME = p:\p60095873\980_cad\981_dr\grd\981\10160095873_sht1.grd.dgn

NOTES:

1. ACTUAL GRADING LIMITS TO BE DETERMINED BY ENGINEER.
2. WORKING PLATFORM FOR CHANNEL EXCAVATION TO BE ON EXISTING ROADWAY.
3. SEE CROSS SECTION SHEETS FOR CHANNEL EXCAVATION AREAS.
4. SEE STRUCTURAL PLANS FOR WINGWALL, ABUTMENT AND RIPRAP DETAILS.

AECOM

USER NAME = holmann
 PLOT SCALE = 10.00' / IN.
 PLOT DATE = 5/22/2009

DESIGNED - MGR
 DRAWN - MGR
 CHECKED - RMC
 DATE - MARCH 20, 2009

REVISED -
 REVISED -
 REVISED -
 REVISED -

**MCHENRY COUNTY
 DIVISION OF TRANSPORTATION**

PROPOSED GRADING PLAN

SCALE: 1"=10' SHEET NO. 1 OF 1 SHEETS STA. 147+15.85 TO STA. 151+90.03

F.A.S. RTE.	SECTION	COUNTY	TOTAL SHEETS	SHEET NO.
0031	06-00323-00-BR	MCHENRY	53	15
CONTRACT NO. 63218				
FED. ROAD DIST. NO. 1 ILLINOIS FED. AID PROJECT				