

SECTION 24, TOWNSHIP 38, RANGE 12  
SECTION 25, TOWNSHIP 38, RANGE 12

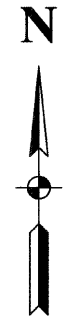

**TRAFFIC SIGNAL LEGEND**

	PROPOSED	EXISTING
CONTROLLER		
SERVICE INSTALLATION		
SIGNAL HEAD		
SIGNAL HEAD WITH BACKPLATE		
SIGNAL HEAD, PEDESTRIAN		
SIGNAL POST		
MAST ARM ASSEMBLY AND POLE, STEEL		
MAST ARM ASSEMBLY AND POLE, ALUMINUM		
COMBINATION MAST ARM ASSEMBLY AND POLE, STEEL WITH LUMINAIRE		
UNIT DUCT		
COMMON TRENCH		
HANDHOLE		
HEAVY DUTY HANDHOLE		
DOUBLE HANDHOLE		
G.S. CONDUIT IN GROUND		
PEDESTRIAN PUSHBUTTON DETECTOR		
DETECTOR LOOP		
CAST IRON JUNCTION BOX		
EMERGENCY VEHICLE SYSTEM DETECTOR		
CONFIRMATION BEACON		
SIGNAL HEAD OPTICALLY PROGRAMMED		
CONDUIT SPLICE		
WOOD POLE		
RACEWAY FOR MAGNETIC DETECTOR, TYPE I OR TYPE II		
VEHICLE DETECTOR, NON COMPENSATED MAGNETIC TYPE		
RAILROAD CONTROL CABINET		
TELEPHONE CONNECTION		
ILLUMINATED SIGN, FIBER OPTIC "NO LEFT TURN"		
ILLUMINATED SIGN, FIBER OPTIC "NO RIGHT TURN"		
UNINTERRUPTIBLE POWER SUPPLY		

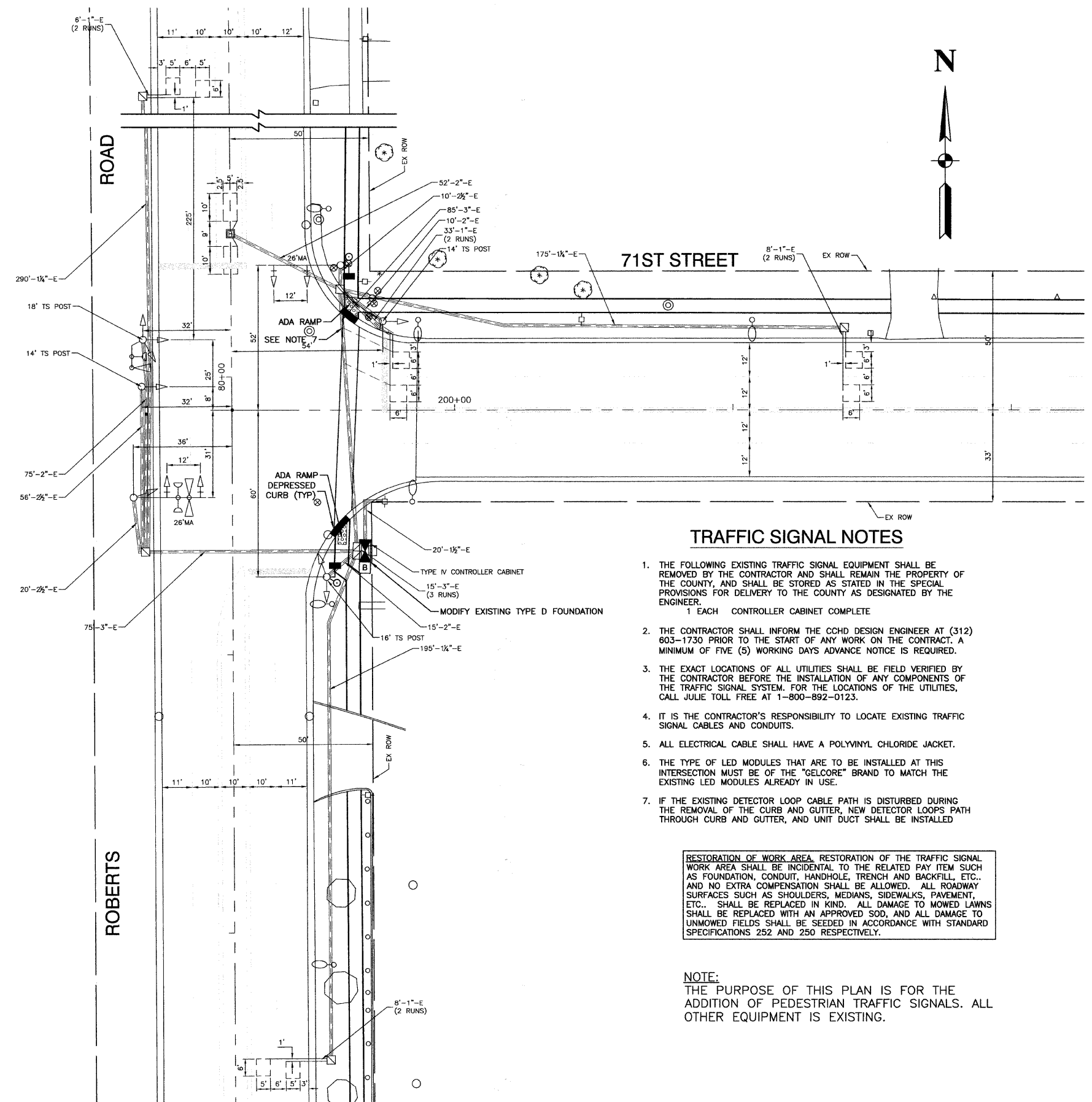

**TRAFFIC SIGNAL NOTES**

- THE FOLLOWING EXISTING TRAFFIC SIGNAL EQUIPMENT SHALL BE REMOVED BY THE CONTRACTOR AND SHALL REMAIN THE PROPERTY OF THE COUNTY, AND SHALL BE STORED AS STATED IN THE SPECIAL PROVISIONS FOR DELIVERY TO THE COUNTY AS DESIGNATED BY THE ENGINEER.  
1 EACH CONTROLLER CABINET COMPLETE
- THE CONTRACTOR SHALL INFORM THE CCHD DESIGN ENGINEER AT (312) 603-1730 PRIOR TO THE START OF ANY WORK ON THE CONTRACT. A MINIMUM OF FIVE (5) WORKING DAYS ADVANCE NOTICE IS REQUIRED.
- THE EXACT LOCATIONS OF ALL UTILITIES SHALL BE FIELD VERIFIED BY THE CONTRACTOR BEFORE THE INSTALLATION OF ANY COMPONENTS OF THE TRAFFIC SIGNAL SYSTEM. FOR THE LOCATIONS OF THE UTILITIES, CALL JULIE TOLL FREE AT 1-800-892-0123.
- IT IS THE CONTRACTOR'S RESPONSIBILITY TO LOCATE EXISTING TRAFFIC SIGNAL CABLES AND CONDUITS.
- ALL ELECTRICAL CABLE SHALL HAVE A POLYVINYL CHLORIDE JACKET.
- THE TYPE OF LED MODULES THAT ARE TO BE INSTALLED AT THIS INTERSECTION MUST BE OF THE "GELCORE" BRAND TO MATCH THE EXISTING LED MODULES ALREADY IN USE.
- IF THE EXISTING DETECTOR LOOP CABLE PATH IS DISTURBED DURING THE REMOVAL OF THE CURB AND GUTTER, NEW DETECTOR LOOPS PATH THROUGH CURB AND GUTTER, AND UNIT DUCT SHALL BE INSTALLED

RESTORATION OF WORK AREA, RESTORATION OF THE TRAFFIC SIGNAL WORK AREA SHALL BE INCIDENTAL TO THE RELATED PAY ITEM SUCH AS FOUNDATION, CONDUIT, HANDHOLE, TRENCH AND BACKFILL, ETC.. AND NO EXTRA COMPENSATION SHALL BE ALLOWED. ALL ROADWAY SURFACES SUCH AS SHOULDERS, MEDIANS, SIDEWALKS, PAVEMENT, ETC.. SHALL BE REPLACED IN KIND. ALL DAMAGE TO MOWED LAWNS SHALL BE REPLACED WITH AN APPROVED SOD, AND ALL DAMAGE TO UNMOWED FIELDS SHALL BE SEEDED IN ACCORDANCE WITH STANDARD SPECIFICATIONS 252 AND 250 RESPECTIVELY.

**NOTE:**  
THE PURPOSE OF THIS PLAN IS FOR THE ADDITION OF PEDESTRIAN TRAFFIC SIGNALS. ALL OTHER EQUIPMENT IS EXISTING.

FILE NAME = 09291-SIGNAL-01 - P01	USER NAME =	DESIGNED -- RJW	REVISED --	<b>STATE OF ILLINOIS DEPARTMENT OF TRANSPORTATION</b>	<b>SIDWALK IMPROVEMENTS ROBERTS ROAD &amp; 71ST STREET TRAFFIC SIGNAL MODIFICATION PLAN</b>	F.A.U. RTE.	SECTION	COUNTY	TOTAL SHEETS	SHEET NO.
	CHECKED -- RJW	REVISED --	2757/1537			09-00060-00-SW	COOK	35	16	
PLOT SCALE =	DRAWN -- PS	REVISED --	CONTRACT NO. 63228							
PLOT DATE = 08-20-09	CHECKED -- AG	REVISED --	FED. ROAD DIST. NO. 1 ILLINOIS FED. AID PROJECT M-9003(325)							