

STATE OF ILLINOIS
 DEPARTMENT OF TRANSPORTATION
 DIVISION OF HIGHWAYS
**PLANS FOR PROPOSED
 FEDERAL AID HIGHWAY**

FAU 1029 (76TH AVENUE)
 95TH STREET (FAP 29) TO 103RD STREET (FAU 1573)
 LOCAL AGENCY PRESERVATION PROGRAM
 STREET RESURFACING

SECTION NO.: 09-00058-00-RS
 PROJECT NO.: M-9003 (339)
 JOB NO. C-91-655-09
 LEAD LOCAL AGENCY : VILLAGE of BRIDGEVIEW
 CITY of HICKORY HILLS
 COOK COUNTY

F. A. U. NO.	SECTION	COUNTY	TOTAL SHEETS	SHEET NO.
1029	09-00058-00-RS	COOK	15	1
STA.		TO STA.		
FED. ROAD DIST. NO. 1		ILLINOIS	FED. AID PROJECT M-9003 (339)	

CONTRACT #63259

INDEX OF SHEETS

- COVER SHEET, INDEX OF SHEETS, & STATE STANDARDS
- SUMMARY OF QUANTITIES, & GENERAL NOTES
- TYPICAL CROSS SECTIONS
- 5. PAVEMENT PLAN
- 7. STRIPING PLAN
- 15. IDOT DISTRICT 1 STANDARD DETAILS

HIGHWAY STANDARDS

- | | |
|-----------|--|
| 000001-05 | STANDARD SYMBOLS, ABBREVIATIONS AND PATTERNS |
| 424001-05 | CURB RAMPS FOR SIDEWALKS |
| 442201-03 | CLASS C AND D PATCHES |
| 602001-01 | CATCH BASIN, TYPE A |
| 606001-04 | CONCRETE CURB TYPE B AND COMBINATION CONCRETE CURB AND GUTTER |
| 606301-04 | PC CONCRETE ISLANDS AND MEDIAN |
| 701606-06 | URBAN LANE CLOSURE, MULTILANE, 2W WITH MOUNTABLE MEDIAN |
| 701701-06 | URBAN LANE CLOSURE, MULTILANE, INTERSECTION |
| 701801-04 | LANE CLOSURE, MULTILANE 1W OR 2W CROSSWALK OR SIDEWALK CLOSURE |
| 701901-01 | TRAFFIC CONTROL DEVICES |
| 780001-02 | TYPICAL PAVEMENT MARKINGS |
| 781001-03 | TYPICAL APPLICATIONS RAISED REFLECTIVE PAVEMENT MARKERS |
| 886001-01 | DETECTOR LOOP INSTALLATIONS |
| 886006-01 | TYPICAL LAYOUT FOR DETECTION LOOPS |

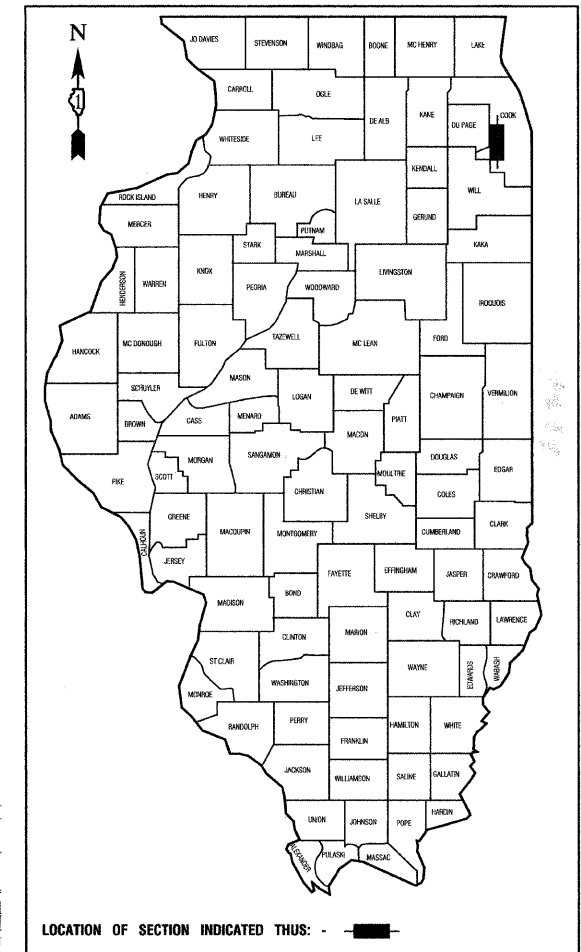

LOCATION OF SECTION INDICATED THUS: [Symbol]

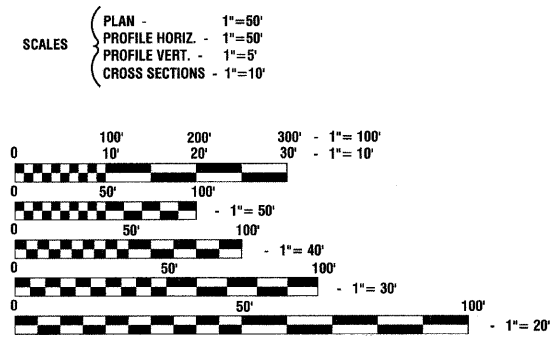

FULL SIZE PLANS HAVE BEEN PREPARED USING STANDARD ENGINEERING SCALES, REDUCED SIZED PLANS WILL NOT CONFORM TO STANDARD SCALES, IN MAKING MEASUREMENTS ON REDUCED PLANS, THE ABOVE SCALES MAY BE USED.

J. U. L. I. E.
 JOINT UTILITY LOCATION INFORMATION FOR EXCAVATION
 1-800-892-0123 or 811

CONTRACT NO. 63259

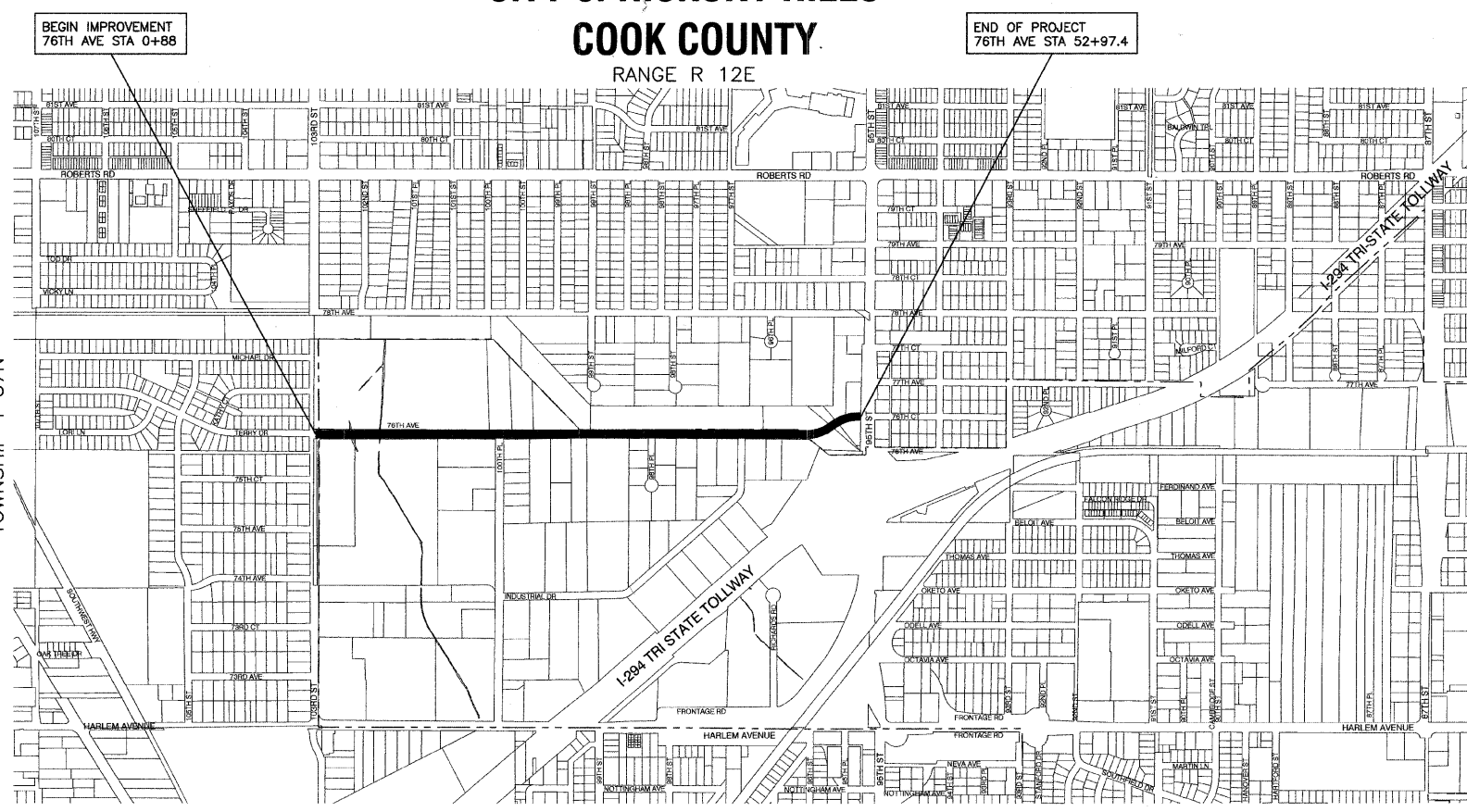

LOCATION MAP
 GROSS LENGTH=5,209.4 FEET=0.97 MILES
 NET LENGTH=5,209.4 FEET=0.97 MILES

76TH AVENUE
 ADT=6,000 (2008)
 =6,250 (2030)
 DESIGN SPEED=30 MPH
 SPEED LIMIT=30 MPH

STATE OF ILLINOIS DEPARTMENT OF TRANSPORTATION
 DIVISION OF HIGHWAYS

Approved: *[Signature]* 7/28/09
 President, Village of Bridgeview

Passed: *[Signature]* SEPTEMBER 1, 2009
 District 1 Engineer of Local Roads & Streets

Released for Bid Based on Limited Review: *[Signature]* SEPTEMBER 1, 2009
 Deputy Director of Highways, Region 1 Engineer

PRINTED BY THE AUTHORITY OF THE STATE OF ILLINOIS

PREPARED BY OR UNDER THE DIRECT SUPERVISION OF:
Thomas R. Lang 7/17/09

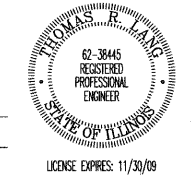

I.D.O.T. FEDERAL AID DESIGN ENGINEER: MELCHOR MANGOBA (847) 705-4408
 CONSULTANTS: ROBINSON ENGINEERING, LTD. 708-331-6700