

- LEGEND**
- ☒ TREE TO BE REMOVED
 - CONC CURB AND GUTTER REMOVAL
 - HOT-MIX ASPHALT SURFACE REMOVAL, 1 1/2"
 - HOT-MIX ASPHALT SURFACE REMOVAL, 2 1/4"
 - CONCRETE REMOVAL
 - DRIVEWAY REMOVAL

BENCH MARK: 129
 SQUARE CUT IN CONC BASE OF A LIGHT POLE NW
 CORNER OF 162ND STREET & SOUTH PARK AVENUE.
 ELEVATION = 602.150

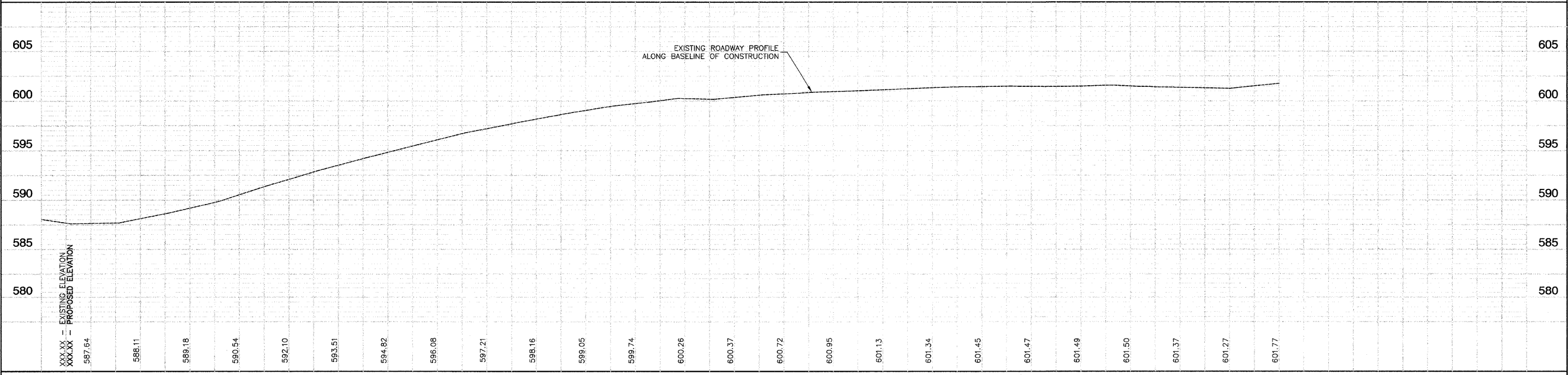

DATE	BY

DATE	BY