

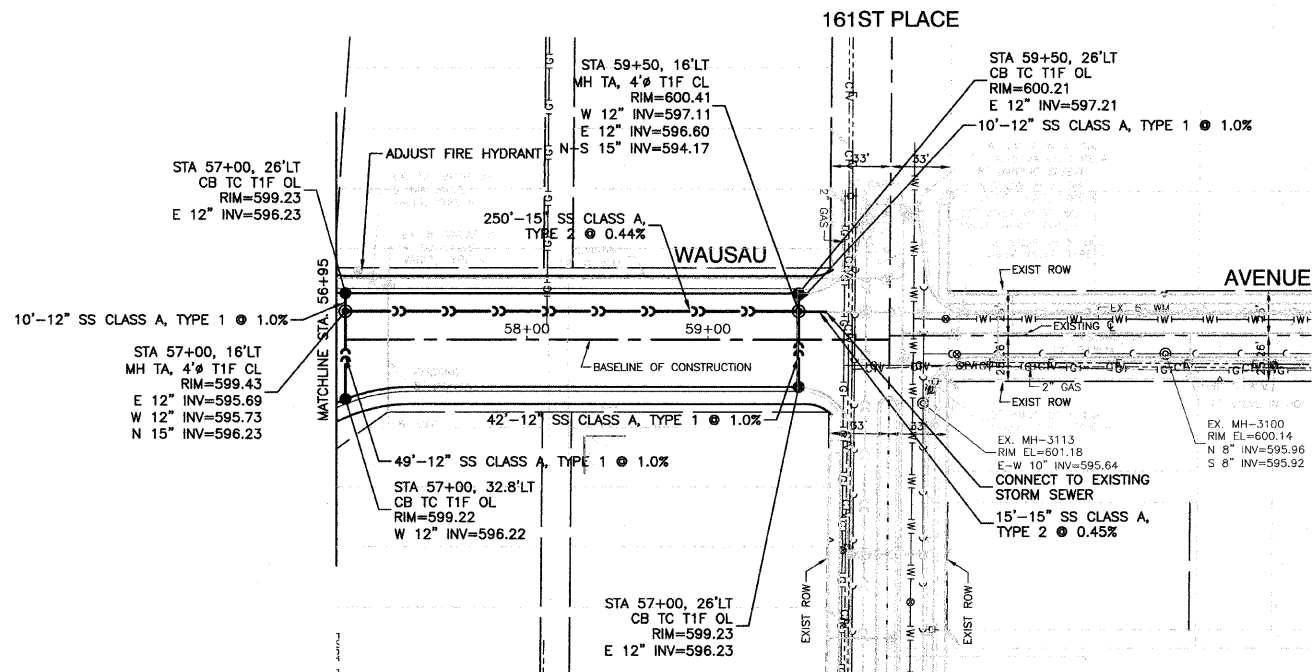

PLAN	DESIGNED	DATE
NOTE BOOK NO.	PLOTTED	BY
	ALIGNED CHECKED	
	GRADES CHECKED	
	FILE NAME	

PROFILE	DESIGNED	DATE
NOTE BOOK NO.	PLOTTED	BY
	GRADES CHECKED	
	FILE NAME	



LEGEND

- CURB & GUTTER REMOVAL
- BITUMINOUS PAVEMENT REMOVAL
- CONCRETE SIDEWALK REMOVAL
- PARKWAY REMOVAL
- PROPOSED HYDRANT W/ AUX. VALVE
- PROPOSED WATER VALVE IN VAULT
- PROPOSED BUFFALO BOX
- REMOVE EXISTING HYDRANT
- REMOVE & ABANDON EXISTING VALVE BOX
- STRUCTURE TO BE ADJUSTED
- CUT & CAP EXISTING WATER MAIN
- EXISTING WATER MAIN
- PROPOSED WATER MAIN

**BENCH MARK: 129**  
 SQUARE CUT IN CONC BASE OF A LIGHT POLE NW CORNER OF 162ND STREET & SOUTH PARK AVENUE. ELEVATION = 602.150

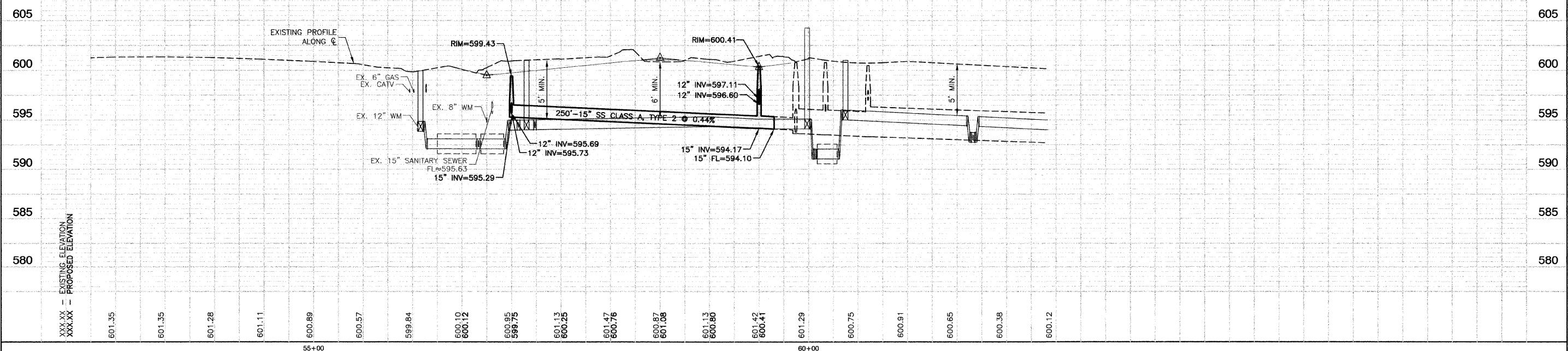

FILE NAME = 06959-WTMV-02 -IDOT PLPR02	USER NAME =	DESIGNED -- PKB	REVISED --	STATE OF ILLINOIS DEPARTMENT OF TRANSPORTATION	US ROUTE 6 (162ND STREET) & WAUSAU AVENUE INTERSECTION IMPROVEMENTS DRAINAGE & UTILITIES	F.A.P. RTE.	SECTION	COUNTY	TOTAL SHEETS	SHEET NO.	
		CHECKED -- PKB	REVISED --			351	09-00086-00-CH	COOK	43	14	
	PLOT SCALE =	DRAWN -- PS	REVISED --			CONTRACT NO. 63261					
	PLOT DATE = 8-19-09	CHECKED -- AG	REVISED --			SCALE: H 1"=50' V 1"=5' SHEET NO. 14 OF 43 SHEETS STA. TO STA. FED. ROAD DIST. NO. 1 ILLINOIS FED. AID PROJECT M-9003(330)					