

Associate Field Engineer - Kevin Stallworth (847) 705 - 4169

| SECTION | VILLAGE | TOTAL SHEETS | SHEET NO. |
|-----------------------------------|----------|--------------|-----------|
| 08-00035-00-SW | WAUCONDA | 9 | 1 |
| ILLINOIS PROJECT: SRTS-4008 (028) | | | |
| Cover Sheet | | | |

STATE OF ILLINOIS
DEPARTMENT OF TRANSPORTATION
DIVISION OF HIGHWAYS
**PLANS FOR PROPOSED
FEDERAL-AID HIGHWAY**
W. CHURCH STREET PEDESTRIAN WAY:
OSAGE ST. TO BANGS ST.
VILLAGE SECTION 08-00035-00-SW
FEDERAL PROJECT SRTS-4008 (028)
VILLAGE OF WAUCONDA
JOB NO. C-40-0003-08

INDEX OF SHEETS

- 1 Cover Sheet
- 2 Summary of Quantities, Schedule of Quantities
- 3 Typical Sections
- 4-5 Plan & Profiles
- 6-7 Cross - Sections
- 8 District One Typical Pavement Marking
- 9 Curb or Curb and Gutter Removal and Replacement

STANDARD DETAILS

- 000001-05 Standard Symbols, Abbreviations, and Patterns
- 424001-05 Curb Ramps for Sidewalks
- 606001-04 Concrete Curb and Combination Concrete Curb and Gutter
- 701301-03 Lane Closure, 2L, 2W, Short Time Operations
- 701311-03 Lane Closure, 2L 2W Moving Operations-Day Only
- 701501-05 Urban Lane Closure, 2L, 2W Undivided
- 701901-01 Traffic Control Devices
- 780001-02 Typical Pavement Markings

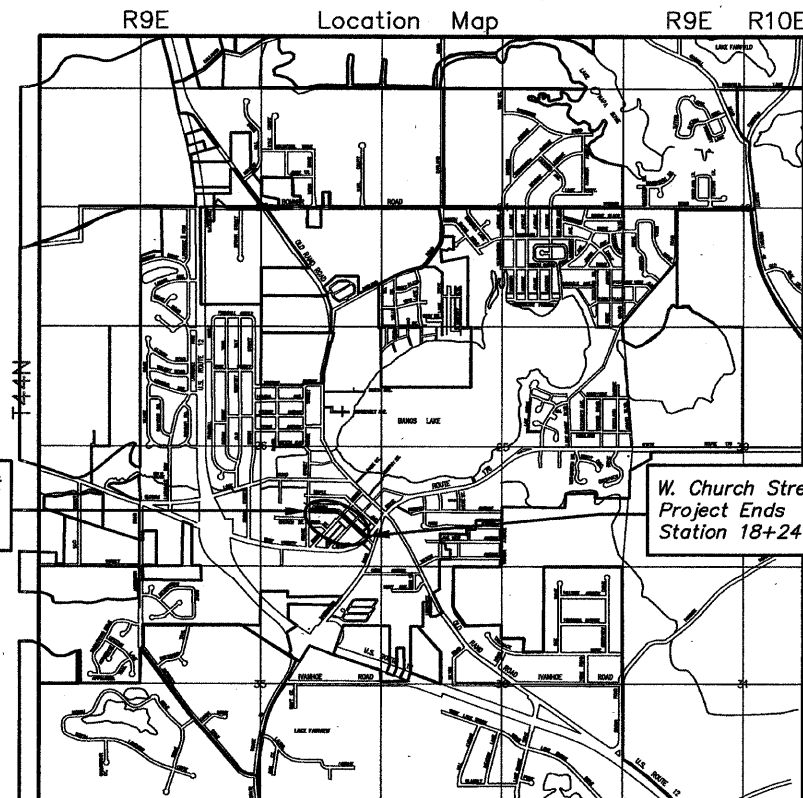
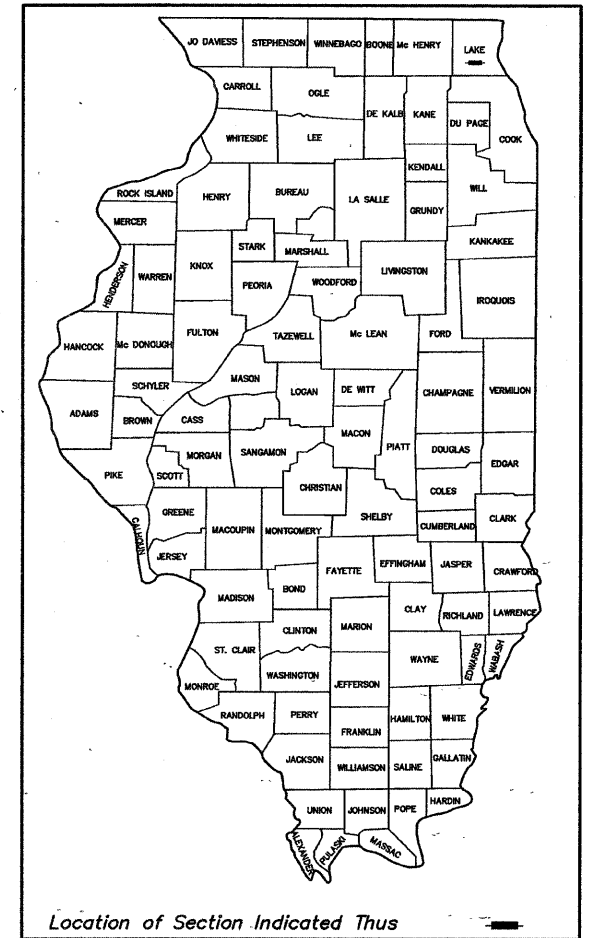

Scale: None

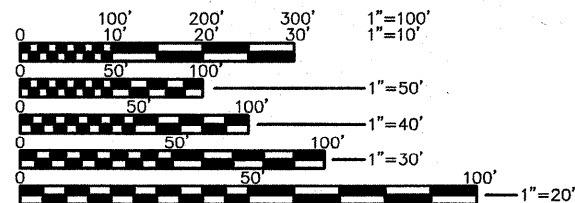

Full Size Plans Have Been Prepared Using Standard Engineering Scales, Reduced Sized Plans Will Not Conform To Standard Scales, In Making Measurements On Reduced Plans, The Above Scales May Be Used.

CONTRACT NO. 63262

PROJECT LENGTH
Total Gross Length= 807 Ft. (0.152 MI)
Total Net Length= 807 Ft. (0.152 MI)

For Underground Utility
Location Call:
J.U.L.I.E.
Toll Free
Tel. 1-800-892-0123

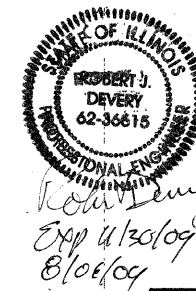

DEVERY ENGINEERING, INC.
Consulting Engineers
145 Commerce Dr. Ste. B Grayslake IL 60030
P: (847) 548-8153 F: (847) 548-8159
E: info@deveryengineering.com

APPROVED August 6 2009
Mark F. Fox
LOCAL AGENCY OFFICIAL

PASSED August 31 2009
C. H. ...
DISTRICT ENGINEER OF LOCAL ROADS & STREETS

RELEASING FOR BID BASED ON LIMITED REVIEW August 26, 2009
Diane M. O'Keefe
DISTRICT ENGINEER
DEPUTY DIRECTOR OF HIGHWAYS, REGION ONE ENGINEER
STATE OF ILLINOIS
DEPARTMENT OF TRANSPORTATION

16915401.dwg

PRINTED BY THE AUTHORITY OF THE STATE OF ILLINOIS