

FAU RTE.	SECTION	COUNTY	TOTAL SHEETS	SHEET NO.
2796	09-00031-00-PV	COOK	16	8
STA. 10+00		TO STA. 39+92		
FED. ROAD DIST. NO.		ILLINOIS	FED. AID PROJECT	
CONTRACT NO. 63267				

CENTRAL AVENUE

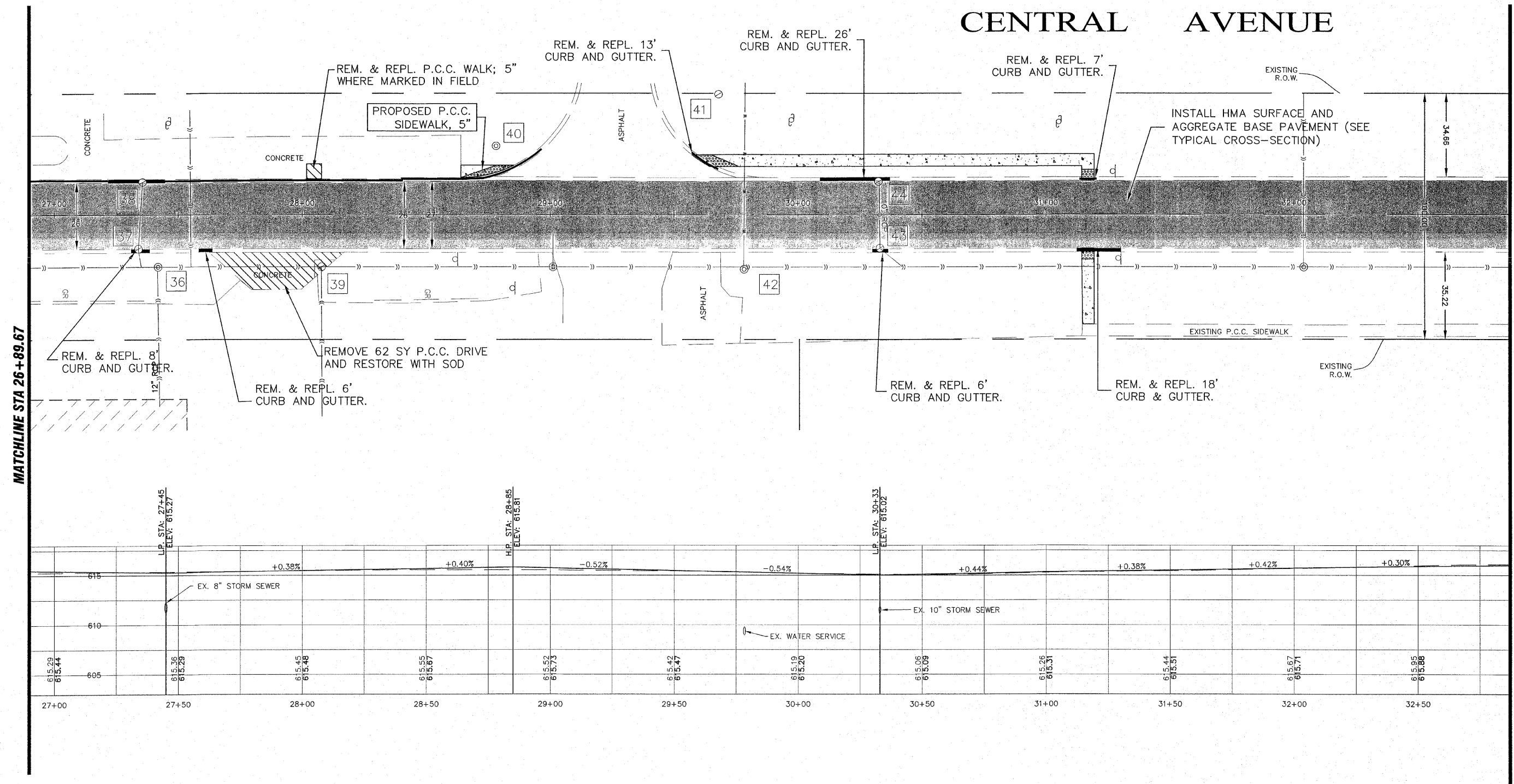

615	+0.38%										+0.40%		-0.52%		-0.54%		+0.44%		+0.38%		+0.42%		+0.30%			
610	EX. 8" STORM SEWER										EX. 10" STORM SEWER												EX. WATER SERVICE			
605	615.29 615.44	615.36 615.29	615.45 615.48	615.55 615.67	615.52 615.73	615.42 615.47	615.19 615.20	615.06 615.09	615.26 615.31	615.44 615.51	615.67 615.71	615.95 615.88														
	27+00	27+50	28+00	28+50	29+00	29+50	30+00	30+50	31+00	31+50	32+00	32+50														

hbe **Hoeflerle-Butler Engineering, Inc.**
 Consulting Civil Engineers • Land Surveyors
 PROFESSIONAL DESIGN FIRM LICENSE NO. 194-08919
 8714 S. ROBERTS ROAD ROCKY HILLS, ILLINOIS 60457
 (708) 399-9980 FAX (708) 399-9776

REVISIONS		ILLINOIS DEPARTMENT OF TRANSPORTATION VILLAGE OF BEDFORD PARK CENTRAL AVENUE RECONSTRUCTION 70th PLACE TO VILLAGE LIMITS (RR TRACKS)
NAME	DATE	
JMH PER IDOT REVIEW	08/25/09	SCALE: HORIZ: 1"=20' VERT: 1"=2' DATE: 07/16/09 DRAWN BY: JMH CHECKED BY: SAL

FILE JOB# 07-515