

FAU RTE.	SECTION	COUNTY	TOTAL SHEETS	SHEET NO.
2796	09-00031-00-PV	COOK	16	9
STA. 10+00		TO STA. 39+92		
FED. ROAD DIST. NO.	ILLINOIS	FED. AID PROJECT		
CONTRACT NO. 63267				

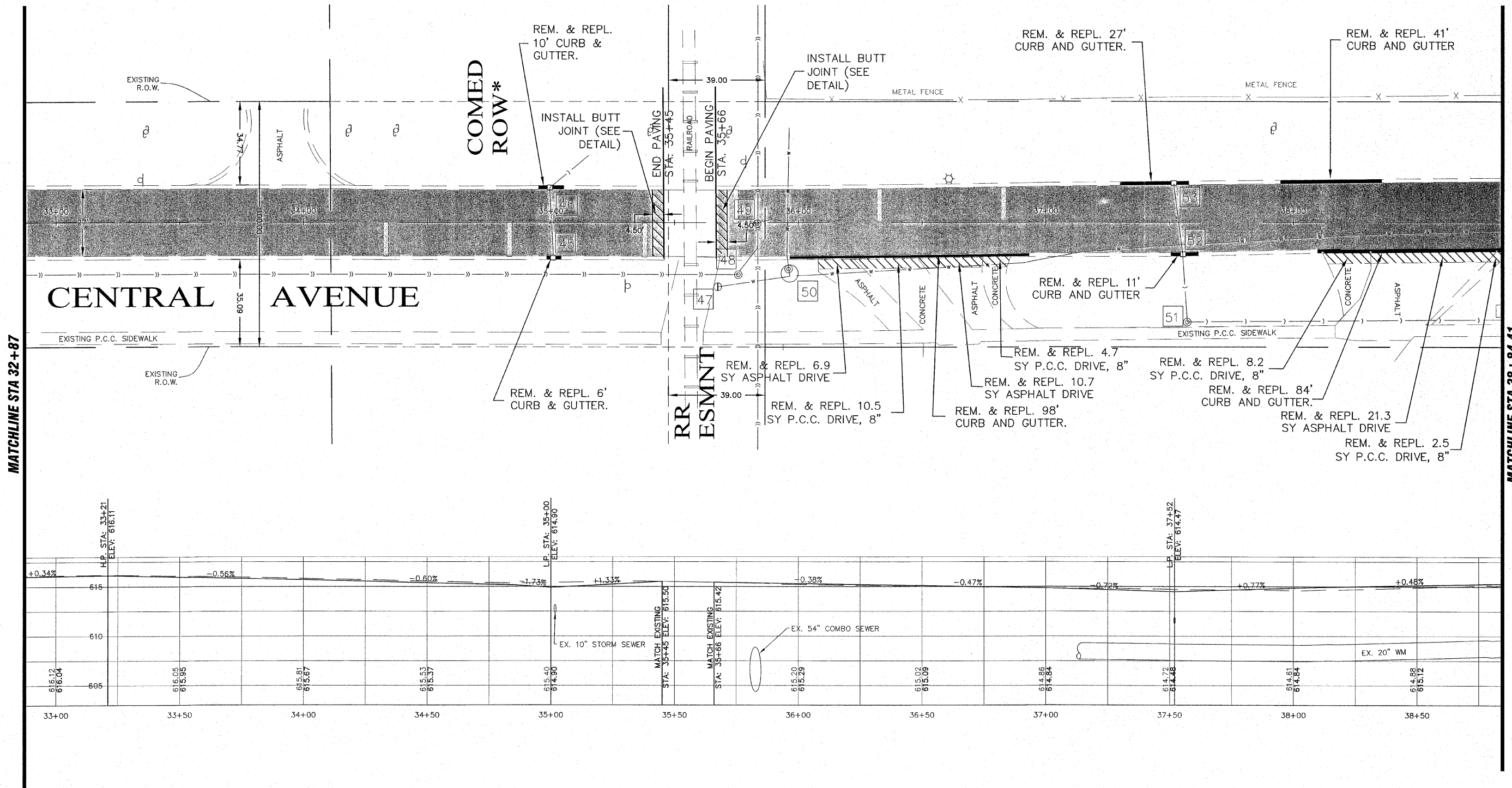

616.12 616.04	616.05 615.95	615.81 615.67	615.53 615.37	615.40 614.90	MATCH EXISTING STA: 35+45 ELEV: 615.50	MATCH EXISTING STA: 35+66 ELEV: 615.42	615.20 615.20	615.02 615.09	614.86 614.86	614.72 614.48	614.61 614.84	614.88 615.12
33+00	33+50	34+00	34+50	35+00	35+50	36+00	36+50	37+00	37+50	38+00	38+50	

hbe Hoeffler-Butler Engineering, Inc.
 Consulting Civil Engineers - Land Surveyors
 PROFESSIONAL DESIGN FIRM LICENSE NO. 084-008819
 8714 S. ROBERTS ROAD HOCKEY HILLS, ILLINOIS 60457
 (708) 599-8980 FAX (708) 599-8798

*VILLAGE HAS UNDERLYING EASEMENT THROUGH COMED R.O.W.

REVISIONS	
NO.	DATE
1	08/25/09

ILLINOIS DEPARTMENT OF TRANSPORTATION
 VILLAGE OF BEDFORD PARK
 CENTRAL AVENUE RECONSTRUCTION
 70th PLACE TO VILLAGE LIMITS (RR TRACKS)

SCALE:
 HORIZ: 1"=20'
 VERT: 1"=2'
 DATE: 07/16/09

DRAWN BY: JMH
 CHECKED BY: SAL

MATCHLINE STA 38+84.41

MATCHLINE STA 32+87