

F. A. P. NO.	SECTION	COUNTY	TOTAL SHEETS	SHEET NO.
348	09-00059-00-CH	COOK	046	013
STA.	TO STA.			
FED. ROAD DIST. NO.	ILLINOIS	FED. AID PROJECT	ARA-9003(340)	

CONTRACT #63269

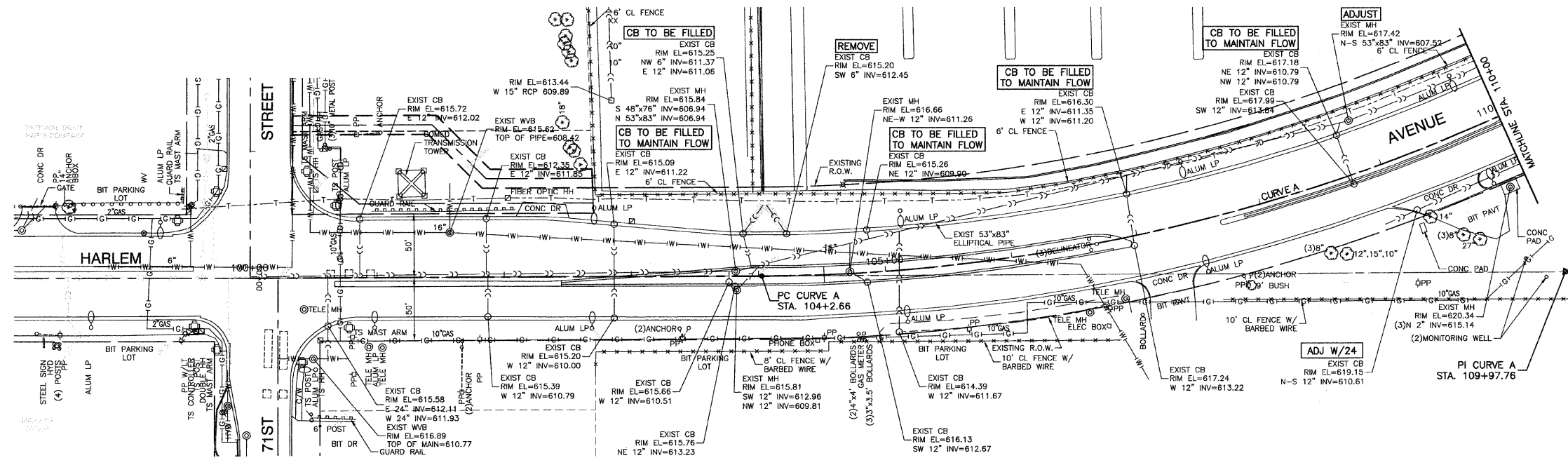

EXISTING CONDITIONS

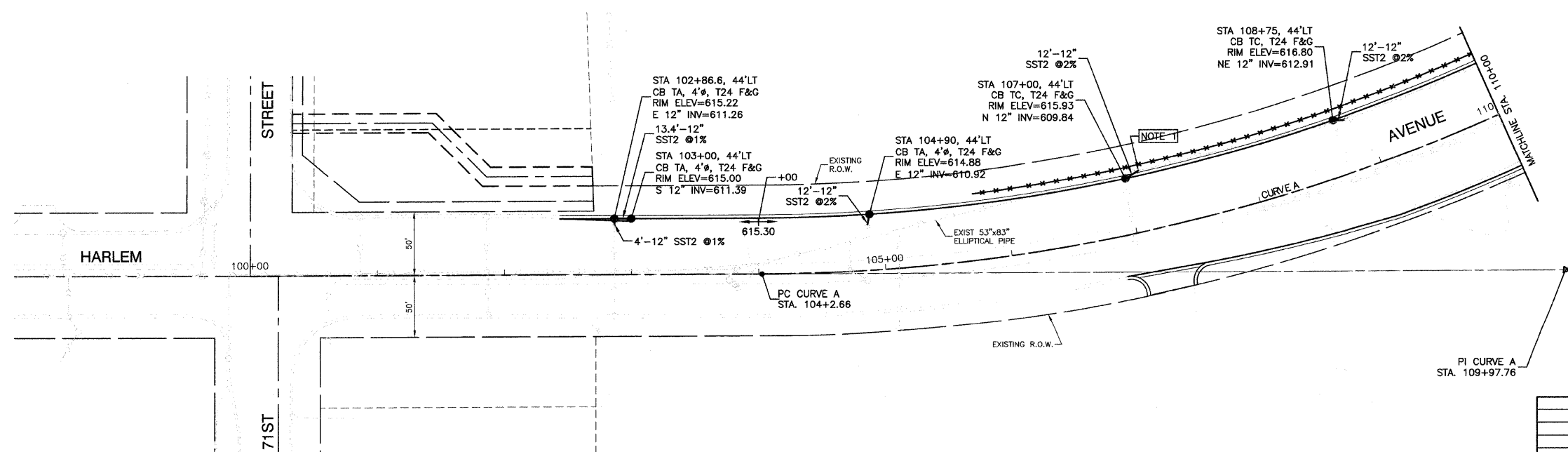

PROPOSED IMPROVEMENT

**NOTES:**  
1. CONNECTION TO THE EXISTING STORM SEWER SHALL BE MADE WITH A 12" STORM SEWER. THE COST OF THE CONNECTION WILL BE INCIDENTAL TO STORM SEWER, CLASS A, 12".

- LEGEND**
- EXISTING CATCH BASIN
  - ⊙ EXISTING MANHOLE
  - PROPOSED CATCH BASIN
  - ⊙ PROPOSED MANHOLE
  - EXISTING STORM SEWER
  - PROPOSED STORM SEWER
  - STORM SEWER REMOVAL
  - [ADJUST] CB, MH OR WW TO BE ADJUSTED
  - [ADJ W/1 OL] CB TO BE ADJUSTED WITH A NEW TYPE 1 FRAME, O.L.
  - [ADJ W/1 CL] CB TO BE ADJUSTED WITH A NEW TYPE 1 FRAME, C.L.
  - [ADJ W/23] CB TO BE ADJUSTED WITH A NEW TYPE 23 F&G
  - [ADJ W/24] CB TO BE ADJUSTED WITH A NEW TYPE 24 F&G

- BENCH MARKS:**
- X CUT ON TOP OF 8TH BOLT UP ON THE SE LEG OF COMED TOWER NORTH OF 71ST STREET 4TH TOWER WEST OF HARLEM AVENUE ELEVATION = 617.036
  - X CUT ON TOP OF 7TH BOLT UP ON THE SW LEG OF COMED TOWER NORTH OF 71ST STREET 3RD TOWER WEST OF HARLEM AVENUE ELEVATION = 617.377
  - X CUT ON TOP OF 8TH BOLT UP ON THE SE LEG OF COMED TOWER NORTH OF 71ST STREET 2ND TOWER WEST OF HARLEM AVENUE ELEVATION = 617.768

REVISIONS	
NAME	DATE

ILLINOIS DEPARTMENT OF TRANSPORTATION  
**FAP 348 (HARLEM AVENUE)  
DRIVEWAY RECONFIGURATION  
DRAINAGE & UTILITIES  
71ST STREET TO STA 110+00**

SCALE: VERT. NA  
HORIZ. 1"=50'  
DATE: 08-14-09  
DRAWN BY: PS  
CHECKED BY: RJW