

F.A.P. NO.	SECTION	COUNTY	TOTAL SHEETS	SHEET NO.
348	09-00059-00-CH	COOK	046	014
STA.		TO STA.		
FED. ROAD DIST. NO.		ILLINOIS	FED. AID PROJECT ARA-9003(340)	

CONTRACT #63269

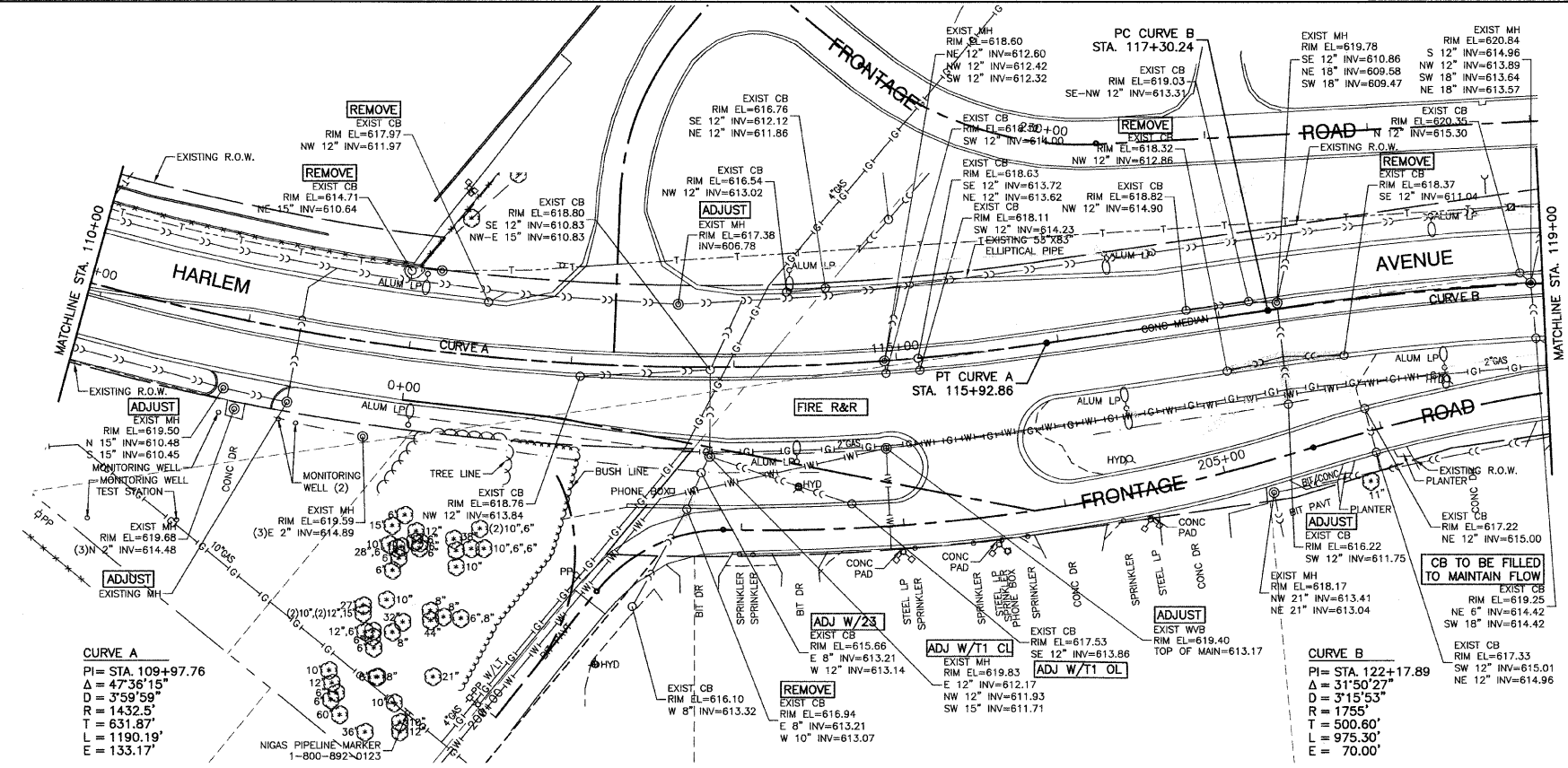

EXISTING CONDITIONS

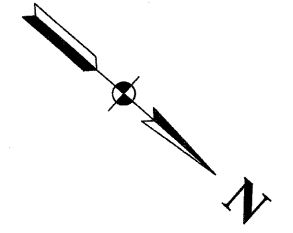
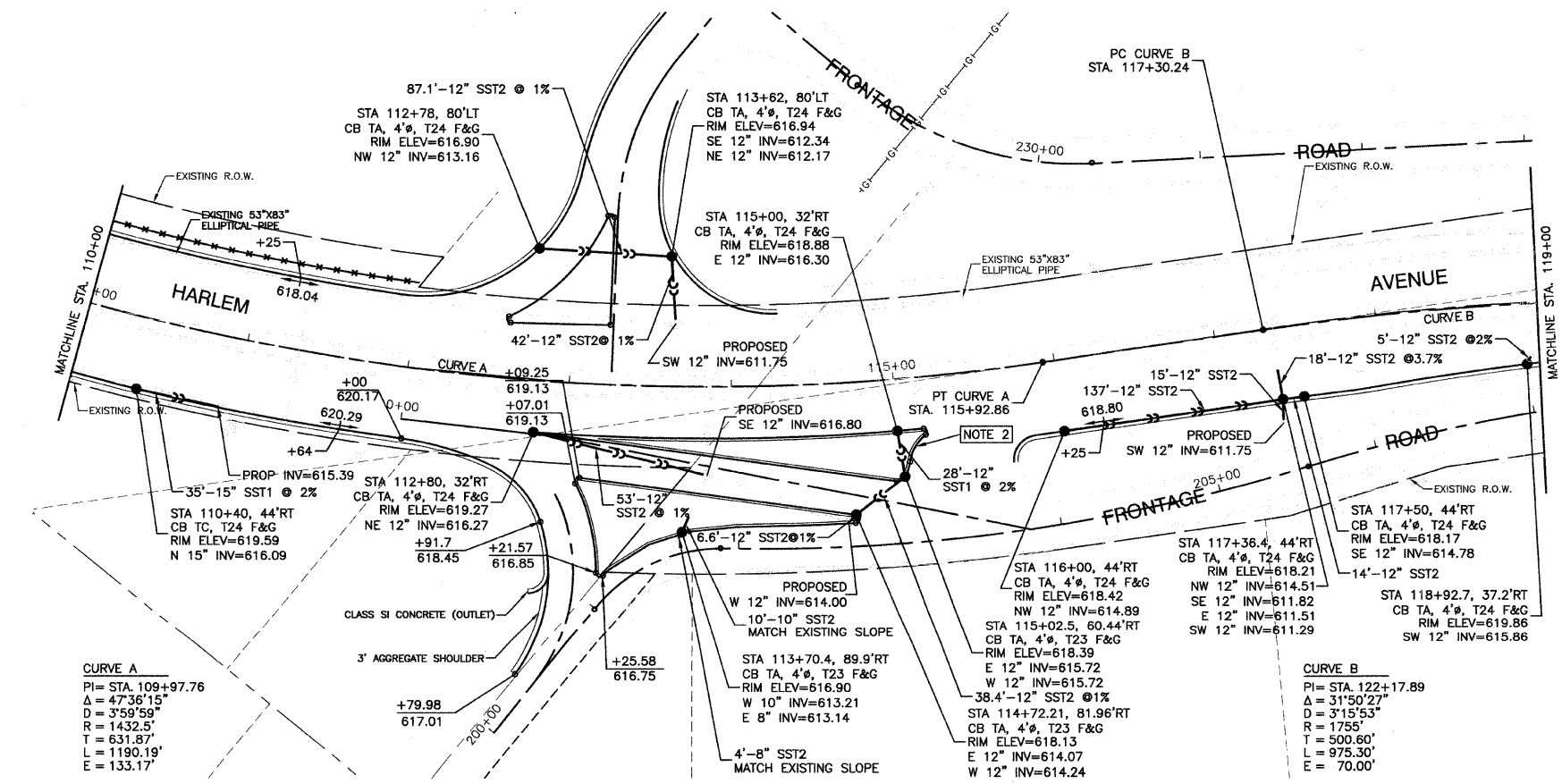

PROPOSED IMPROVEMENT

- NOTES:**
- CONNECTION TO THE EXISTING STORM SEWER SHALL BE MADE WITH A 12" STORM SEWER. THE COST OF THE CONNECTION WILL BE INCIDENTAL TO STORM SEWER, CLASS A, 12".
  - 10' TRANSITION SHALL BE USED TO GO FROM B-6.24 TO B-6.12 CURB AND GUTTER. THE TRANSITION SHALL BE PAID AS THE CONTRACT UNIT PRICE FOR COMBINATION CONCRETE CURB AND GUTTER, TYPE B-6.24

**LEGEND**

- EXISTING CATCH BASIN
- ⊙ EXISTING MANHOLE
- PROPOSED CATCH BASIN
- ⊙ PROPOSED MANHOLE
- EXISTING STORM SEWER
- PROPOSED STORM SEWER
- STORM SEWER REMOVAL
- CB, MH OR WV TO BE ADJUSTED
- ADJ W/T1 OL CB TO BE ADJUSTED WITH A NEW TYPE 1 FRAME, O.L.
- ADJ W/T1 CL CB TO BE ADJUSTED WITH A NEW TYPE 1 FRAME, C.L.
- ADJ W/23 CB TO BE ADJUSTED WITH A NEW TYPE 23 F&G
- FIRE R&R FIRE HYDRANT TO BE REMOVED AND RELOCATED

**BENCH MARKS:**

- X CUT ON TOP OF 8TH BOLT UP ON THE SE LEG OF COMED TOWER NORTH OF 71ST STREET 4TH TOWER WEST OF HARLEM AVENUE ELEVATION = 617.036
- X CUT ON TOP OF 7TH BOLT UP ON THE SW LEG OF COMED TOWER NORTH OF 71ST STREET 3RD TOWER WEST OF HARLEM AVENUE ELEVATION = 617.377
- X CUT ON TOP OF 8TH BOLT UP ON THE SE LEG OF COMED TOWER NORTH OF 71ST STREET 2ND TOWER WEST OF HARLEM AVENUE ELEVATION = 617.768

**ILLINOIS DEPARTMENT OF TRANSPORTATION**

FAP 348 (HARLEM AVENUE)  
DRIVEWAY RECONFIGURATION  
DRAINAGE & UTILITIES  
STA 110+00 TO STA 119+00

REVISIONS	
NAME	DATE
NICOR REV	8-28-09

SCALE: VERT. NA  
HORIZ. 1"=50'  
DATE 08-14-09  
DRAWN BY PS  
CHECKED BY RJW