

PREPARED BY OR UNDER THE  
DIRECT SUPERVISION OF:

*[Signature]*  
8/23/09



I certify that to the best of my knowledge, information, and belief, this lighting design is visually adequate for the roadway classification and geometry shown on the plans. The design is an economical one and complies with requirements of Chapter 56 of the BDE Manual.

F. A. P. NO.	SECTION	COUNTY	TOTAL SHEETS	SHEET NO.
348	09-00059-00-CH	COOK	046	016
STA.	TO STA.			
FED. ROAD DIST. NO.	ILLINOIS	FED. AID PROJECT	ARA-9003(340)	

CONTRACT #63269

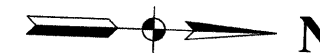

**NOTES:**

- ALL SPLICES SHALL BE MADE IN THE POLE HANDHOLE. NO UNDERGROUND SPLICES WILL BE ALLOWED.
- COMPLETE LIGHTING UNIT TO BE RELOCATED INCLUDING LUMINAIRE, POLE, ARM, POLE WIRE, FUSES, CONNECTIONS, HARDWARE AND ALL APPURTANCES.
- CONTRACTOR SHALL COORDINATE WITH IDOT ELECTRICAL MAINTENANCE DEPARTMENT BEFORE AND DURING CONSTRUCTION.
- CONTRACTOR SHALL PROVIDE RECORD DRAWINGS TO IDOT AFTER CONSTRUCTION.
- LIGHTING CONTRACTOR SHALL COORDINATE STAGING WITH GENERAL CONTRACTOR SO THAT THE SIDE OF THE ROADWAY OPEN TO TRAFFIC REMAINS FULLY LIT AT ALL TIMES DURING CONSTRUCTION.
- EQUIPMENT GROUND SHALL BE CONTINUOUS FROM THE LIGHTING CONTROLLER TO THE LAST POLE OF EACH CIRCUIT, AND SHALL HAVE RESISTANCE CONFORMING TO IDOT SPECIFICATIONS.
- BEFORE BEGINNING WORK, LIGHTING CONTRACTOR AND ENGINEER SHALL INSPECT EXISTING POLES, MAST ARMS, AND LUMINAIRES FOR DAMAGE. EQUIPMENT THAT IS DETERMINED UNSUITABLE FOR RELOCATION SHALL BE REMOVED AND REPLACED, AND PAID FOR AT THE CONTRACT UNIT PRICE FOR EACH ITEM.
- EQUIPMENT THAT IS DAMAGED BY THE CONTRACTOR SHALL BE REPLACED AT THE CONTRACTOR'S EXPENSE.

**LEGEND:**

- EXISTING STREET LIGHTING UNIT, 400W HPS, 240V
- RELOCATED STREET LIGHTING UNIT, 400W HPS, 240V
- CONDUIT, PUSHED, GALVANIZED STEEL
- NEW UNIT DUCT, 3-1/2" C, NO.4 AWG AND NO.6 GROUND, (EPR TYPE RHW) 600V IN 1-1/4" POLYETHYLENE
- EXISTING UNIT DUCT, 3-1/2" C, NO.4, 600V, TYPE XHHW IN 1-1/4" DUCT W/ EXTERNAL BARE NO.6 GROUND (LOCATION APPROXIMATE PER RECORD DRAWINGS)
- GR GROUND ROD, 5/8" x 10'
- (R) REMOVAL OF EXISTING STREET LIGHT
- (RL) RELOCATE EXISTING LIGHTING UNIT
- LT LEFT
- RT RIGHT
- MH MOUNTING HEIGHT
- MA MAST ARM
- B/C BACK OF CURB
- BDTB BREAKAWAY DEVICE, TRANSFORMER BASE, 15" BOLT CIRCLE

**IDOT POLE IDENTIFICATION**

- CB CABINET NUMBER
- CI CIRCUIT
- PP POLE POSITION

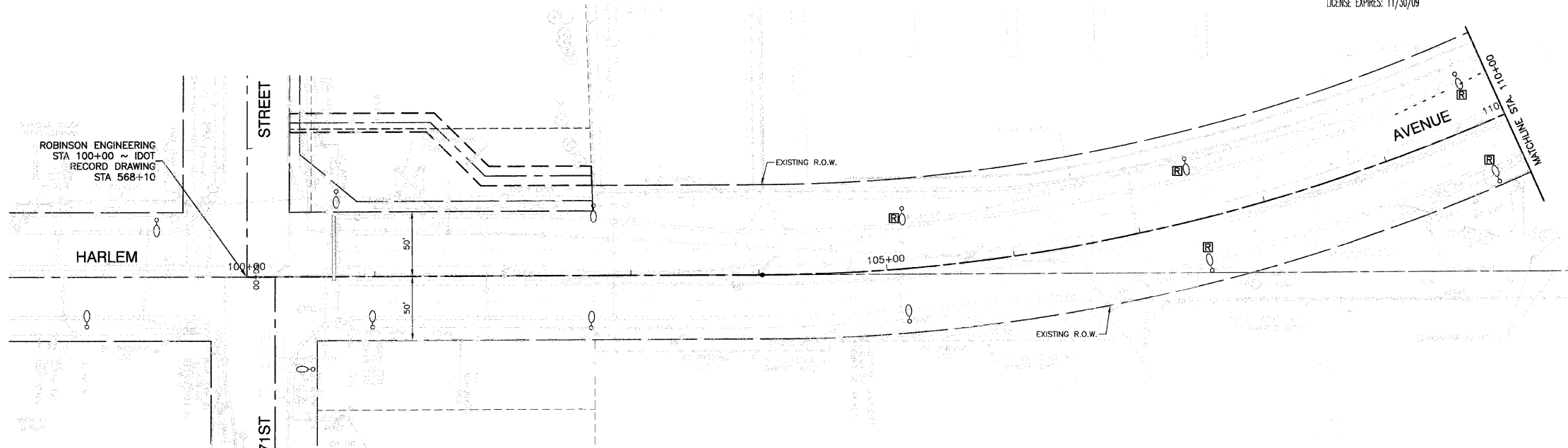

**EXISTING CONDITIONS**

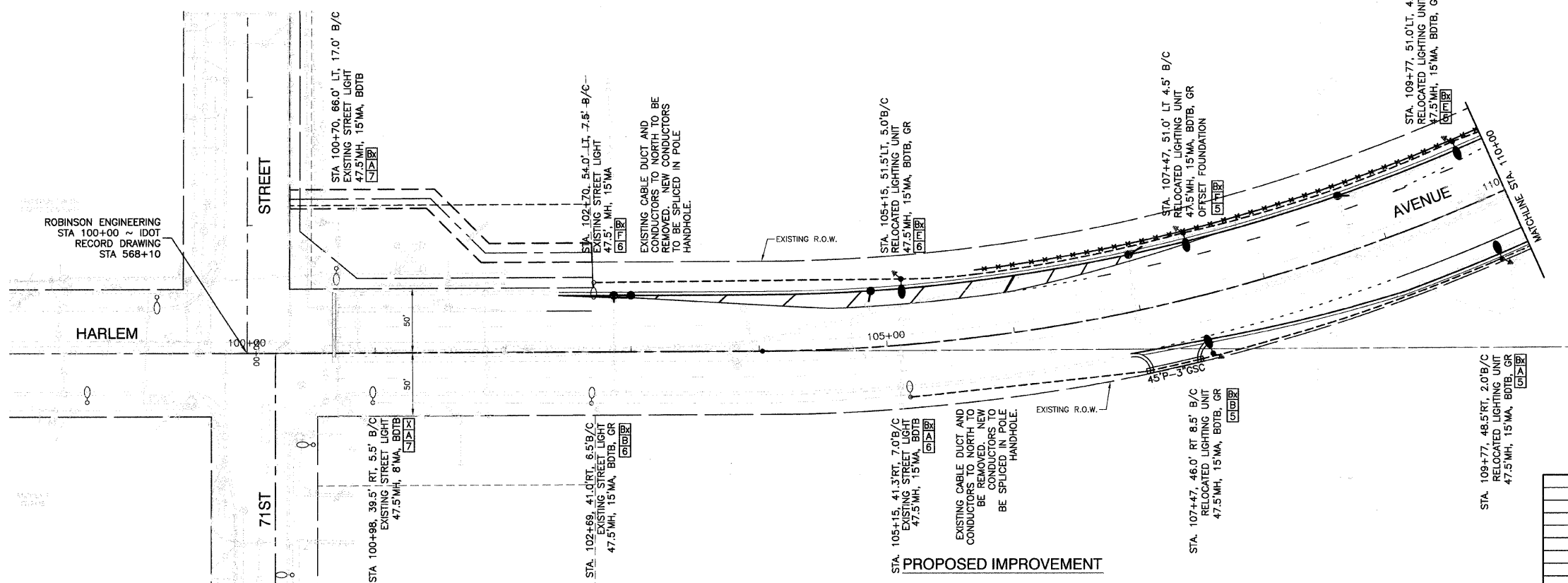

**PROPOSED IMPROVEMENT**

REVISIONS	
NAME	DATE

**ILLINOIS DEPARTMENT OF TRANSPORTATION**

**FAP 348 (HARLEM AVENUE)  
DRIVEWAY RECONFIGURATION  
STREET LIGHTING  
71ST STREET TO STA 110+00**

SCALE: VERT. NA  
HORIZ. 1"=50'

DATE: 08-14-09

DRAWN BY: PS  
CHECKED BY: RJW / PAP