

SECTION 24, TOWNSHIP 38, RANGE 12
SECTION 19, TOWNSHIP 38, RANGE 13

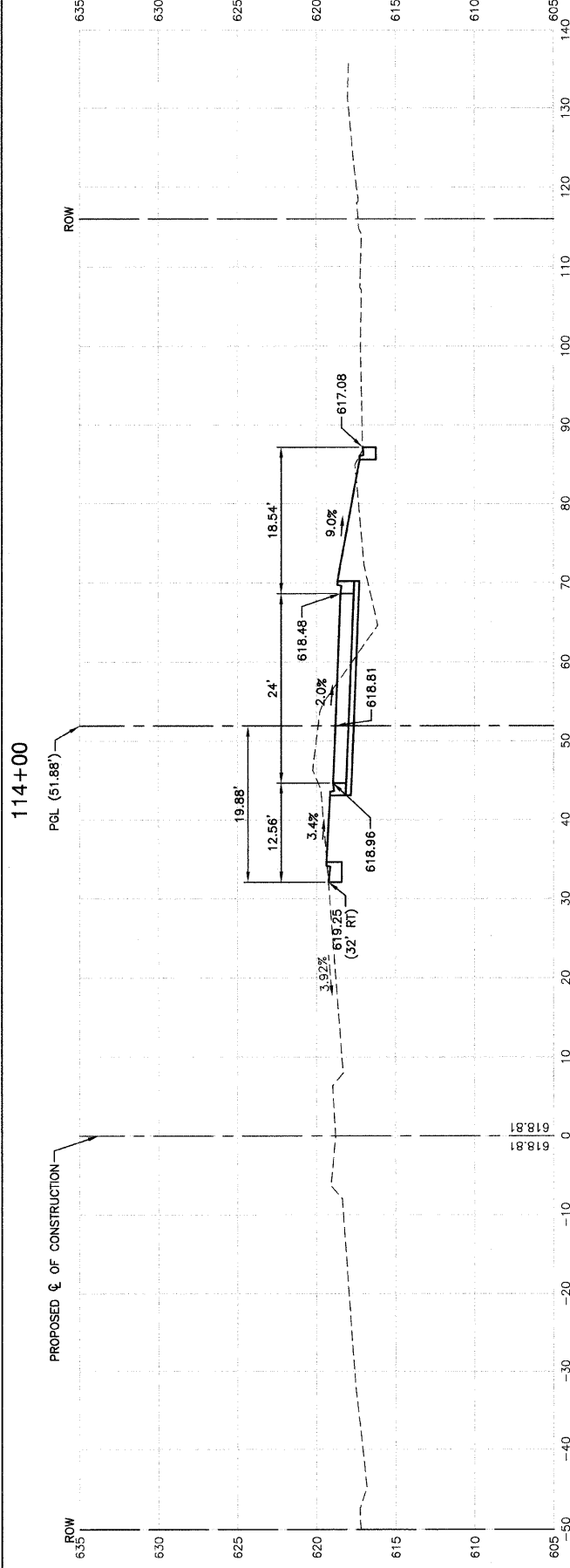

FILL: 19.17

CUT: 38.61

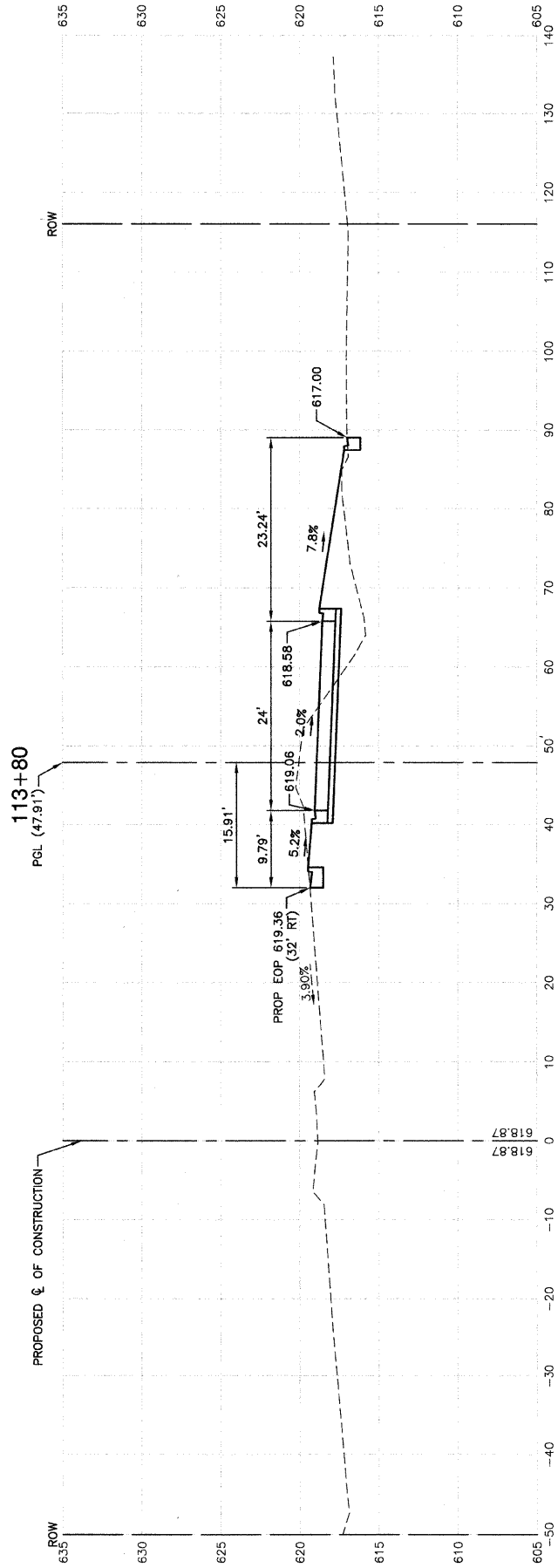

CUT: 37.53

FILL: 30.51

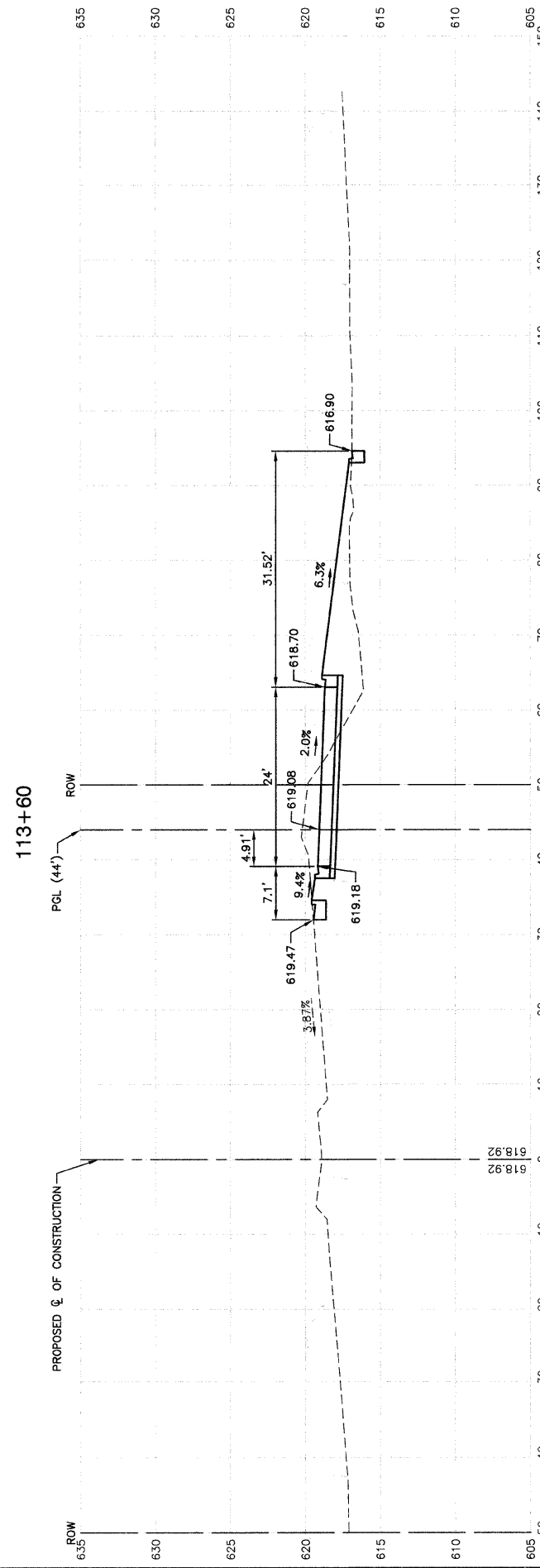

CUT: 36.72

FILL: 39.96

P. A. P. NO.	SECTION	COUNTY	TOTAL SHEETS	SHEET NO.
348	09-00059-00-CH	COOK	046	042
STA.		TO STA.		
FED. ROAD DIST. NO.		ILLINOIS	FED. AID PROJECT ARA-9003(340)	

CONTRACT #63269

REVISIONS	
NAME	DATE

ILLINOIS DEPARTMENT OF TRANSPORTATION

**FAP 348 (HARLEM AVENUE)
DRIVEWAY RECONFIGURATION
CROSS SECTIONS
STA. 113+60 TO STA. 114+00**

SCALE: VERT. 1"=5'
HORIZ. 1"=10'

DATE: 08-14-09

DRAWN BY: PS
CHECKED BY: RJW