

NOTE:
THE TRAFFIC SIGNAL CONTROL EQUIPMENT FOR THIS PROJECT SHALL BE "ECONOLITE" TO MATCH THE EXISTING ADJACENT SYSTEM.

RESTORATION OF WORK AREA. RESTORATION OF THE TRAFFIC SIGNAL WORK AREA SHALL BE INCIDENTAL TO THE RELATED PAY ITEM SUCH AS FOUNDATION, CONDUIT, HANDHOLE, TRENCH AND BACKFILL, ETC., AND NO EXTRA COMPENSATION SHALL BE ALLOWED. ALL ROADWAY SURFACES SUCH AS SHOULDERS, MEDIANS, SIDEWALKS, PAVEMENT, ETC. SHALL BE REPLACED IN KIND. ALL DAMAGE TO MOWED LAWNS SHALL BE REPLACED WITH AN APPROVED SOD, AND ALL DAMAGE TO UNMOWED FIELDS SHALL BE SEEDED IN ACCORDANCE WITH STANDARD SPECIFICATIONS 252 AND 250 RESPECTIVELY.

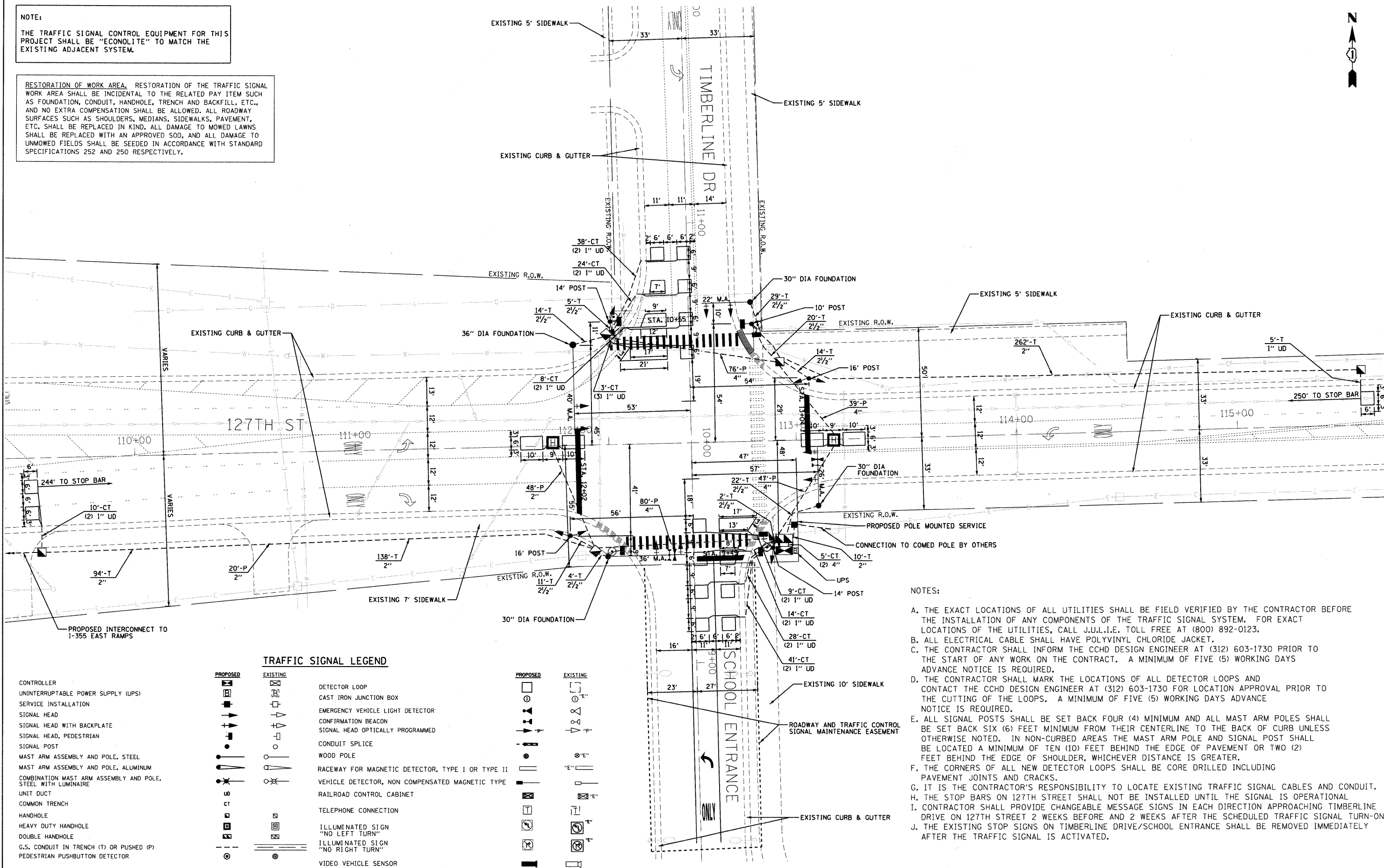

- NOTES:**
- A. THE EXACT LOCATIONS OF ALL UTILITIES SHALL BE FIELD VERIFIED BY THE CONTRACTOR BEFORE THE INSTALLATION OF ANY COMPONENTS OF THE TRAFFIC SIGNAL SYSTEM. FOR EXACT LOCATIONS OF THE UTILITIES, CALL J.U.L.I.E. TOLL FREE AT (800) 892-0123.
 - B. ALL ELECTRICAL CABLE SHALL HAVE POLYVINYL CHLORIDE JACKET.
 - C. THE CONTRACTOR SHALL INFORM THE CCHD DESIGN ENGINEER AT (312) 603-1730 PRIOR TO THE START OF ANY WORK ON THE CONTRACT. A MINIMUM OF FIVE (5) WORKING DAYS ADVANCE NOTICE IS REQUIRED.
 - D. THE CONTRACTOR SHALL MARK THE LOCATIONS OF ALL DETECTOR LOOPS AND CONTACT THE CCHD DESIGN ENGINEER AT (312) 603-1730 FOR LOCATION APPROVAL PRIOR TO THE CUTTING OF THE LOOPS. A MINIMUM OF FIVE (5) WORKING DAYS ADVANCE NOTICE IS REQUIRED.
 - E. ALL SIGNAL POSTS SHALL BE SET BACK FOUR (4) MINIMUM AND ALL MAST ARM POLES SHALL BE SET BACK SIX (6) FEET MINIMUM FROM THEIR CENTERLINE TO THE BACK OF CURB UNLESS OTHERWISE NOTED. IN NON-CURBED AREAS THE MAST ARM POLE AND SIGNAL POST SHALL BE LOCATED A MINIMUM OF TEN (10) FEET BEHIND THE EDGE OF PAVEMENT OR TWO (2) FEET BEHIND THE EDGE OF SHOULDER, WHICHEVER DISTANCE IS GREATER.
 - F. THE CORNERS OF ALL NEW DETECTOR LOOPS SHALL BE CORE DRILLED INCLUDING PAVEMENT JOINTS AND CRACKS.
 - G. IT IS THE CONTRACTOR'S RESPONSIBILITY TO LOCATE EXISTING TRAFFIC SIGNAL CABLES AND CONDUIT.
 - H. THE STOP BARS ON 127TH STREET SHALL NOT BE INSTALLED UNTIL THE SIGNAL IS OPERATIONAL.
 - I. CONTRACTOR SHALL PROVIDE CHANGEABLE MESSAGE SIGNS IN EACH DIRECTION APPROACHING TIMBERLINE DRIVE ON 127TH STREET 2 WEEKS BEFORE AND 2 WEEKS AFTER THE SCHEDULED TRAFFIC SIGNAL TURN-ON.
 - J. THE EXISTING STOP SIGNS ON TIMBERLINE DRIVE/SCHOOL ENTRANCE SHALL BE REMOVED IMMEDIATELY AFTER THE TRAFFIC SIGNAL IS ACTIVATED.

TRAFFIC SIGNAL LEGEND

PROPOSED	EXISTING	PROPOSED	EXISTING
CONTROLLER	DETECTOR LOOP	CAST IRON JUNCTION BOX	EMERGENCY VEHICLE LIGHT DETECTOR
UNINTERRUPTABLE POWER SUPPLY (UPS)	CAST IRON JUNCTION BOX	EMERGENCY VEHICLE LIGHT DETECTOR	CONFIRMATION BEACON
SERVICE INSTALLATION	EMERGENCY VEHICLE LIGHT DETECTOR	CONFIRMATION BEACON	SIGNAL HEAD OPTICALLY PROGRAMMED
SIGNAL HEAD	CONFIRMATION BEACON	SIGNAL HEAD OPTICALLY PROGRAMMED	CONDUIT SPLICE
SIGNAL HEAD WITH BACKPLATE	SIGNAL HEAD OPTICALLY PROGRAMMED	CONDUIT SPLICE	WOOD POLE
SIGNAL HEAD, PEDESTRIAN	CONDUIT SPLICE	WOOD POLE	RACEWAY FOR MAGNETIC DETECTOR, TYPE I OR TYPE II
SIGNAL POST	WOOD POLE	RACEWAY FOR MAGNETIC DETECTOR, TYPE I OR TYPE II	VEHICLE DETECTOR, NON COMPENSATED MAGNETIC TYPE
MAST ARM ASSEMBLY AND POLE, STEEL	RACEWAY FOR MAGNETIC DETECTOR, TYPE I OR TYPE II	VEHICLE DETECTOR, NON COMPENSATED MAGNETIC TYPE	RAILROAD CONTROL CABINET
MAST ARM ASSEMBLY AND POLE, ALUMINUM	VEHICLE DETECTOR, NON COMPENSATED MAGNETIC TYPE	RAILROAD CONTROL CABINET	TELEPHONE CONNECTION
COMBINATION MAST ARM ASSEMBLY AND POLE, STEEL WITH LUMINAIRE	RAILROAD CONTROL CABINET	TELEPHONE CONNECTION	ILLUMINATED SIGN "NO LEFT TURN"
UNIT DUCT	ILLUMINATED SIGN "NO LEFT TURN"	ILLUMINATED SIGN "NO RIGHT TURN"	VIDEO VEHICLE SENSOR
COMMON TRENCH	ILLUMINATED SIGN "NO RIGHT TURN"	VIDEO VEHICLE SENSOR	
HANDHOLE	VIDEO VEHICLE SENSOR		
HEAVY DUTY HANDHOLE			
DOUBLE HANDHOLE			
G.S. CONDUIT IN TRENCH (T) OR PUSHED (P)			
PEDESTRIAN PUSHBUTTON DETECTOR			



PROJECT: **OLD QUARRY SCHOOL LEMONT, ILLINOIS**

DESIGNED - GJG	REV DATE 9/8/2009	CHECKED DMS	REVISION REV PER COOK COUNTY 8/24/09 COMMENTS
DRAWN - GJG			
CHECKED - DMS			
DATE - 8/13/2009			

TRAFFIC SIGNAL INSTALLATION PLAN 127TH STREET AT TIMBERLINE DRIVE

SCALE: 1" = 20' FILE NAME: \\signal\03-signal.dgn

F.A.U. RTE. 1591	SECTION 09-00046-00-TL	COUNTY COOK	TOTAL SHEETS 17	SHEET NO. 3
FED. ROAD DIST. NO. ILLINOIS FED. AID PROJECT ARA-90031371		CONTRACT NO. 63273		