

**EROSION CONTROL GENERAL NOTES**

1. SOIL DISTURBANCE SHALL BE CONDUCTED IN SUCH A MANNER AS TO MINIMIZE EROSION. AREAS OF THE DEVELOPMENT SITE THAT ARE NOT TO BE GRADED SHALL BE PROTECTED FROM CONSTRUCTION TRAFFIC OR OTHER DISTURBANCE UNTIL FINAL SEEDING IS PERFORMED.
2. PROPERTIES AND CHANNELS ADJOINING THE DEVELOPMENT SITE SHALL BE PROTECTED FROM EROSION AND SEDIMENTATION.
3. SOIL EROSION AND SEDIMENT CONTROL FEATURES SHALL BE CONSTRUCTED PRIOR TO THE COMMENCEMENT OF HYDROLOGIC DISTURBANCE OF UPLAND AREAS.
4. DISTURBED AREAS SHALL BE STABILIZED WITH TEMPORARY OR PERMANENT MEASURES WITHIN SEVEN (7) CALENDAR DAYS FOLLOWING THE END OF ACTIVE HYDROLOGIC DISTURBANCE.
5. ALL STORM SEWERS THAT ARE OR WILL BE FUNCTIONING DURING CONSTRUCTION SHALL BE PROTECTED BY AN APPROPRIATE SEDIMENT CONTROL MEASURE.

**EROSION CONTROL GENERAL NOTES (CONT.)**

6. IF DEWATERING SERVICES ARE USED, ADJOINING PROPERTIES AND DISCHARGE LOCATIONS SHALL BE PROTECTED FROM EROSION. DISCHARGES SHALL BE ROUTED THROUGH AN EFFECTIVE SEDIMENT CONTROL MEASURE (E.G. SEDIMENT TRAP, SEDIMENT BASIN, OR OTHER APPROPRIATE MEASURE).
7. ALL TEMPORARY SOIL EROSION AND SEDIMENT CONTROL MEASURES SHALL BE REMOVED WITHIN THIRTY (30) DAYS AFTER FINAL SITE STABILIZATION IS ACHIEVED OR AFTER THE TEMPORARY MEASURES ARE NO LONGER NEEDED. TRAPPED SEDIMENT AND OTHER DISTURBED SOIL AREAS SHALL BE PERMANENTLY STABILIZED.
8. A STABILIZED MAT OF AGGREGATE UNDERLAIN WITH FILTER CLOTH (OR OTHER APPROPRIATE MEASURES) SHALL BE LOCATED AT ANY POINT WHERE TRAFFIC WILL BE ENTERING OR LEAVING A CONSTRUCTION-SITE OF A MAJOR DEVELOPMENT TO OR FROM A PUBLIC RIGHT-OF-WAY, STREET, ALLEY OR PARKING AREA. ANY SEDIMENT OR SOIL REACHING AN IMPROVED PUBLIC RIGHT-OF-WAY, STREET, ALLEY OR PARKING AREA SHALL BE REMOVED BY SCRAPING OR STREET CLEANING AS ACCUMULATIONS WARRANT AND TRANSPORTED TO A CONTROLLED SEDIMENT DISPOSAL AREA.

**EROSION CONTROL GENERAL NOTES (CONT.)**

9. THE CONTRACTOR SHALL PROVIDE ADEQUATE RECEPTACLES FOR THE DEPOSITION OF ALL CONSTRUCTION MATERIAL DEBRIS GENERATED DURING THE DEVELOPMENT PROCESS. THE CONTRACTOR SHALL NOT CAUSE OR PERMIT DUMPING, DEPOSITING, DROPPING, THROWING, DISCARDING OR LEAVING OF CONSTRUCTION MATERIAL DEBRIS UPON OR INTO AND DEVELOPMENT SITE, CHANNEL, WATERS OF THE UNITED STATES OR ISOLATED WATERS OF COOK COUNTY. THE CONTRACTOR SHALL MAINTAIN THE DEVELOPMENT SITE FREE OF CONSTRUCTION MATERIAL DEBRIS.
10. ALL TEMPORARY AND PERMANENT EROSION AND SEDIMENT CONTROL MEASURES SHALL BE MAINTAINED IN AN EFFECTIVE WORKING CONDITION.
11. TEMPORARY EROSION CONTROL SEEDING APPLIED AT THE RATE OF 100 POUNDS PER ACRE AS STATED IN ARTICLE 280.04 OF THE STANDARD SPECIFICATIONS.
12. PERMANENT EROSION CONTROL SHALL INCLUDE FURNISHING AND PLACING TOPSOIL, 4" AND SODDING, SALT TOLERANT (SPECIAL) TO BE PROVIDED IN ACCORDANCE WITH ARTICLE 250 OF THE STANDARD SPECIFICATIONS.
13. ALL WORK SHALL BE PERFORMED IN ACCORDANCE WITH THE STORM WATER POLLUTION PREVENTION PLAN FOR THIS PROJECT.

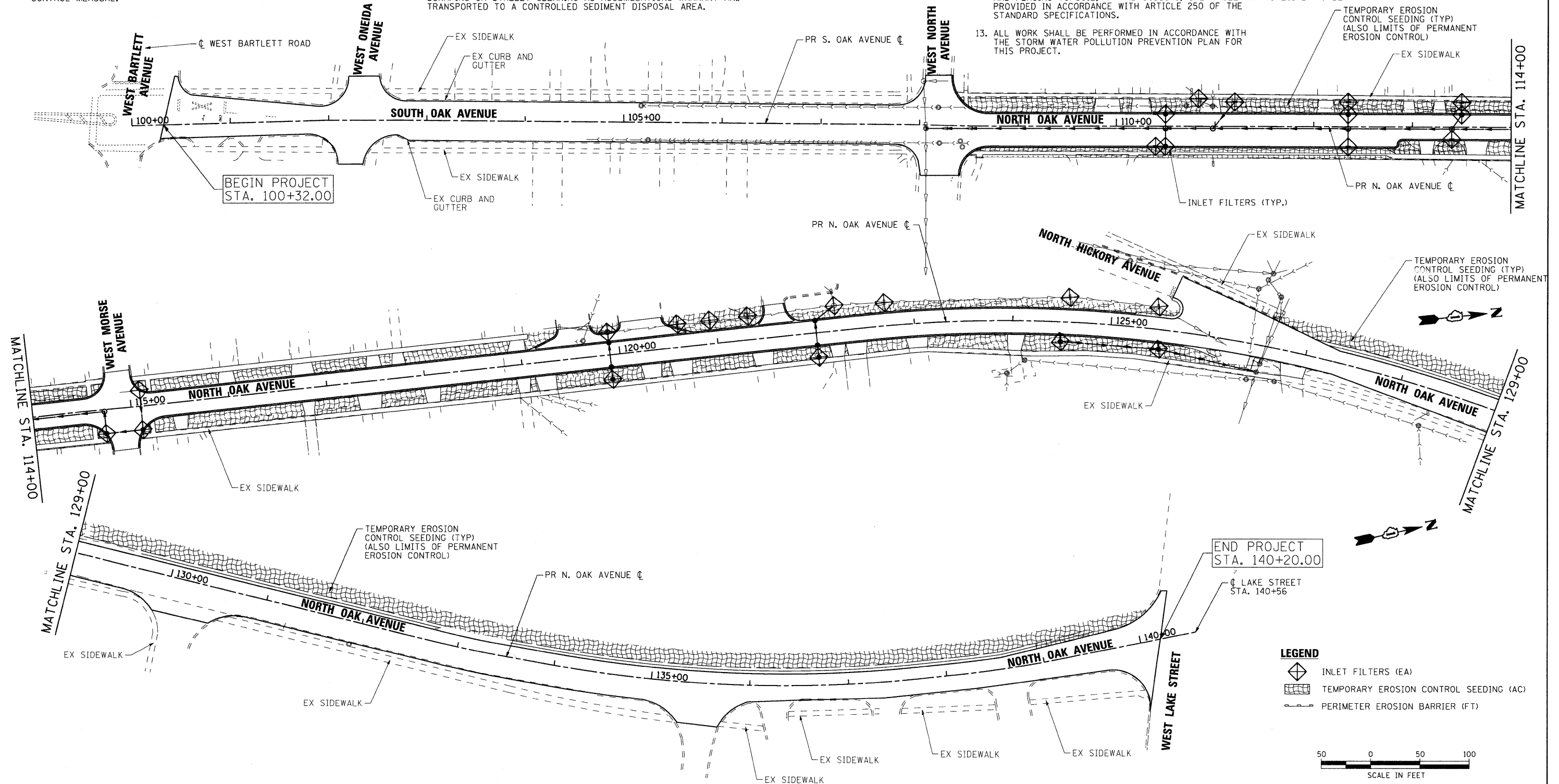

SEC GROUP, INC.  
 PROJECT CONTACT: J. MELHUISH  
 CLIENT: VILLAGE OF BARTLETT  
 DATE: 08/31/2009  
 FILE NAME: 090196-ero-01.dgn  
 PLOT DRIVER: partlet  
 PEN TABLE: standard-trans.tbl

**SEC Group, Inc.**  
 Engineering  
 Surveying  
 Planning  
 Landscape Architecture  
 McHenry • Yorkville • New Lenox • Chicago  
 www.secgroupinc.com

USER NAME = jmelhuish	DESIGNED - J. ATTANASEO	REVISED -
FILE NAME = 090196-ero-01.dgn	DRAWN - JPA	REVISED -
PLOT SCALE = 1" = 50'	CHECKED - T. HAMILTON	REVISED -
PLOT DATE = 8/31/2009	DATE = 8/31/09	REVISED -

**STATE OF ILLINOIS  
 DEPARTMENT OF TRANSPORTATION**

**EROSION CONTROL PLAN  
 NORTH OAK AVENUE**

SCALE: 1" = 50'    SHEET NO. 1 OF 1 SHEETS    STA.    TO STA.

F.A.U. RTE.	SECTION	COUNTY	TOTAL SHEETS	SHEET NO.
2537	09-00084-00-RS	COOK	53	26
CONTRACT NO.			63274	
FED. ROAD DIST. NO.    ILLINOIS FED. AID PROJECT ARA-9003 (345)				