

F.A.U. ROUTE	MUNICIPAL SECTION	COUNTY	TOTAL SHEETS	SHEET NO.
041	09-00110-00-PV	McHENRY	22	1
COVER SHEET				
F.H.W.A. REG.5 ILLINOIS PROJECT				

# STATE OF ILLINOIS DEPARTMENT OF TRANSPORTATION DIVISION OF HIGHWAYS PLANS FOR PROPOSED FEDERAL AID HIGHWAY

## F.A.U. RTE 041 RAFFEL ROAD RECONSTRUCTION

### IL RTE 120 TO BANFORD ROAD SECTION 09-00110-00-PV PROJECT NO. ARA-9003(445) JOB NO. C-91-905-09 CITY OF WOODSTOCK McHENRY COUNTY

**INDEX TO SHEETS**

SHEET NO.	DESCRIPTION
1	COVER SHEET
2	GENERAL NOTES AND LEGEND
3	SUMMARY & SCHEDULE OF QUANTITIES
4	TYPICAL SECTIONS, ALIGNMENT, TIES AND BENCHMARKS
5	DETOUR PLAN
6-9	PLAN AND PROFILE
10-20	CROSS SECTIONS
21	SPECIAL DETAILS
22	DISTRICT ONE STANDARD DETAILS

**STATE STANDARDS**

000001-05	STANDARD SYMBOLS, ABBREVIATIONS AND PATTERNS
280001-04	TEMPORARY EROSION CONTROL SYSTEMS
601101-01	CONCRETE HEADWALL FOR PIPE DRAIN
606001-04	CONCRETE CURB TYPE B AND COMBINATION CONCRETE CURB AND GUTTER
701501-05	URBAN LANE CLOSURE, 2L, 2W, UNDIVIDED
701901-01	TRAFFIC CONTROL DEVICES
780001-02	TYPICAL PAVEMENT MARKINGS

**CITY STANDARDS - INCLUDED IN PROPOSAL BOOKLET**

FRAMES AND GRATES  
 CASTING ADJUSTMENTS FOR STRUCTURES IN PAVED AREAS  
 CASTING ADJUSTMENTS FOR STRUCTURES WITHIN THE CURB LINE

**GRAPHIC SCALE**

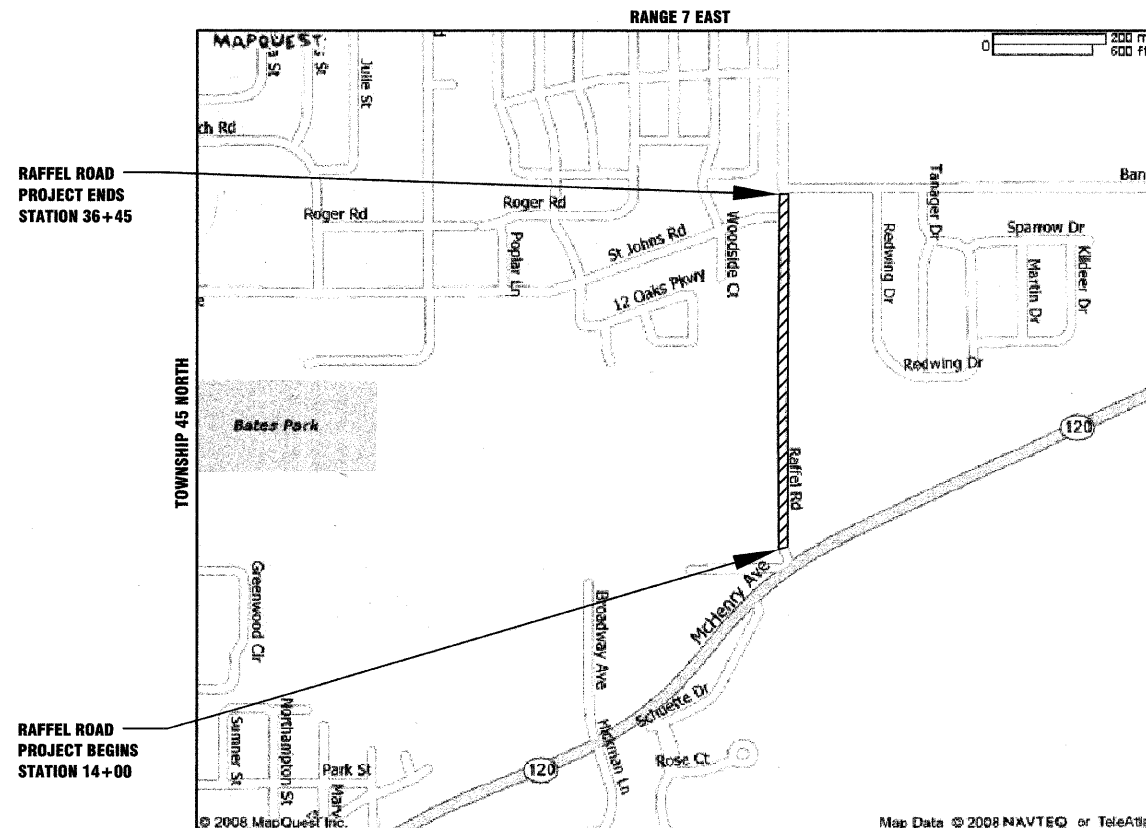
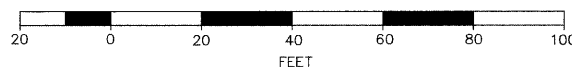

LOCATION MAP  
 APPROXIMATE SCALE = NTS  
 GROSS AND NET LENGTH OF PROJECT = 2245 LF (0.425 MILE)



LOCATION OF SECTION INDICATED THIS: — ■

STATE OF ILLINOIS  
 DEPARTMENT OF TRANSPORTATION  
 DIVISION OF HIGHWAYS

APPROVED 8-7 2009

*J. L. Hill*  
 CITY OF WOODSTOCK

PASSED AUGUST 31 2009

*C. H. Hill*  
 DISTRICT 1 ENGINEER OF LOCAL ROADS AND STREETS

RELEASING FOR BID  
 BASED ON LIMITED

REVIEW SEPTEMBER 1, 2009

*Diane M. O'Keefe*  
 DEPUTY DIRECTOR OF HIGHWAYS REGION 1 ENGINEER

WARNING



CALL BEFORE  
 YOU DIG

ADT = 3916 (2009)  
 POSTED SPEED LIMIT = 35  
 DESIGN SPEED 50  
 CONTRACT NO. 63283

**PRINTED BY THE AUTHORITY  
 OF THE STATE OF ILLINOIS**

DATE: 08/07/2009

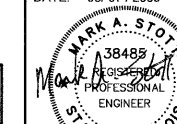

EXPIRES: 11/2009

**HAMPTON, LENZINI AND RENWICK, INC.**  
 CIVIL ENGINEERS • STRUCTURAL ENGINEERS • LAND SURVEYORS  
 380 SHEPARD DRIVE  
 ELGIN, ILLINOIS 60123  
 847.697.6700 www.hlrengineering.com

184.00085  
 ILLINOIS PROFESSIONAL DESIGN FIRM & STRUCTURAL ENGINEERING CORP.

PROJECT NUMBER: 07.0110

DATE: 08/07/2009

ASSOCIATE FIELD ENGINEER: KEVIN STALLWORTH 847-705-4169