

PLAN	SURVEYED	DATE
	PLOTTED	BY
	GRADES CHECKED	
	STRUCTURE NOTATIONS CHECKED	
	NO. _____	CADD FILE NAME

PROFILE	SURVEYED	DATE
	PLOTTED	BY
	GRADES CHECKED	
	STRUCTURE NOTATIONS CHECKED	
	NO. _____	CADD FILE NAME

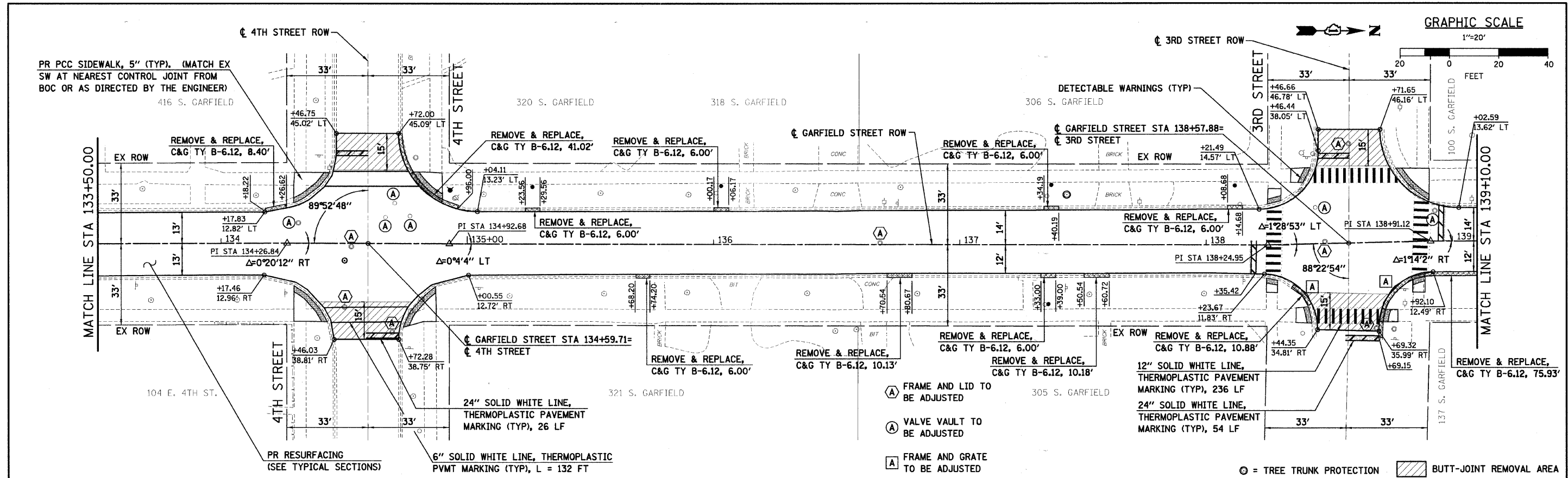

133+50	134+00	134+50	135+00	135+50	136+00	136+50	137+00	137+50	138+00	138+50	139+00
713.66 713.66	715.03 715.03	716.24 716.24	716.42 716.42	717.16 717.16	717.97 717.97	718.22 718.22	717.95 717.95	717.48 717.48	716.97 716.97	716.79 716.79	717.25 717.25

**SEC Group, Inc.**  
Engineering  
Planning  
Landmarks Architecture  
McHenry • Yorkville • New Tazewell • Chicago  
www.secgroup.com

USER NAME = ajohnson	DESIGNED -	REVISED -
PLOT SCALE = 1"=20'	DRAWN - SVJ	REVISED -
PLOT DATE = 8/13/2009	CHECKED - GT	REVISED -
	DATE - 8/13/09	REVISED -

**VILLAGE OF HINSDALE  
DUPAGE COUNTY, ILLINOIS  
GARFIELD STREET, FIRST STREET, & PARK AVENUE**

**GARFIELD STREET  
ROADWAY PLAN AND PROFILE**

SCALE: 1"=20' SHEET NO. 14 OF 65 SHEETS STA. 133+50.00 TO STA. 139+10.00

F.A.U. R.T.E. 2678	SECTION NO. 08-00086-00-RS	COUNTY DUPAGE	TOTAL SHEETS 65	SHEET NO. 14
FED. ROAD DIST. NO. ILLINOIS FED. AID PROJECT			CONTRACT NO. 63297	