

LEGEND

- WORK ZONE
- TRAFFIC DIRECTION
- BARRICADES OR DRUMS
- VERTICAL PANELS
- TYPE III BARRICADE
- TRAFFIC CONTROL SIGN
- ARROW BOARD

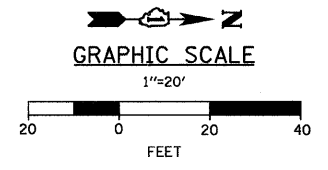
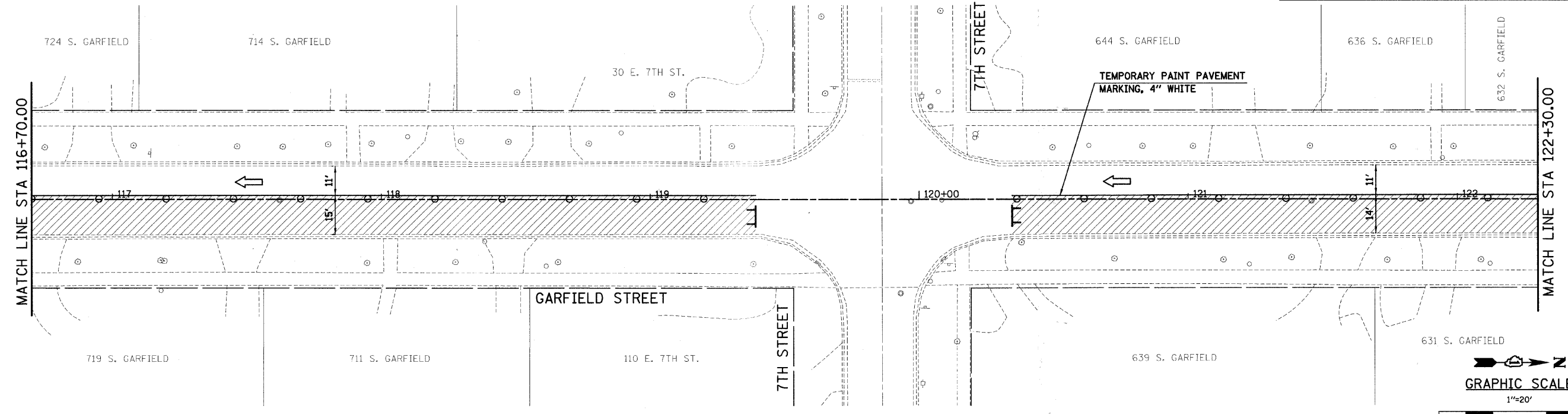

PROJECT: CONTRACT, GLENVIEW, ILL. SEC. 1111.00-1116.00 (SHEET 20 OF 65) DATE: 8/13/09

SEC Group, Inc.
Engineering
Surveying
Planning
Landscape Architecture
McHenry • Yorkville • New Lenox • Chicago
www.secgroup.com

USER NAME = s.johnson	DESIGNED -	REVISIONS
PLOT SCALE = 1"=20'	DRAWN - SVJ	REVISIONS
PLOT DATE = 8/13/2009	CHECKED - GT	REVISIONS
	DATE - 8/13/09	REVISIONS

DESIGNED -	REVISIONS
DRAWN - SVJ	REVISIONS
CHECKED - GT	REVISIONS
DATE - 8/13/09	REVISIONS

**VILLAGE OF HINSDALE
DUPAGE COUNTY, ILLINOIS
GARFIELD STREET, FIRST STREET, & PARK AVENUE**

SCALE: 1"=20'	SHEET NO. 20 OF 65 SHEETS	STA. 111+10.00 TO STA. 122+30.00
---------------	---------------------------	----------------------------------

**GARFIELD STREET
SUGGESTED MAINTENANCE OF TRAFFIC
STAGE I**

F.A.V. RTE. 2678	SECTION NO. 08-00086-00-RS	COUNTY DUPAGE	TOTAL SHEETS 65	SHEET NO. 20
FED. ROAD DIST. NO.	ILLINOIS FED. AID PROJECT			
		CONTRACT NO. 632977		