

GRAPHIC SCALE

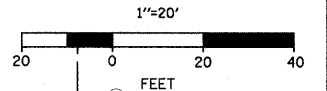

SEE SCHEDULE OF QUANTITIES FOR PATCHING WIDTH TABLE

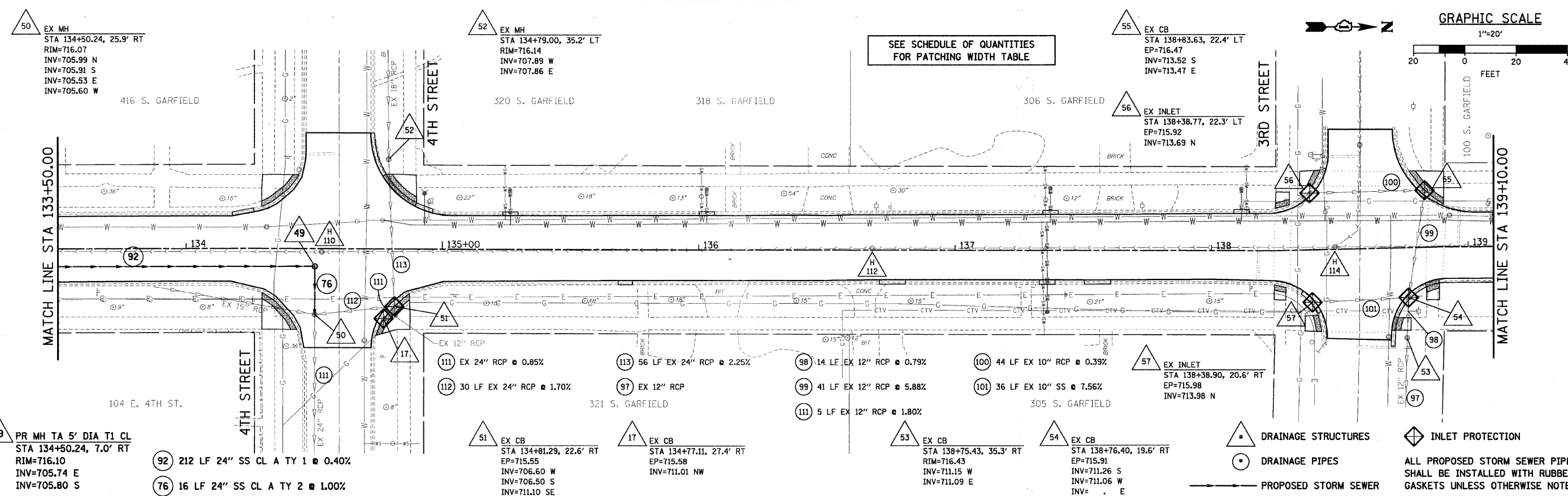

- △ DRAINAGE STRUCTURES
 - DRAINAGE PIPES
 - PROPOSED STORM SEWER
 - ◊ INLET PROTECTION
- ALL PROPOSED STORM SEWER PIPES SHALL BE INSTALLED WITH RUBBER GASKETS UNLESS OTHERWISE NOTED.

| | |
|-----------|--|
| DATE | |
| BY | |
| REVISIONS | |
| PLANNED | |
| NOTED | |
| NO. _____ | |
| FILE NAME | |

| | |
|-----------|--|
| DATE | |
| BY | |
| REVISIONS | |
| PLANNED | |
| NOTED | |
| NO. _____ | |
| FILE NAME | |

ALL TRENCHES UNDER OR WITHIN FIVE (5) FEET OF ALL CURB AND GUTTER, PAVED SURFACES, AND SIDEWALKS SHALL BE BACKFILLED WITH SELECT GRANULAR MATERIAL CONFORMING TO THE GRADATION OF CA7 AND SHALL BE INCLUDED IN THE COST OF TRENCH BACKFILL.

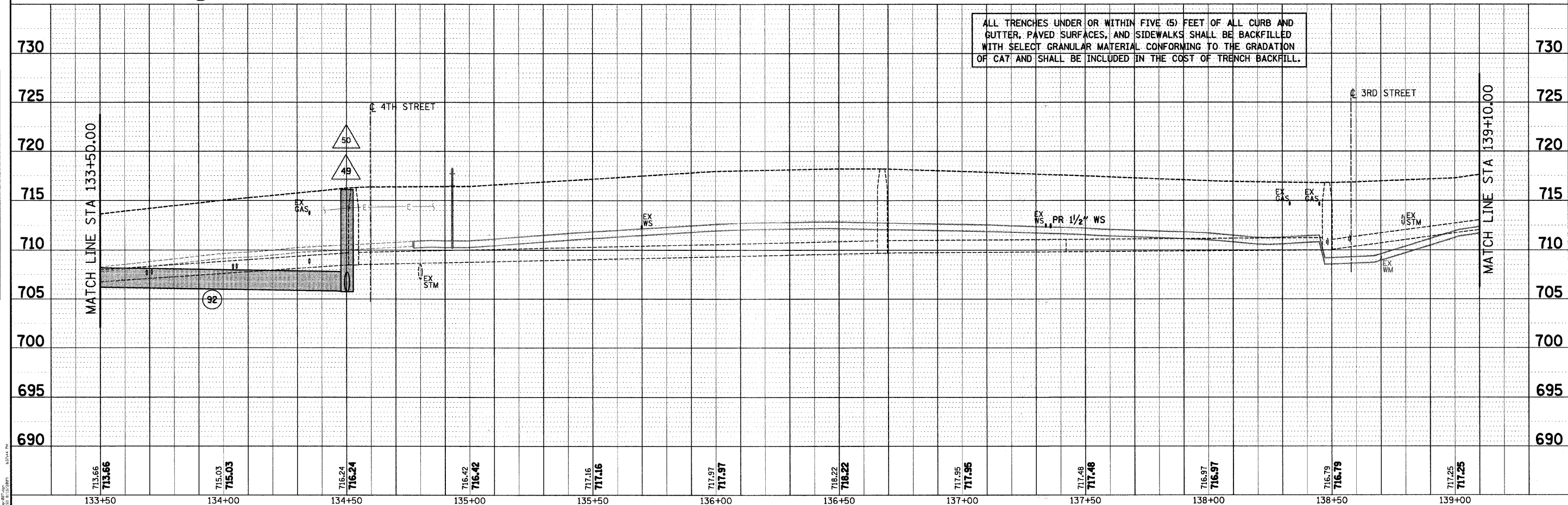

| | | | | | | | | | | | |
|------------------|------------------|------------------|------------------|------------------|------------------|------------------|------------------|------------------|------------------|------------------|------------------|
| 713.66 713.66 | 715.03 715.03 | 716.24 716.24 | 716.42 716.42 | 717.16 717.16 | 717.97 717.97 | 718.22 718.22 | 717.95 717.95 | 717.48 717.48 | 716.97 716.97 | 716.79 716.79 | 717.25 717.25 |
| 133+50 | 134+00 | 134+50 | 135+00 | 135+50 | 136+00 | 136+50 | 137+00 | 137+50 | 138+00 | 138+50 | 139+00 |

SEC Group, Inc.
 Engineering
 Planning
 Landscape Architecture
 McHenry • Yorkville • New Lenox • Chicago
 www.secgroupinc.com

| | | |
|-----------------------|----------------|-----------|
| USER NAME = s.johnson | DESIGNED - | REVISED - |
| PLOT SCALE = 1"=20' | DRAWN - SVJ | REVISED - |
| PLOT DATE = 8/13/2009 | CHECKED - GT | REVISED - |
| | DATE = 8/13/09 | REVISED - |

VILLAGE OF HINSDALE
 DUPAGE COUNTY, ILLINOIS
 GARFIELD STREET, FIRST STREET, & PARK AVENUE

GARFIELD STREET
 DRAINAGE PLAN AND PROFILE
 SCALE: 1"=20' SHEET NO. 37 OF 65 SHEETS STA. 133+50.00 TO STA. 139+10.00

| | | | | |
|---|----------------------------|--------------------|-----------------|--------------|
| F.A. U. RTE. 2678 | SECTION NO. 08-00086-00-RS | COUNTY DUPAGE | TOTAL SHEETS 65 | SHEET NO. 37 |
| FED. ROAD DIST. NO. (ILLINOIS) FED. AID PROJECT | | CONTRACT NO. 63297 | | |