

SEE SCHEDULE OF QUANTITIES FOR PATCHING WIDTH TABLE

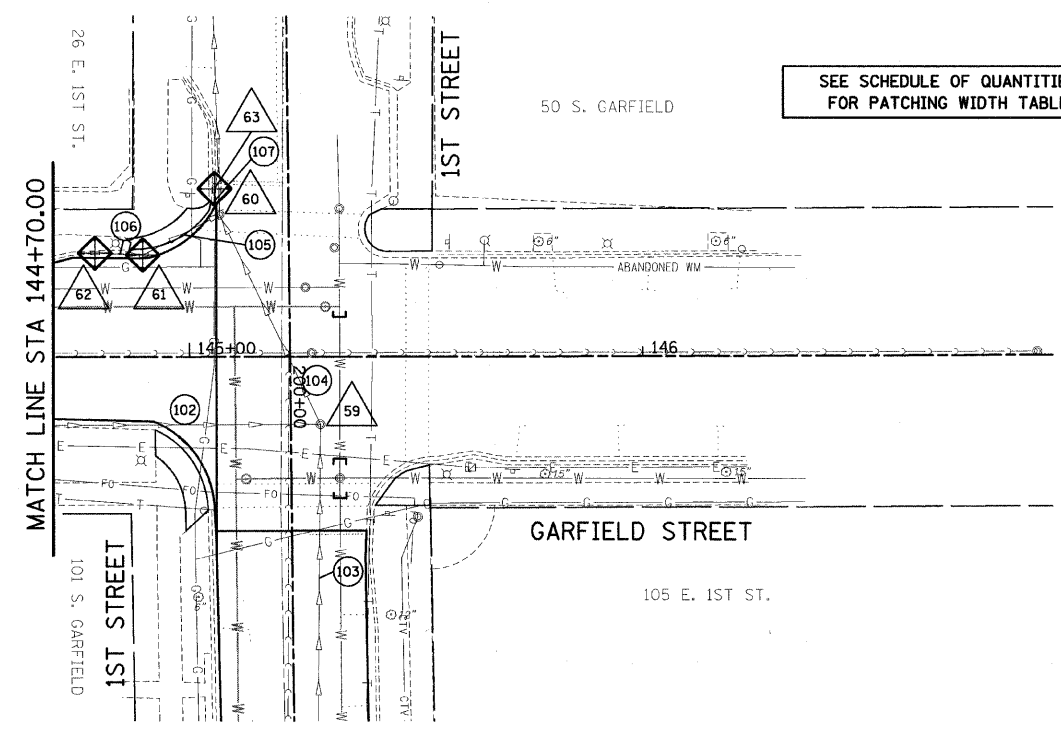

- 102 180 LF EX 12" RCP @ 4.28%
  - 103 INACCESSIBLE
  - 104 50 LF EX 15" RCP @ -0.46%
  - 105 INACCESSIBLE
  - 106 INACCESSIBLE
  - 107 4 LF EX 24" RCP @ 63.50%
- 59 EX MH  
STA 145+28.89, 14.7' RT  
RIM=702.0  
INV=697.34 SW  
INV=698.22 S  
INV= . E
  - 60 EX MH  
STA 145+06.42, 30.6' LT  
RIM=701.61  
INV=697.11 NE  
INV=697.01 W  
INV= . S
  - 61 EX INLET  
STA 144+89.81, 22.7' LT  
EP=701.62  
INV=698.39 NW  
INV=698.77 S
  - 62 EX INLET  
STA 144+79.26, 23.2' LT  
EP=701.77  
INV= . N
  - 63 EX INLET  
STA 145+05.63, 37.4' LT  
EP= . E  
INV= . E

ALL TRENCHES UNDER OR WITHIN FIVE (5) FEET OF ALL CURB AND GUTTER, PAVED SURFACES, AND SIDEWALKS SHALL BE BACKFILLED WITH SELECT GRANULAR MATERIAL CONFORMING TO THE GRADATION OF CA7 AND SHALL BE INCLUDED IN THE COST OF TRENCH BACKFILL.

- DRAINAGE STRUCTURES
  - DRAINAGE PIPES
  - INLET PROTECTION
  - PROPOSED STORM SEWER
- ALL PROPOSED STORM SEWER PIPES SHALL BE INSTALLED WITH RUBBER GASKETS UNLESS OTHERWISE NOTED.

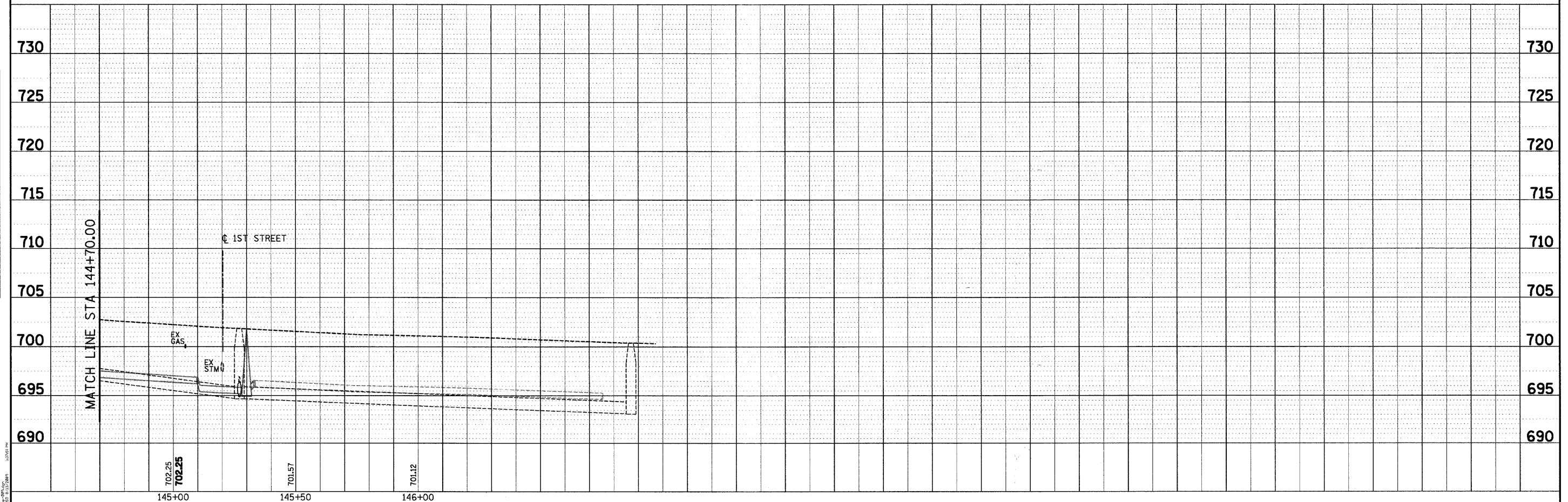

DATE	
BY	
DESIGNED	
DRAWN	
CHECKED	
PLANNED	
NOTED	
NO.	

DATE	
BY	
DESIGNED	
DRAWN	
CHECKED	
PLANNED	
NOTED	
NO.	



USER NAME = s.johnson	DESIGNED -	REVISED -
PLOT SCALE = 1"=20'	DRAWN - SVJ	REVISED -
PLOT DATE = 8/13/2009	CHECKED - GT	REVISED -
	DATE - 8/13/09	REVISED -

VILLAGE OF HINSDALE  
DUPAGE COUNTY, ILLINOIS  
GARFIELD STREET, FIRST STREET, & PARK AVENUE

SCALE: 1"=20'	SHEET NO. 39 OF 65 SHEETS	STA. 144+70.00 TO STA. 146+00.00
---------------	---------------------------	----------------------------------

F.A.V. RTE. 267B	SECTION NO. 08-00086-00-RS	COUNTY DUPAGE	TOTAL SHEETS 65	SHEET NO. 39
FED. ROAD DIST. NO. ILLINOIS		FED. AID PROJECT		